

Duly Entered for Taxation

NOV 12 1941

Chas. H. Wilson  
AUDITOR

# NORTHWOOD VILLAGE

32419

A SUBDIVISION OF PART OF THE N.E. 1/4 OF SECTION 17, T.6S., R.10W., DESCRIBED AS FOLLOWS:  
Commencing at a point in the East line of said N.E. 1/4 290 ft. south of the N.E. cor. thereof,  
thence South along said East line 638.3 ft.; thence west along the North line of Dixieland  
Addition 2023.27 ft. to the center of Stringtown Road; thence Northwestwardly along the  
center line 363.6 ft.; thence East 750.34 ft.; thence North parallel to East line of 1/4 section  
278.7 ft.; thence East 1332.52 ft. to the place of beginning.

APPROVED BY  
CITY PLAN COMMISSION  
OF EVANSVILLE, IND.  
OCT 28 1941  
PLAT RECORD NO. 1 PAGE 79  
Herman D. Dees, Notary Public  
M. D. Hartley, Surveyor

TULIP AVE.

NORTHWOOD Co.

Oliver Wilke

WILKE  
SUB.

Herman Wilke

Albert Wilke

NORTHWOOD

AVE.

OLMSTEAD

AVE.

STATE OF INDIANA  
VANDERBURGH COUNTY } SS.

Before me, Herman D. Dees Notary Public, in and for said State and County, personally appeared Ferdinand J. Birk, as a General Partner of Northwood Co., a Limited Partnership, and Ferdinand J. Birk and Dorothy Birk, his wife, as individuals, and Gleason Murphy, Jr., as a general partner of Northwood Co., a Limited Partnership, and Gleason Murphy, Jr. and Martha Murphy, his wife, as individuals, by Thomas G. Holman, their attorney in fact, and personally appeared Thomas G. Holman as a general partner of Northwood Co., a Limited Partnership, and Thomas G. Holman and Ina David Holman, his wife, as individuals, all being the owners and subdividers of the foregoing real estate and acknowledged the execution of this plat.

Ferdinand J. Birk  
General Partner of Northwood Co.  
Ferdinand J. Birk  
Ferdinand J. Birk  
Dorothy Birk  
Dorothy Birk

Gleason Murphy, Jr.  
General Partner of Northwood Co.  
Gleason Murphy, Jr.  
Gleason Murphy, Jr.  
Martha Murphy  
Martha Murphy  
By: Thomas G. Holman  
Their Attorneys in Fact

Thomas G. Holman  
General Partner of Northwood Co.  
Thomas G. Holman  
Thomas G. Holman  
Ina David Holman  
Ina David Holman

Witness My Hand and Notarial Seal this 21<sup>st</sup> day of October, 1941

Herman D. Dees Notary Public My Commission Expires July 21, 1945

N  
W-E  
3  
1" = 60'  
TEMP. 70°

The undersigned Civil Engineer and Surveyor hereby certifies that the above plat is a true and correct drawing of a survey made according to the above description.

Charles C. Key

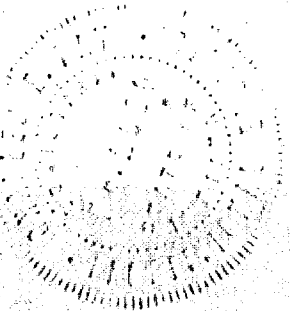

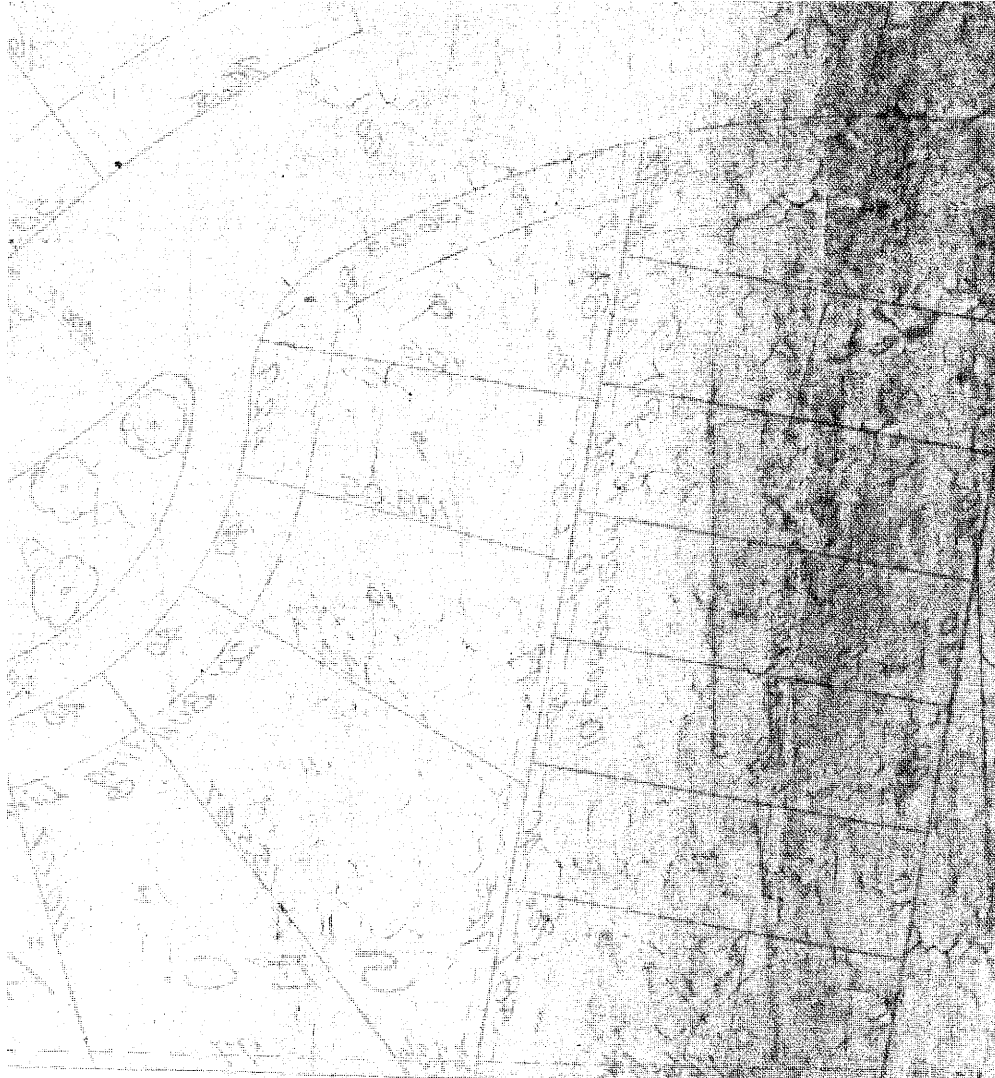

A large block of faint, mostly illegible handwritten text occupies the lower left portion of the page. The text appears to be a legal description or a set of notes related to the survey map above. Some words like "SECTION" and "ACRES" are faintly visible.

**RECEIVED FOR RECORD**

At 11:25 AM

the 1st day of April 1891

recorded in Book Record No. 14

page 250

Joseph A. Cole, Recorder  
 Vanderburgh County

H-520