

# MacLeod II

## T-158

Apr # 20-MS-2014

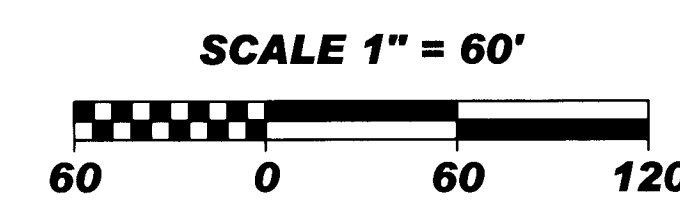
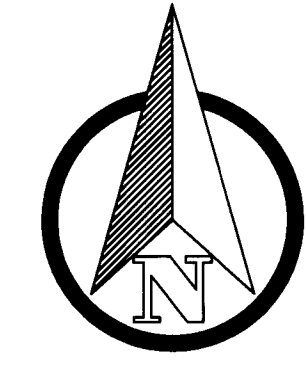

DULY ENTERED FOR TAXATION SUBJECT TO FINAL ACCEPTANCE FOR TRANSFER

DATE 11-19-14 2:14p

PLAT BOOK T

PAGE 158

INSTR# 2014R00025935

Z TULEY RECORDER  
VANDERBURGH COUNTY

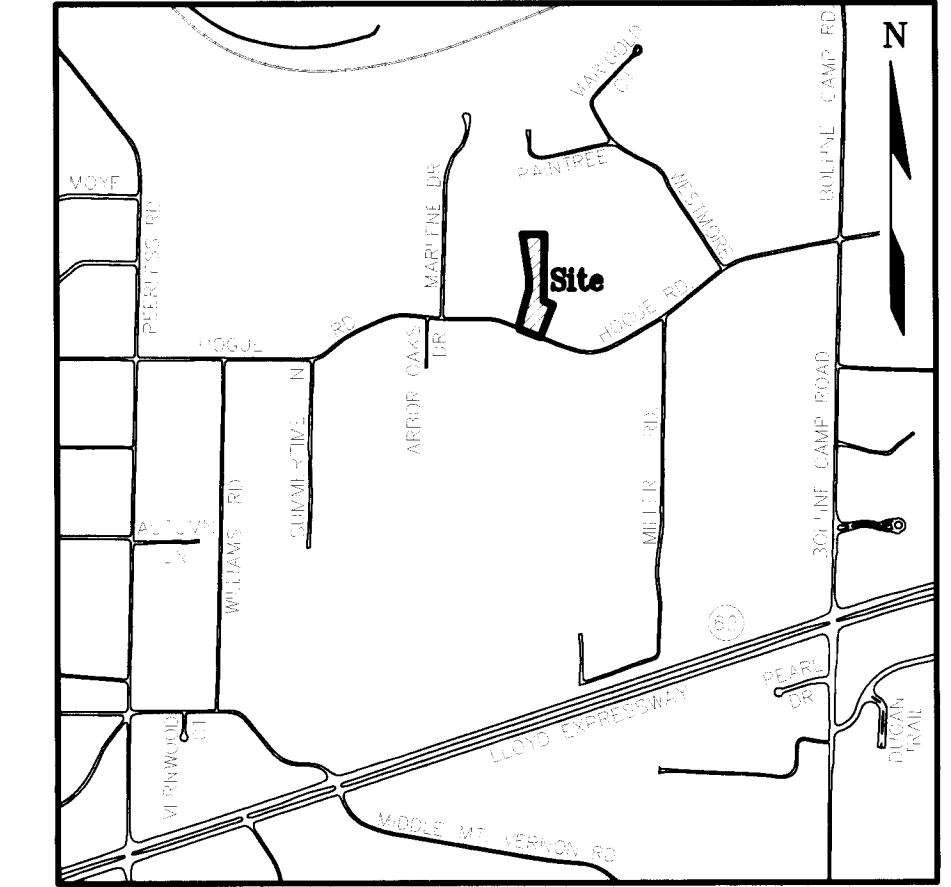

### Location Map

### Boundary Description

Lot 1 in MacLeod Minor Subdivision, as per plat thereof, recorded in Plat Book "R", page 183 as Document 2005R00036882 in the Office of the Recorder of Vanderburgh County, Indiana and also part of the Southwest Quarter of the Southwest Quarter of Section 21, Township S South, Range 11 West in Perry Township, Vanderburgh County, Indiana, being more particularly described as follows:

Commencing at the Northwest corner of said quarter, quarter section, thence along the east line of a tract of land conveyed to Howard W. and Madeline T. Brooks in Deed Drawer 13, Card 7280 in the office of the Recorder of Vanderburgh County, Indiana, South 27 degrees 27 minutes 49 seconds East 193.08 feet; thence continue along the east line of said Brooks tract, South 21 degrees 05 minutes 49 seconds East 167.00 feet to the Point of Beginning, said point being the northwest corner of said lot 1 of MacLeod Minor Subdivision; thence along the north line of said lot 1, North 90 degrees 00 minutes 00 seconds East 237.75 feet to the northeast corner of said lot 1; thence along the east line of said lot 1, South 00 degrees 00 minutes 00 seconds West 507.37 feet; thence South 72 degrees 23 minutes 55 seconds East 82.42 feet; thence South 17 degrees 36 minutes 01 seconds West 280.00 feet to a point in the center of Hogue Road; thence along the center of said road the following two (2) calls: (1) North 58 degrees 52 minutes 20 seconds West 79.54 feet; (2) thence North 69 degrees 16 minutes 28 seconds West 100.00 feet to the southwest corner of said lot 1; thence along the westerly line of said lot 1, the next six (6) calls: (1) North 05 degrees 01 minute 04 seconds West 33.30 feet; (2) thence North 14 degrees 43 minutes 55 seconds East 264.42 feet; (3) thence North 00 degrees 00 minutes 00 seconds East 92.28 feet; (4) thence North 09 degrees 11 minutes 19 seconds West 323.17 feet; (5) thence North 90 degrees 00 minutes 00 seconds West 70.91 feet; (6) thence North 09 degrees 11 minutes 19 seconds West 35.35 feet to the point of beginning, containing a gross area of 2.76 acres or 120,335 square feet.

Subject to all easements, rights of ways and restrictions of record.

**Area Plan Commission Certificate**

Under the authority provided by the Acts of 1981, Public Law #309, and enacted by the General Assembly of the State of Indiana, this plat has been given PRIMARY APPROVAL by the AREA PLAN COMMISSION of EVANSVILLE and VANDERBURGH COUNTY at a meeting held on, September 29, 2014 at Subdivision Review.

President  
[Signature]  
Attest Executive Director

Secondary Plat complies with the Ordinance and is released for Recording.  
[Signature]  
Executive Director

PLAT RELEASE DATE: Nov 19, 2014

**Surveyor's Certificate**

I, Bret Alan Sermersheim, do hereby certify that I am a land surveyor licensed in compliance with the laws of the State of Indiana, and further certify that this plat correctly represents a survey completed by me, and that all monuments shown exist at locations as noted.

Date: November 18, 2014

Bret Alan Sermersheim  
Bret Alan Sermersheim, PLS  
Registration No. LS20200009  
in the State of Indiana  
Morley & Associates, Inc.  
4800 Rosebud Lane  
Newburgh, IN 47630  
Phone: 812-464-9585  
email: brets@morleyandassociates.com

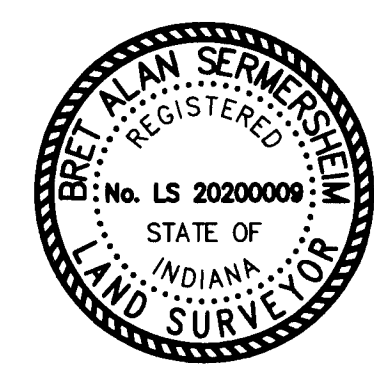

**Affirmation Statement**

I affirm, under the penalties of perjury, that I have taken reasonable care to redact each Social Security number in this document, unless required by law.

Signature: [Signature]

**Secondary Plat**

Checked By: BAS Job Number: 8659.4.001A

Drawn By: TWC Date: 11/18/2014

Filename: 8659 Secondary-plat-2014.dwg

**Morley and Associates Inc.**

Engineering  
Surveying  
Architecture  
Construction Management

4800 Rosebud Lane  
Newburgh, IN 47630  
(812) 464-9585  
www.morleyandassociates.com