

#58406 A Subdivision of a Part of the Southeast Quarter of Section 27, Twp. 6 S., R. 10 W. and described as follows: Commencing at a point on the north line of afore said S.E.  $\frac{1}{4}$  section of a distance of 705.54 west of the N.E. corner of said quarter section, running thence west 332.98 thence south 1330.70, thence east 334.03, thence north 1330.51 to the place of beginning.

STATE OF INDIANA }  
 VANDERBURGH CO. } S.S.

NE  $\frac{1}{4}$  Sec 27

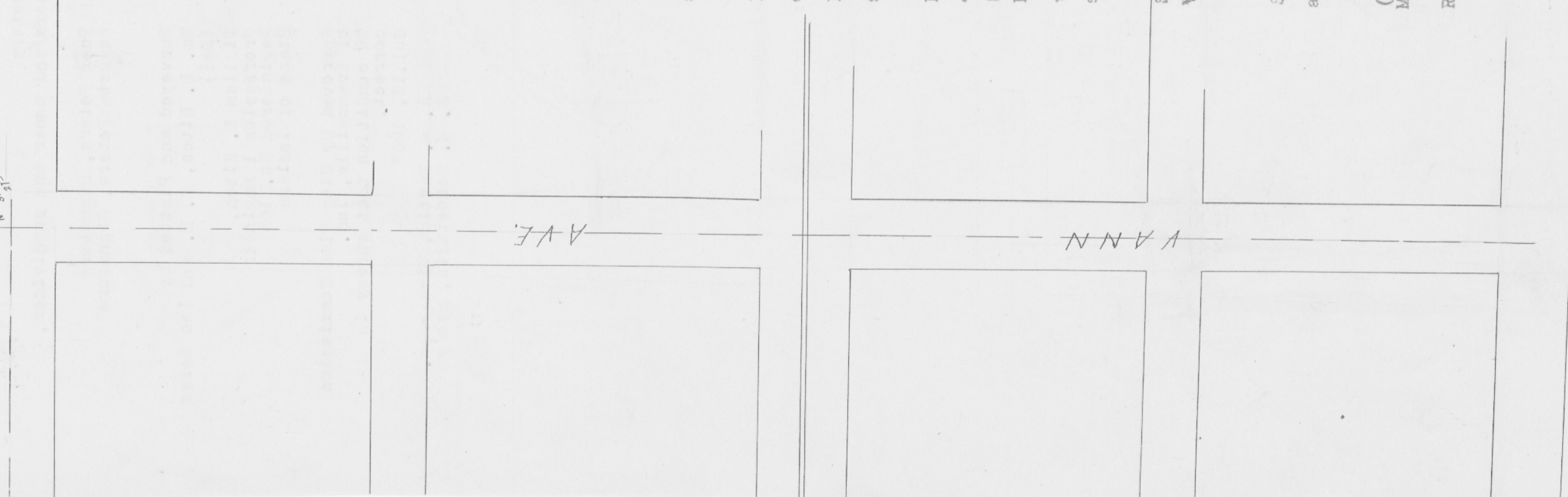

Before me a Notary Public in and for said state and county personally appeared Walter J. Stumpf the proprietor thereof and acknowledged the execution of this plat.

Walter J. Stumpf

Witness my hand and notarial seal this 27th day of October, 1937.

Chas. Mayer, Jr.  
 Notary Public

My commission expires Jan. 13, 1939, (Seal)

Approved By City Plan Commission

of Evansville, Ind.

on condition that survey is correct

Oct. 28, 1937.

E. M. Dickman, Pres

A. W. Schoettlin, Sec'y.

Oct. 22, 1937. (Seal)

Jes. T. Hill

Civil Engr.

LINCOLN MANOR RESTRICTION

No. 1. All lots in this subdivision are sold for residential purposes only, except lots 1-2-3-4-5 and 6 in Block 1, and no building shall be erected thereon that shall contain less than five rooms nor that shall cost less than \$4000.00 when completed and shall be built of first class material on a solid foundation and shall be completed before said occupant shall live therein. Lots 1-2-3-4-5 and 6 in Block 1 can be used for retail commercial purposes and the buildings erected thereon shall not cost less than \$4000.00. All lots except 5 and 6 are restricted against use as service station.

No. 2. No garage or temporary dwelling shall be used as temporary living quarters on any lot in this addition.

No. 3. No part of any dwelling that shall be erected on any lot in this subdivision shall be nearer the front line than 25 ft. nor nearer the side line than 5 ft. on inside lines and 10 ft. on street lines.

No. 4. No garage shall be nearer the rear line of said Lot than 4 ft. A 4 ft. clear strip must be allowed on the rear of each lot as an easement for public extension.

No. 5. This lot shall never be owned, occupied, or leased by any other than those of the Caucasian Race. These restrictions shall run with the land and shall be binding upon all future purchasers or owners of these lots.

Walter J. Stumpf

State of Indiana )  
 Vanderburgh County } SS:

Before me the undersigned, Notary Public, in and for said County and State personally appeared Walter J. Stumpf the owner thereof and acknowledged the execution of this plat.

Witness my hand and Notarial Seal this 27th day of Oct. 1937.

(Seal)

My commission expires Jan 13, 1939. Chas Mayer, Jr.

RECORDED ..... NOVEMBER ..... 1, 1937

*Geo E Imbergerich R.V.C.*