

FIRST AVE.

DUNK AVE.

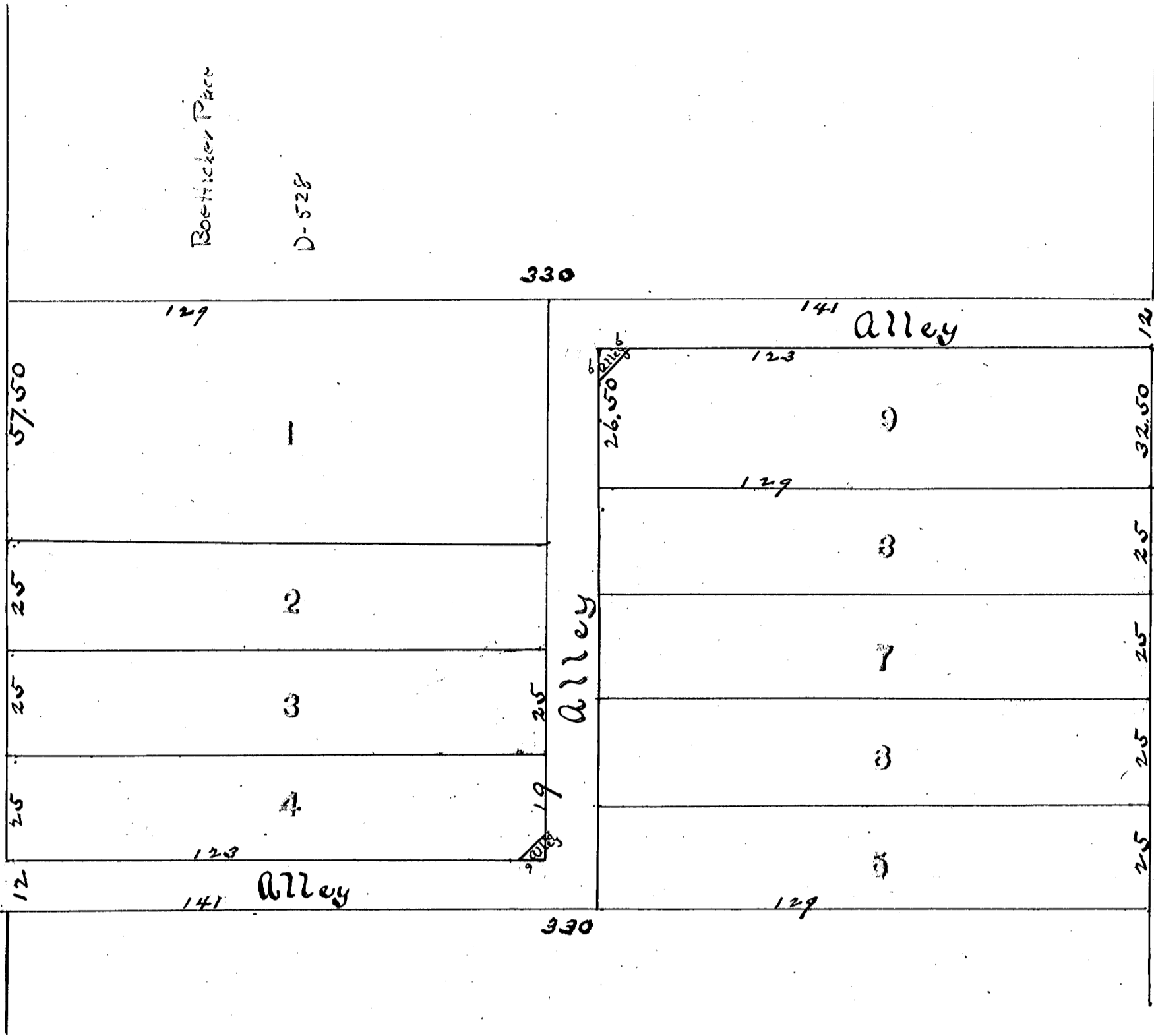

: BOETTICHER PLACE :

Laid out by the Proprietor on all that part of the North East quarter of Section 19 Township 6 South, Range 10 West, described and bounded as follows, to-wit;-  
 Beginning at a point 600-1/2 feet North of the South West corner of said quarter Section, running thence East 330 feet, thence South 144-1/2 feet, thence West 330 feet, thence North to the place of beginning.

Edw Boetticher.

State of Indiana,  
 Vanderburgh County, SS;

Before me, the Recorder in and for said County, personally appeared the above named Edw Boetticher and acknowledged the execution of this Plat.

Witness my hand and seal, this 13th day of Oct 1900.

Edward H. Rasch. R.V.C.



Recorded-----October---13th, 1900.

*Edward H. Rasch*  
*R.V.C.*

Approved Oct 13th, 1900.

M. Gorman.

Henry H. Rietman.

Jas W. Wiltshire.

Board of Public Works.