

BOEHNE-PLACE.

as laid out by the proprietors thereof on part of the North East Quarter of Section 19,
Township 6, South, Range 10 West, described as follows to-wit:

Commencing at a point 30 feet North and 30 feet East of the South West Corner of the
North East Quarter of said Section, running thence North along the East line of 1st Ave,
139 feet, thence East and parallel to Columbia Street 128 feet, thence South 8 feet, thence
East 7 feet, thence South 131 feet to the North line of Columbia Street, thence West 135 feet
to the place of beginning. John R. Sterne being the proprietor of Lot 1, and
J. W. Boehne being the proprietor of Lot 2.

J. W. Boehne.
John R. Sterne.

State of Indiana, Vanderburgh County.
Before me, the Recorder, in and for said
County, this 6th day of November 1899,
personally appeared J. W. Boehne and
John R. Sterne, the proprietors of "Boehne
Place" and acknowledged the execution of the
annexed Plat.
Witness my hand and Official seal,
Edward H. Rasch,
R. Y. C.

FIRST AV.

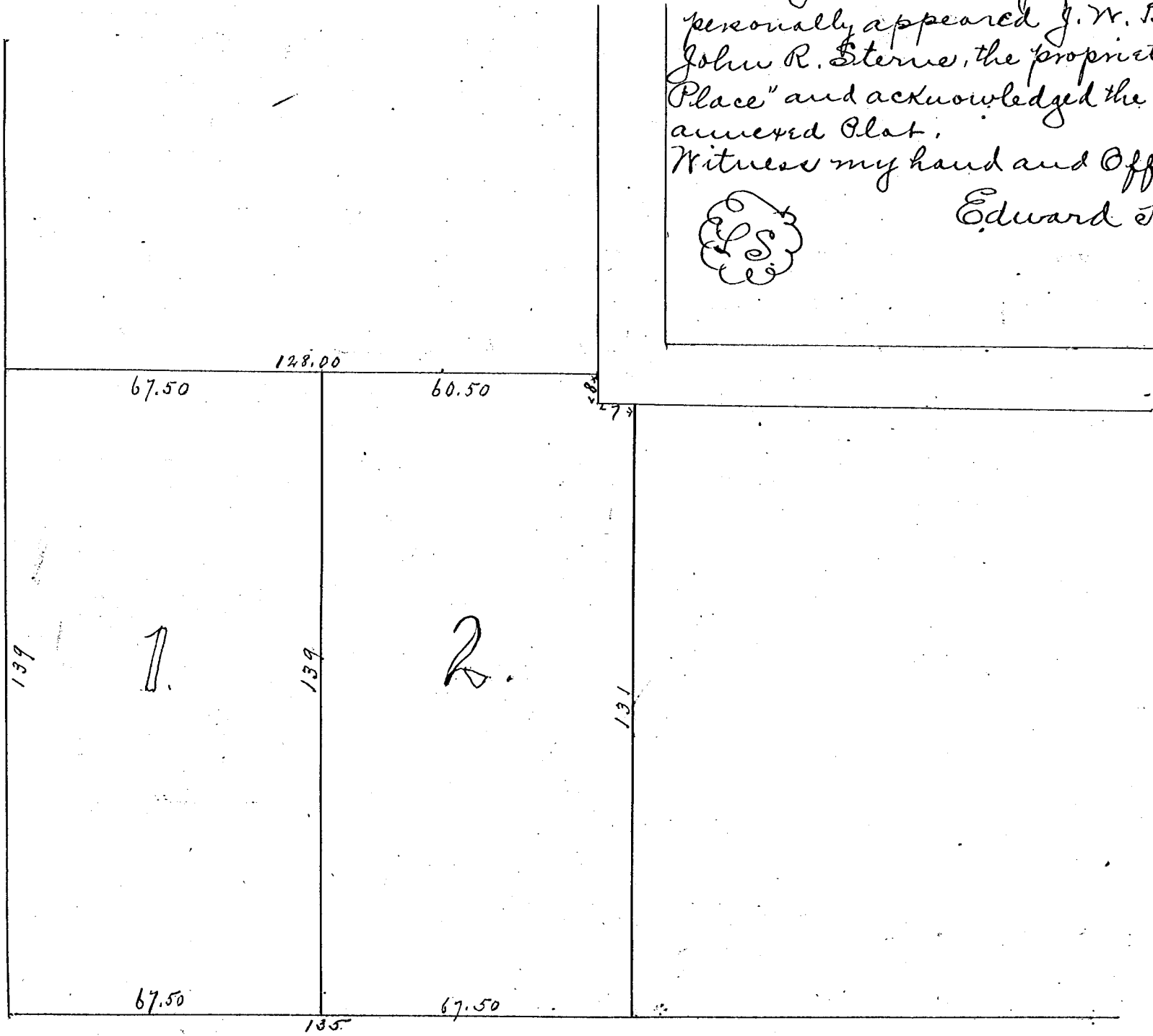

© CENTER OF SECTION 19.6.10.

COLUMBIA ST.

Scale 30 ft. per inch
M.S. Saunders
C.E.

M. Gorman
Henry H. Rietman
Jas W. Wiltshire

Recorded November 6th 1899.
Edward H. Rasch, R. Y. C.
by Geo. J. Mann, Dpt.