

Roadway General Notes:

- The County Engineer's Office shall be notified at least 24 hours prior to initiating any construction activities.
- Contractor shall comply with all local, state and federal codes, ordinances, rules, regulations, orders and other legal requirements of municipal authorities which bear on the performance of the work.
- The contractor is cautioned that the location and/or elevation of existing utilities as shown on these plans is based on records of various utility companies, and where possible measurements taken in the field. The information is not to be relied on as being exact or complete. The contractor must contact the appropriate utility company at least 48 hours before any excavation to request exact field location of utilities. Contractor shall locate existing utilities and establish elevations and clearances with proposed improvements prior to initiating construction.

**Indiana Underground Utility Locate Service
Phone: 811**

- Material specifications shall be in conformance with applicable portions of the INDOT Standard Specifications, (latest edition) unless specifically stated otherwise on these plans, contract documents or local code.
- Areas exposed by excavation or stripping and on which subgrade preparations are to be performed shall be scarified to minimum depth of 8" and compacted to minimum of 95% of optimum density, in accordance with ASTM D 698 (or 92% of optimum density, in accordance with ASTM D 1557), at a moisture content of not less than 1% below and not more than 3% above the optimum moisture content. These areas shall then be proofrolled to detect any areas of insufficient compaction. Proofrolling shall be accomplished by making a minimum of two (2) complete passes with a fully-loaded tri-axle dump truck or approved equivalent, in each of the two perpendicular directions under the supervision and direction of a field geotechnical engineer and a county inspector. Areas of failure shall be excavated and recompacted as stated above. Fill materials used in preparations of subgrade shall be placed in lifts or layers not to exceed 8" loose measure and compacted to a minimum density of 95% of optimum density, in accordance with ASTM D 698, (or 92% of the optimum density, in accordance with ASTM D 1557) at a moisture content of not less than 1% below and not more than 3% above the optimum moisture content.
- All dirt work graded slopes to be no greater than 3:1, unless otherwise noted on these drawings.
- Existing ditches located under proposed roadways shall be undercut a minimum of 1'. Cut areas shall not be backfilled until an inspection and approval are given from the local engineers office.

010ETALSctvctee052_RoadGenNotes DWG Date: 09-28-10

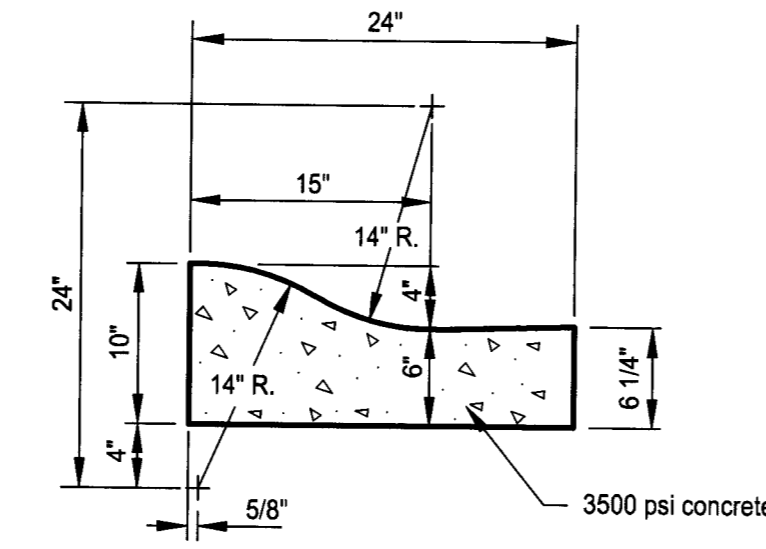
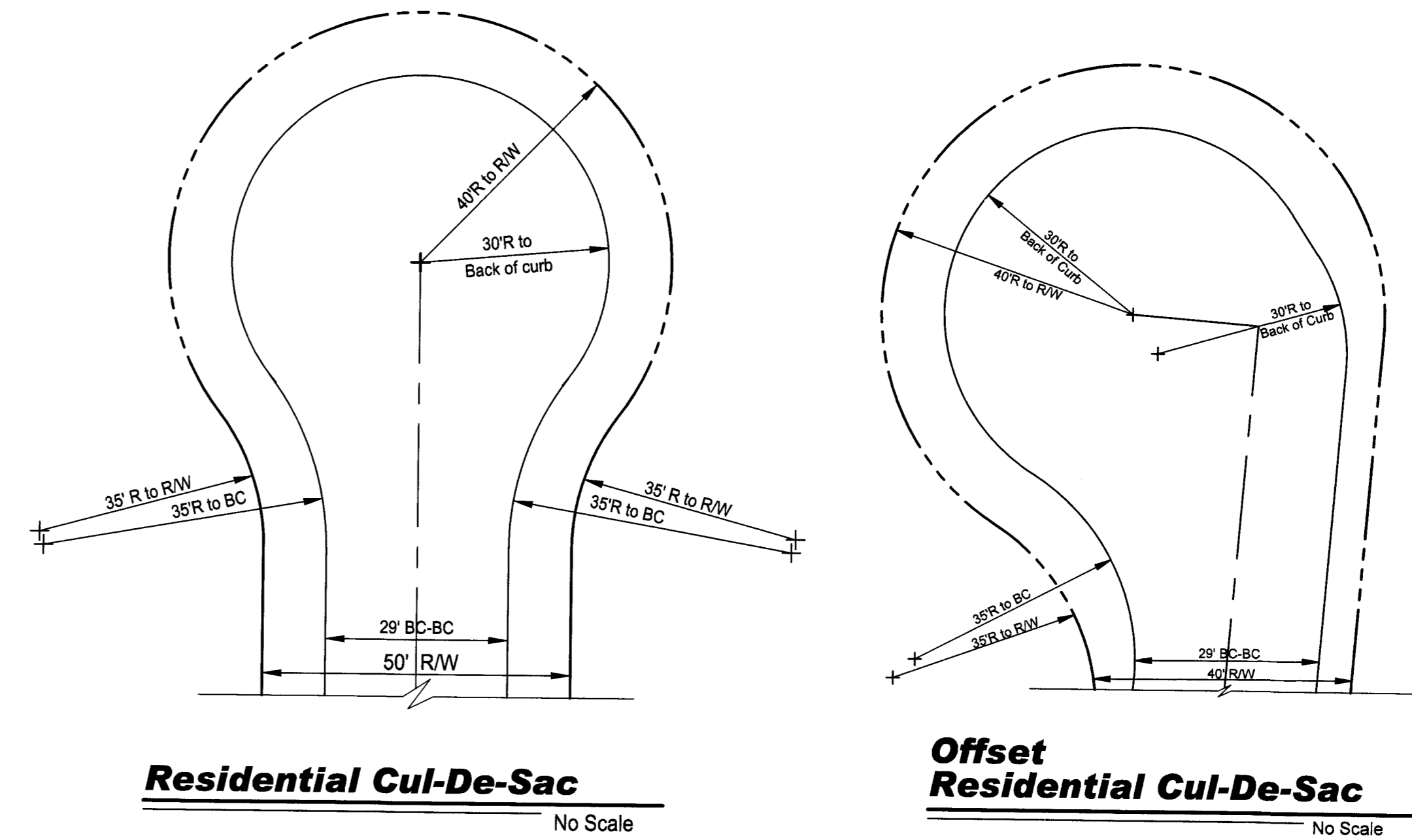

- Notes:**
- 1/2" preformed expansion joint material at all P.C. & P.T. of curb radius.
 - Tooled contraction joints at 10'-0" centers. Contraction joints to be minimum 2" deep and 1/8" to 1/4" wide.

Concrete Roll Curb and Gutter
No Scale

010ETALSctvctee052_RoadGenNotes DWG Date: 10-31-09

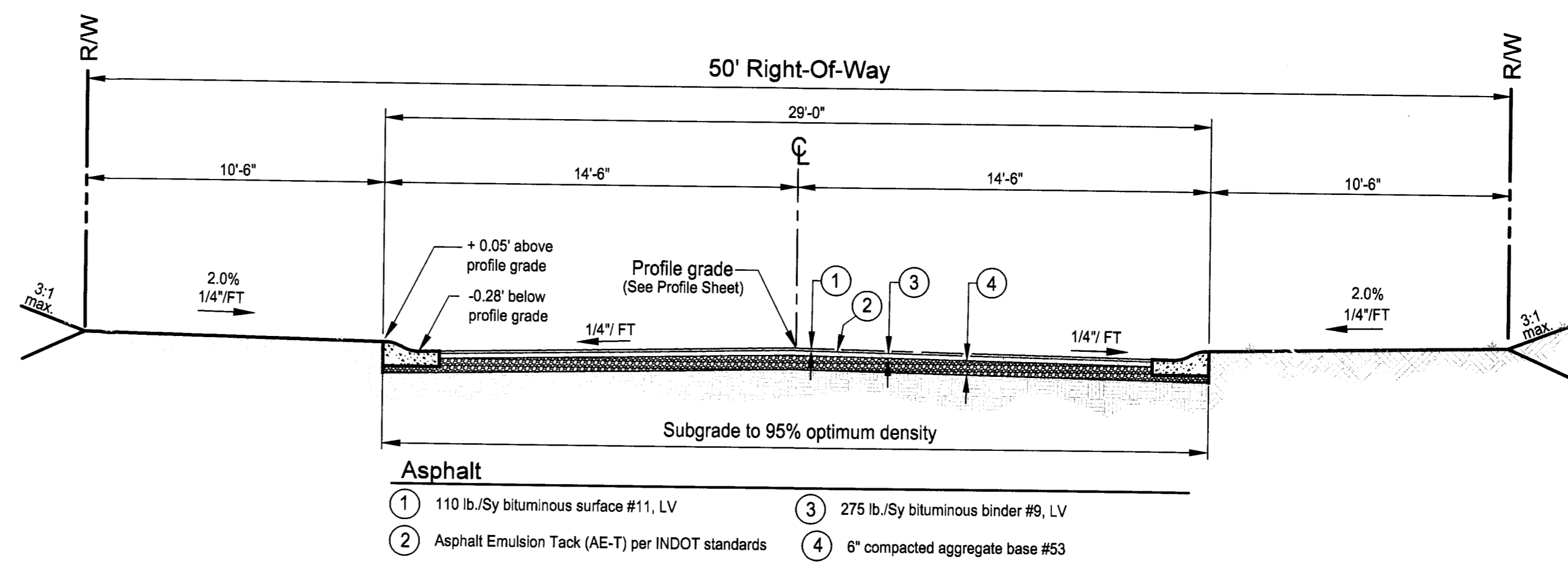

29' Residential Bituminous Pavement Section - Concrete Roll Curb and Gutter in 50' RW
No Scale

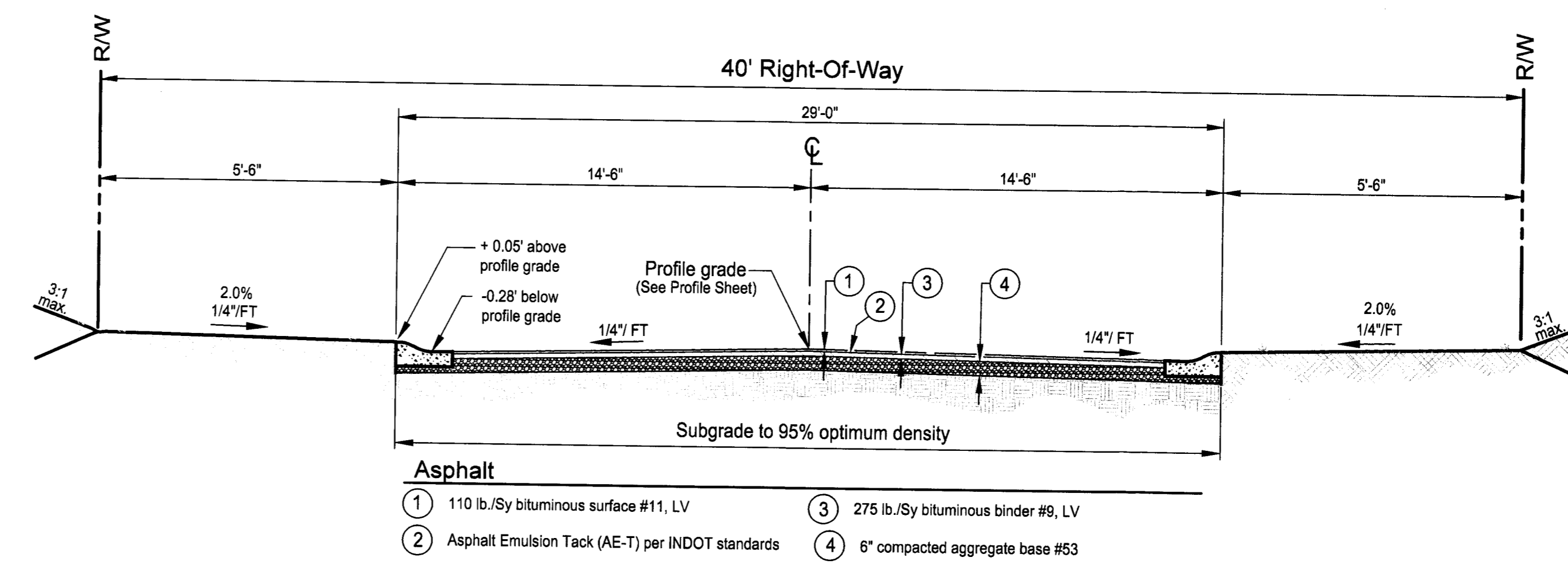

29' Residential Bituminous Pavement Section - Concrete Roll Curb and Gutter in 40' RW
No Scale

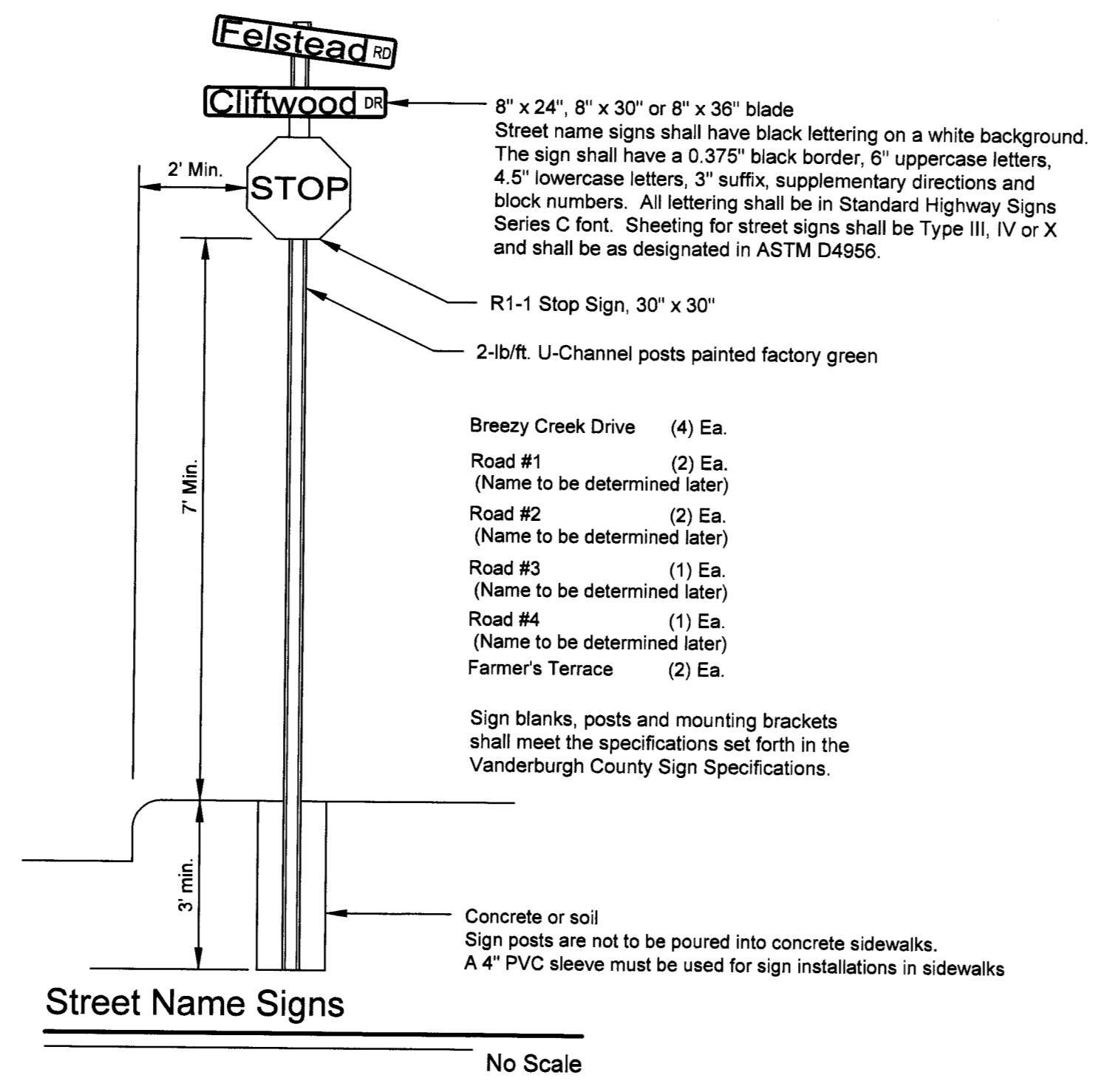

Morley and Associates, Inc.
Engineering
Surveying
Architecture
Construction Management

4800 Rosebud Lane
Newburgh, IN 47630
(812) 464-9885
www.morleyandassociates.com

No.	By	Date	Description

JAMES E. MORLEY
REGISTERED
No. 10100250
STATE OF INDIANA
PROFESSIONAL ENGINEER

Jan L. ...
4-1-16

The Hills - Sterchi Homes Corporation

Road Details
The Hills
Evansville, Indiana

APPROVED

APR 05 2016 Scale: 1" = 50'

Designed By: JCH/DEM Job Number: 5553.4.007-B
Drawn By: ARK Date: 4/4/2016
File Name: J:\5000\5500-5599\553\2016\The Hills Base ARKS.dwg
Sheet Number: **C-501**

RECEIVED BY THE
VANDERBURGH COUNTY
SURVEYOR'S OFFICE
4/15/16 BR