

**MORLEY**  
ARCHITECTS | ENGINEERS | SURVEYORS

All ideas, designs, calculations, and arrangements indicated or represented by this drawing are owned by and are the property of Morley and Associates, Inc. and were created as instruments of service for use on and in connection with the specified project. Morley and Associates retains all common law, statutory law and other rights, including copyrights. No drawings or electronic files shall be reused for any purpose other than the project. They shall not be disclosed to or be used by any other person or firm without the written consent of Morley and Associates, Inc. Written dimensions on these drawings shall have precedence over scale dimensions. Contractors shall verify and be responsible for all dimensions and conditions on the job and Morley and Associates, Inc. must be notified of any variations from the dimensions and conditions shown by these drawings. If differences exist between electronic files and the signed and sealed hard copy drawings, the hard copy shall govern.

4800 Rosebud Ln, Newburgh, IN 47630  
812.464.9585 Phone 812.464.2514 Fax  
morleycorp.com

**Sanitary Sewer Line A Profile**

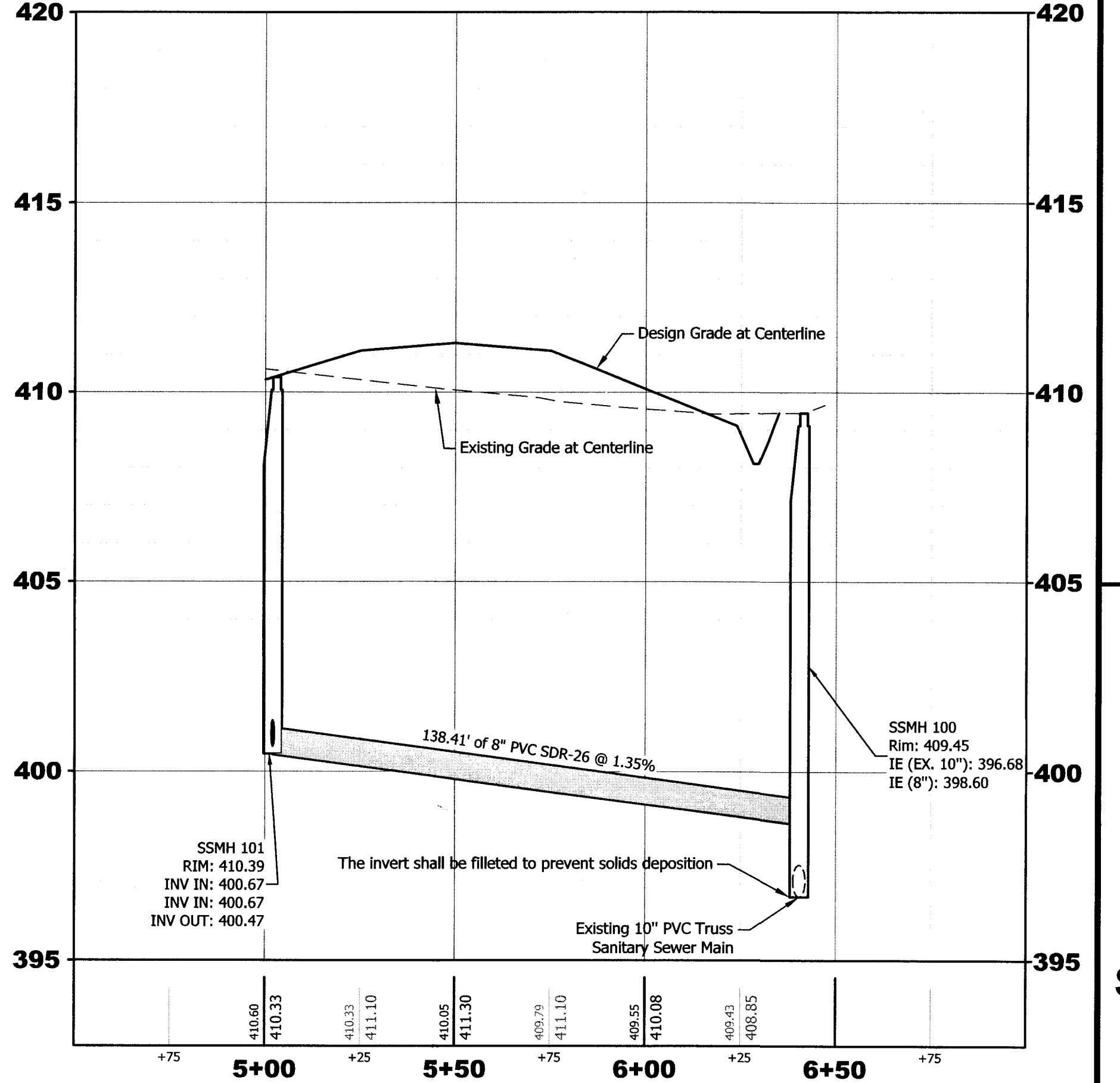

**Road 1 Profile**

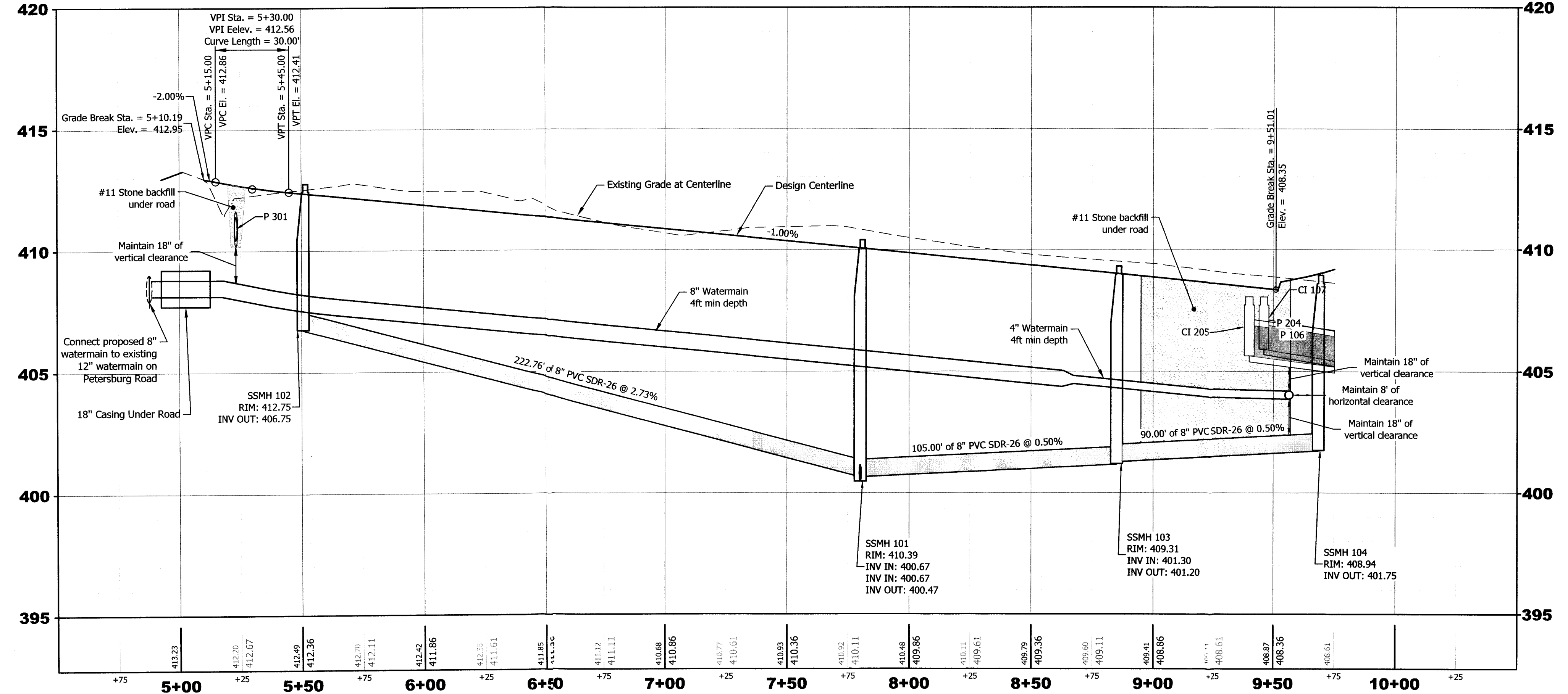

**NOTE:**  
• Storm pipes in profile view show inside wall of pipe. Pipe thickness has been accounted for vertical clearance. Separation between water mains and sewer lines shall be 10' horizontally and 18" vertically measured from outside edge of pipe.  
• Backfill is required under road for water main and sewer pipes under all road section.

Nevayah Place

**Road 1 and Sanitary Sewer Line A Plan and Profile**

No.	By	Date
<b>Revisions</b>		
Scale: H: 1" = 30' V: 1" = 3'		
Designed By:	JEM	Job Number: 10390.4.001-B
Drawn By:	AMC	Date: 8/19/19
Filename:	10390 Civil Base	
Sheet Number:	<b>C102</b>	

RETRACTED BY THE SURVEYORS OFFICE  
8-19-19