

Location Map (Not to Scale)

SWALE TABLE		
Swale Number	Length Feet	Erosion Control Protection Required
#2	154	Seeded and Mulched
#3	244	Seeded and Mulched
#4	90	Seeded and Mulched

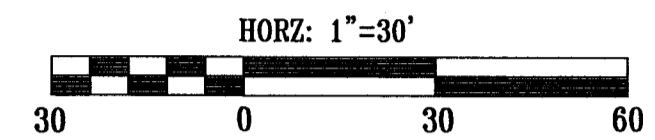
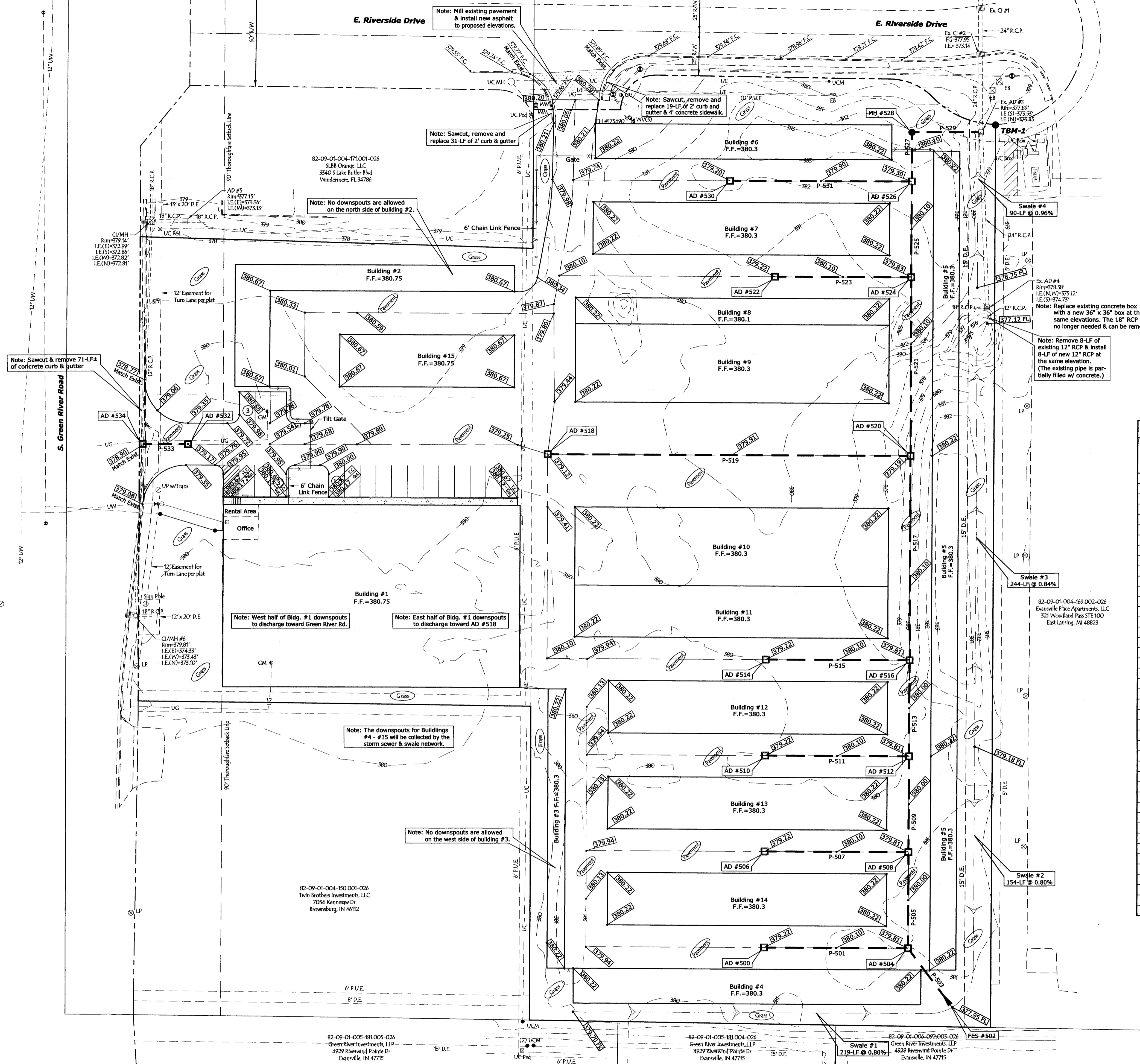

STORM SEWER STRUCTURE DATA TABLE							
Structure Number	Size	Description	Length Feet	Invert In Elev.	Invert Out Elev.	Slope %	Rim = AD/MH FG = CI IE = FES Elev.
AD #500	30" x 30" Box						379.22
P-501	12"	R.C.P. Cl. III	83	376.97	376.64	0.40	
FES #502	12"	End Section					377.95
P-503	12"	R.C.P. Cl. III	35	377.76	376.64	3.20	
AD #504	30" x 30" Box						379.81
P-505	12"	R.C.P. Cl. III	55	376.64	376.42	0.40	
AD #506	30" x 30" Box						379.22
P-507	12"	R.C.P. Cl. III	83	376.97	376.42	0.66	
AD #508	30" x 30" Box						379.81
P-509	15"	R.C.P. Cl. III	55	376.42	376.20	0.40	
AD #510	30" x 30" Box						379.22
P-511	12"	R.C.P. Cl. III	83	376.97	376.20	0.93	
AD #512	30" x 30" Box						379.81
P-513	15"	R.C.P. Cl. III	55	376.20	375.74	0.84	
AD #514	30" x 30" Box						379.22
P-515	12"	R.C.P. Cl. III	83	376.97	375.74	1.48	
AD #516	30" x 30" Box						379.81
P-517	18"	R.C.P. Cl. III	118	375.74	374.99	0.64	
AD #518	30" x 30" Box						379.12
P-519	15"	R.C.P. Cl. III	208	376.62	374.83	0.86	
AD #520	36" x 36" Box						379.19
P-521	24"	R.C.P. Cl. III	103	374.83	374.35	0.47	
AD #522	30" x 30" Box						379.22
P-523	12"	R.C.P. Cl. III	78	376.97	374.35	3.36	
AD #524	36" x 36" Box						379.83
P-525	24"	R.C.P. Cl. III	55	374.35	374.02	0.59	
AD #526	36" x 36" Box						379.30
P-527	24"	R.C.P. Cl. III	28	374.02	373.82	0.73	
MH #528	36" x 36" Box						379.90
P-529	24"	R.C.P. Cl. III	40	373.82	373.53	0.73	
AD #530	30" x 30" Box						379.20
P-531	12"	R.C.P. Cl. III	104	376.70	375.66	1.00	
AD #532	30" x 30" Box						379.17
P-533	12"	R.C.P. Cl. III	24	376.17	375.69	2.00	
AD #534	30" x 30" Box	Exist. 12" RCP I.E. = 373.00					378.90

BENCHMARK
 TBM-1 - 5/8" rebar with Morley Cap located at the northeast property corner. Elevation = 378.80' (NAVD 1988)

APPROVED

JUN 27 2023
 VANDERBURGH COUNTY DRAINAGE BOARD
 Received by the Vanderburgh County Surveyor's Office
 JUN 26 2023
 Time 9:20 AM Initials AR

This drawing and/or specifications is provided as an instrument of service provided by Cash Wagner & Associates, PC and is intended for use on this project only. All drawings, specifications, designs, models, ideas, calculations, and arrangements appearing herein constitutes the original and unaltered work of and remains the property of Cash Wagner & Associates, PC. Any reproduction, use or disclosure of the proprietary information contained herein without the prior written consent of the Cash Wagner & Associates, PC is strictly prohibited.

Written dimensions shown hereon shall take precedence over scaled dimensions. Contractors shall calculate and measure required dimensions. Notify Cash Wagner & Associates, PC with any variations in dimensions or conditions from those indicated on these drawings. This drawing was based on available information. Commencement of work constitutes verification and acceptance of existing conditions.

Application of a material or equipment to work installed by others constitutes acceptance of that work and assumption of responsibility for satisfactory installation.

CASH WAGGNER & ASSOCIATES, P.C.
 414 CITADEL CIRCLE SUITE B
 EVANSVILLE, IN 47715
 PH: 812.401.5561
 FAX: 812.401.5563
 CELL: 812.774.2988
 E-MAIL: GMERITT@CASHWAGGNER.COM

Signature: *G. Meritt*
 Date: 23 June 23

CASH WAGGNER & ASSOCIATES, P.C.

NO.	DATE	BY	DESCRIPTION
1	05.26.23	G.A.M.	Revised building #2 footprint & added building #15
2	06.21.23	G.A.M.	Added benchmark, downspout notes, AD #530 and P-531 revised building #2 & #15 footprints
3	06.23.23	G.A.M.	Added AD #532, P-533 & AD #534

PROJECT NO.: 22-5341
 DESIGNED BY: G.A.M.
 DRAWN BY: A.W.W.
 FILENAME: 5341 BASE
 LAYOUT TAB: DRAINAGE
 SCALE: As Shown

PROJECT: **MACWIL SUBDIVISION**
 ADDRESS: **2700 S. GREEN RIVER ROAD EVANSVILLE, INDIANA**

DATE: **04.26.23**
 DRAWING NO.: **C-102**