

CROSS SECTION C-C

Scale: N.T.S.

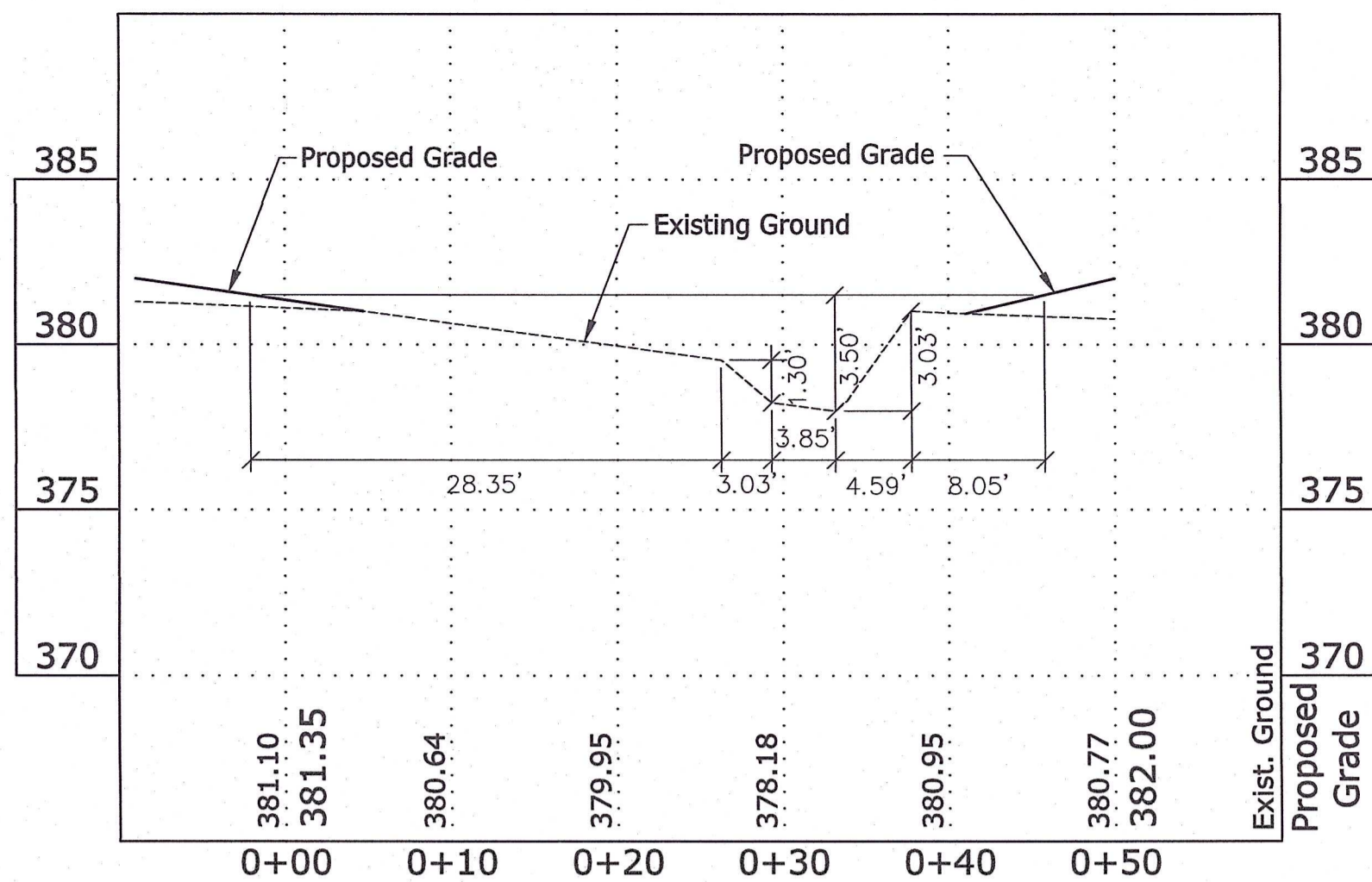

CROSS SECTION K-K

Scale: N.T.S.

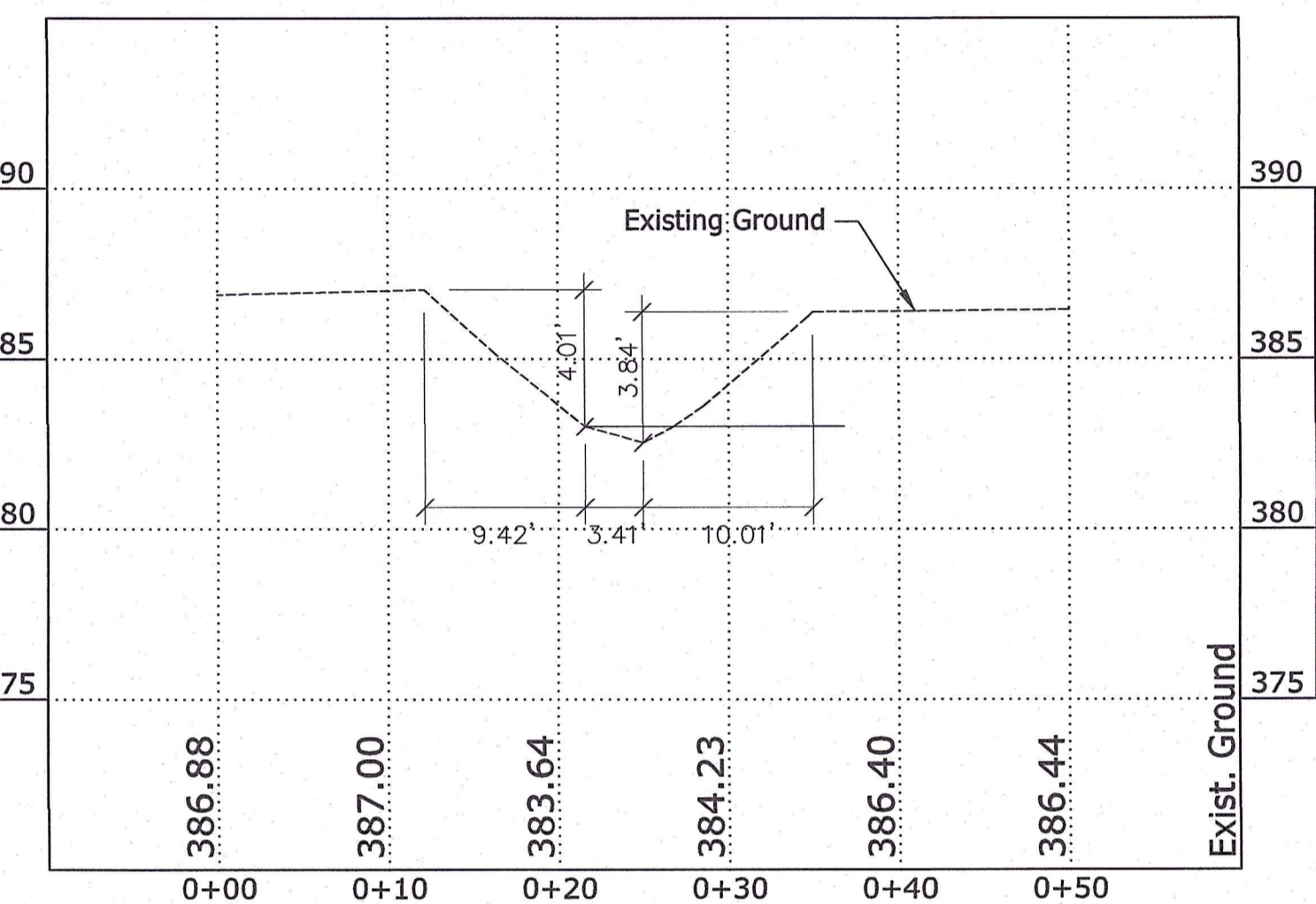

CROSS SECTION I-I

Scale: N.T.S.

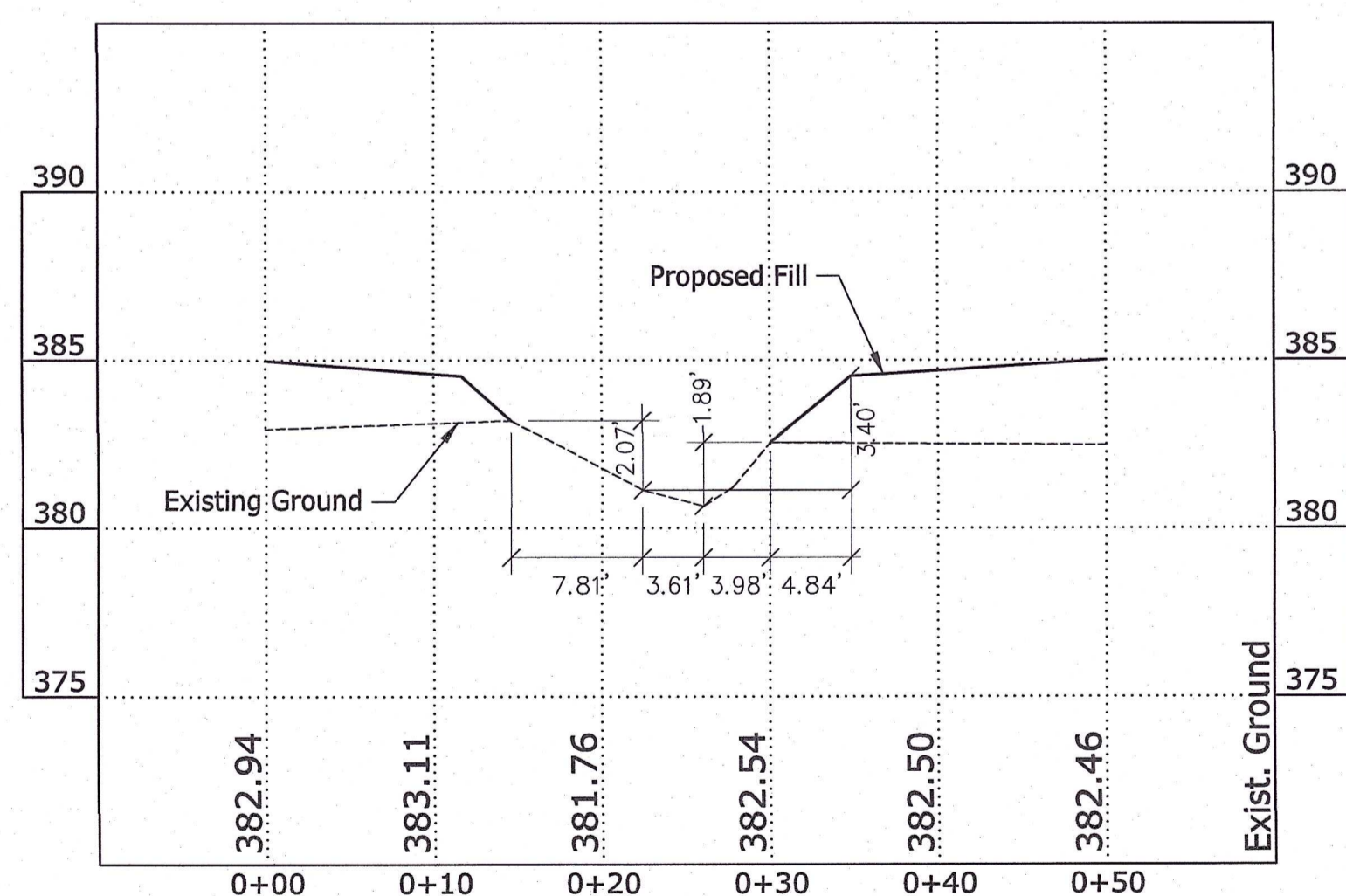

CROSS SECTION J-J

Scale: N.T.S.

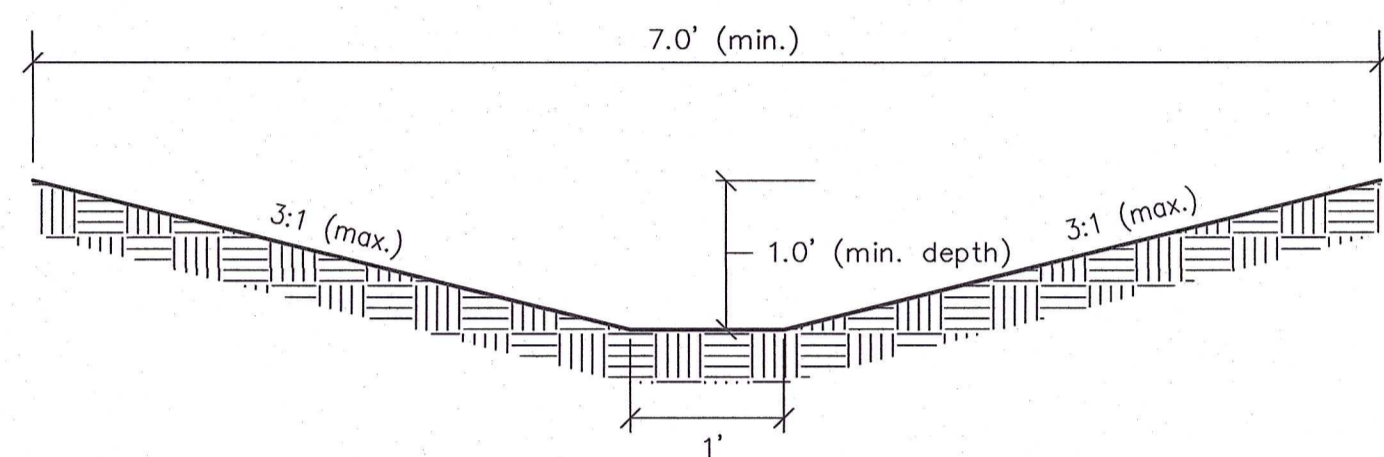

SIDE YARD SWALE CROSS-SECTION

Scale: N.T.S.

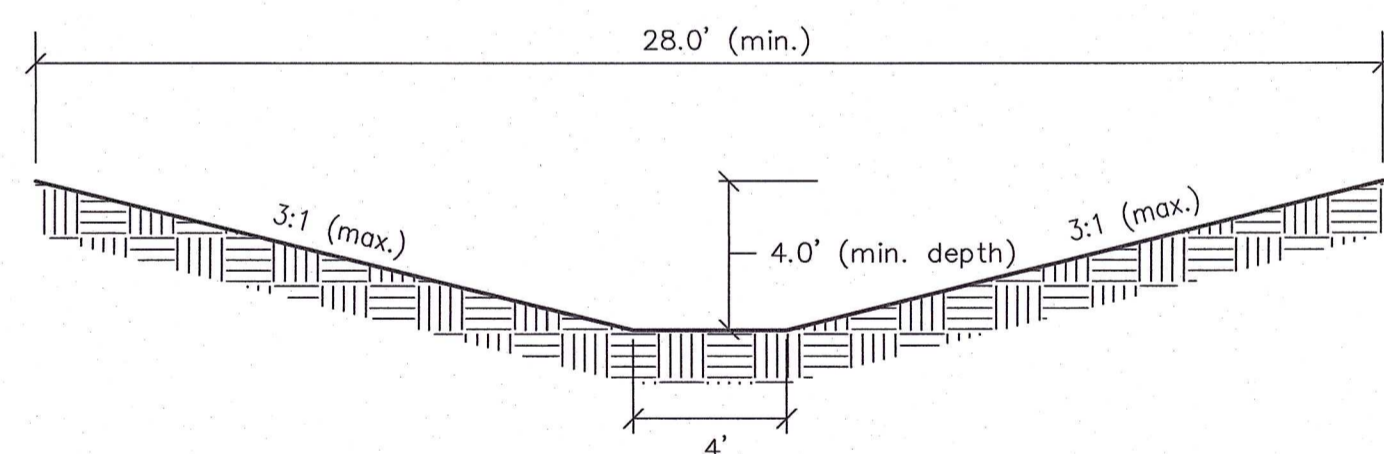

CROSS-SECTION L-L

Scale: N.T.S.

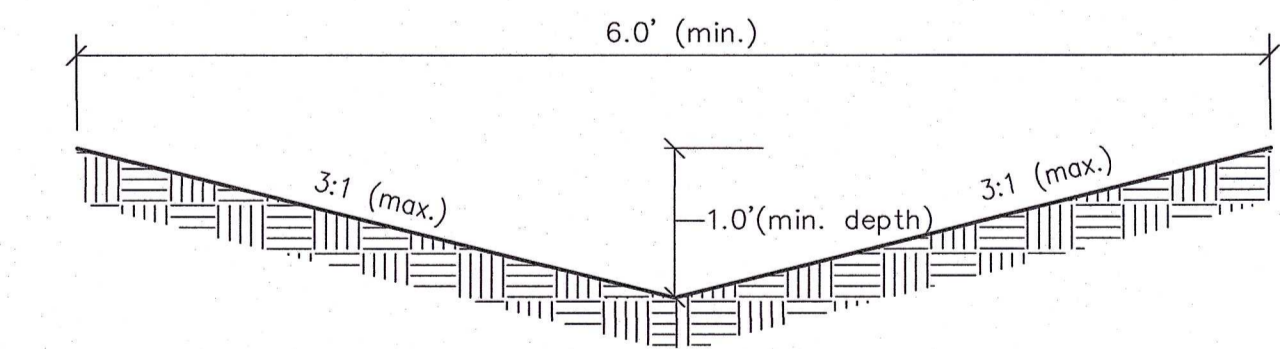

SURFACE OVERFLOW SPILLWAY CROSS-SECTION

Scale: N.T.S.

- NOTES:
1. Required between lots 30 & 31, 39 & 40, 41 & 42, 49 & 50, 79 & 80, 85 & 86, 106 & 107, 112 & 113 115 & 116, 120 & 121, 124 & 125, 164 & 165, 168 & 169.
 2. The high point of the spillway shall be located at the back of the sidewalk.
 3. The maximum elevation of the spillway shall be 6" above the curb inlet front of grate elevation unless otherwise noted.

SWALE TABLE

Swale Number	Slope %	Length Feet	Erosion Control Protection Required
#1	1.53	249	Erosion Control Blanket
#2	0.80	240	Seeded and Mulched
#3	0.80	60	Seeded and Mulched
#4	0.80	240	Seeded and Mulched
#5	0.80	239	Seeded and Mulched
#6	0.80	292	Seeded and Mulched
#7	0.80	439	Seeded and Mulched
#8	2.47	170	Staked Sod
#9	2.16	104	Staked Sod
#10	0.80	489	Seeded and Mulched
#11	0.80	310	Seeded and Mulched
#12	0.80	315	Seeded and Mulched
#13	1.30	260	Erosion Control Blanket
#14	0.80	288	Seeded and Mulched
#15	1.81	150	Erosion Control Blanket
#16	0.80	177	Seeded and Mulched
#17	0.80	110	Seeded and Mulched

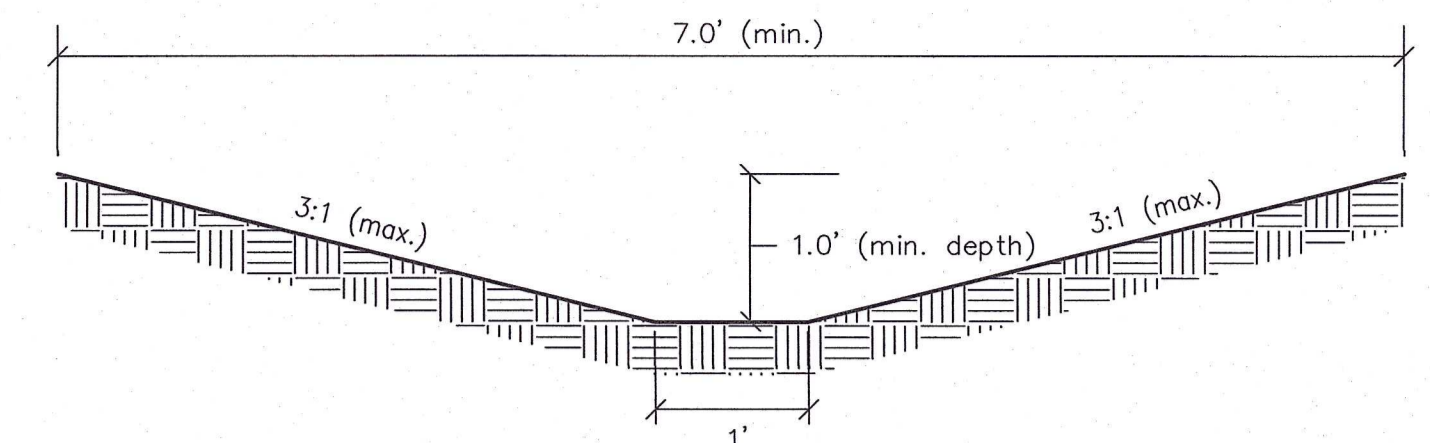

TYPICAL SWALE CROSS-SECTION

Scale: N.T.S.

STORM SEWER STRUCTURE DATA TABLE

Structure Number	Size	Description	Length Feet	Invert In Elev.	Invert Out Elev.	Slope %	Rim = AD/MH
							FG = CI IE = FES Elev.
Double CI #500	24" x 74" Box						384.51
P-501	15" R.C.P. CI. III	52	382.01	381.86	0.29		379.92
CI #502	24" x 36" Box						384.51
P-503	15" R.C.P. CI. III	27	381.86	381.65	0.77		379.92
Double CI #504	24" x 74" Box						384.51
P-505	18" R.C.P. CI. III	150	381.65	380.46	0.80		384.51
FES #506	12" End Section						383.78
P-507	12" R.C.P. CI. III	137	383.68	381.33	1.71		384.52
Double CI #508	24" x 74" Box						384.52
P-509	15" R.C.P. CI. III	26	381.33	380.89	1.71		384.52
Double CI #510	24" x 74" Box						384.52
P-511	24" R.C.P. CI. III	150	380.89	380.46	0.29		384.70
AD #512	30" x 46" Box						384.70
P-513	30" R.C.P. CI. III	135	380.46	379.97	0.36		384.43
CI #514	30" x 46" Box						384.43
P-515	30" R.C.P. CI. III	26	379.97	379.88	0.36		384.43
CI #516	30" x 46" Box						384.43
P-517	30" R.C.P. CI. III	41	379.88	379.72	0.38		379.70
FES #518	30" End Section						379.70
FES #520	18" End Section						382.32
P-521	18" R.C.P. CI. III	132	382.27	381.16	0.84		384.52
CI #522	24" x 36" Box						384.52
P-523	18" R.C.P. CI. III	27	381.16	380.87	1.09		384.52
CI #524	24" x 36" Box						384.52
P-525	21" R.C.P. CI. III	128	380.87	379.75	0.87		379.70
FES #526	21" End Section						379.70
CI #528	24" x 36" Box						384.51
P-529	12" R.C.P. CI. III	26	382.26	382.14	0.46		384.51
CI #530	24" x 36" Box						384.51
P-531	12" R.C.P. CI. III	129	382.14	379.81	1.81		379.70
FES #532	12" End Section						379.70
CI #632	24" x 36" Box						384.51
P-633	12" R.C.P. CI. III	26	382.26	381.74	2.00		384.51
CI #634	24" x 36" Box						384.51
P-635	18" R.C.P. CI. III	197	381.74	381.05	0.35		384.51
CI #534	24" x 36" Box						384.51
P-535	18" R.C.P. CI. III	26	381.05	380.94	0.44		384.51
CI #536	24" x 36" Box						384.51
P-537	18" R.C.P. CI. III	129	380.94	379.76	0.91		379.70
FES #538	18" End Section						379.70
FES #540	15" End Section						379.70
P-541	15" R.C.P. CI. III	35	379.55	378.65	2.56		378.65
HW #542	15" Headwall w/ Flaggate						378.65
CI #544	24" x 36" Box						384.30
P-545	12" R.C.P. CI. III	59	378.12	377.33	1.34		377.25
FES #546	12" End Section						377.25
CI #548	24" x 36" Box						384.51
P-549	12" R.C.P. CI. III	26	382.26	382.12	0.52		384.51
CI #550	24" x 36" Box						384.51
P-551	12" R.C.P. CI. III	195	382.12	377.41	2.42		380.50
AD #552	30" x 30" Box						380.50
P-553	18" R.C.P. CI. III	49	377.41	377.27	0.29		377.25
FES #554	18" End Section						377.25
CI #556	24" x 36" Box						384.30
P-557	12" R.C.P. CI. III	42	382.20	381.99	0.50		384.30
CI #558	24" x 36" Box						384.30
P-559	12" R.C.P. CI. III	38	381.99	380.70	3.40		384.53
CI #560	24" x 36" Box						384.53
P-561	12" R.C.P. CI. III	152	380.70	377.38	2.18		377.25
FES #562	12" End Section						377.25

STORM SEWER STRUCTURE DATA TABLE

Structure Number	Size	Description	Length Feet	Invert In Elev.	Invert Out Elev.	Slope %	Rim = AD/MH
							FG = CI IE = FES Elev.
HW #564	60" Headwall						379.92
P-565	60" R.C.P. CI. III	114	379.92	379.75	0.15		379.75
HW #566	60" Headwall						379.75
FES #570	12" End Section						377.25
P-571	12" R.C.P. CI. III	73	377.23	377.00	0.32		377.00
HW #572	12" Headwall w/ Flaggate						377.00
CI #574	24" x 36" Box						384.52
P-575	12" R.C.P. CI. III	26	382.27	382.02	0.95		384.52
CI #576	24" x 36" Box						384.52
P-577	15" R.C.P. CI. III	126	382.02	380.24	1.42		380.15
FES #578	15" End Section						380.15
CI #580	24" x 36" Box						384.51
P-581	12" R.C.P. CI. III	26	382.26	382.01	0.95		384.51
CI #582	24" x 36" Box						384.51
P-583	15" R.C.P. CI. III	126	382.01	380.23	1.41		380.15
FES #584	15" End Section						380.15
FES #586	12" End Section						382.70
P-587	12" R.C.P. CI. III	137	382.68	382.26	0.31		384.51
CI #588	24" x 36" Box						384.51
P-589	12" R.C.P. CI. III	26	382.26	381.92	1.30		384.51
CI #590	24" x 36" Box						384.51
P-591	12" R.C.P. CI. III	36	381.92	380.40	4.20		380.15
FES #592	12" End Section						380.15
FES #594	12" End Section						381.62
P-595	12" R.C.P. CI. III	101	381.59	381.02	0.56		385.30
MH #596	30" x 30" Box						385.30
P-597	12" R.C.P. CI. III	27	381.02	380.88	0.54		384.51
CI #598	24" x 36" Box						384.51
P-599	15" R.C.P. CI. III	26	380.88	380.72	0.58		384.51
CI #600	24" x 36" Box						384.51
P-601	18" R.C.P. CI. III	126	380.72	380.18	0.43		380.15
FES #602	18" End Section						380.15
CI #604	24" x 36" Box						384.44
P-605	12" R.C.P. CI. III	26	382.19	381.94	0.95		384.44
CI #606	24" x 36" Box						384.44
P-607	15" R.C.P. CI. III	126	381.94	380.23	1.36		380.15
FES #608	15" End Section						380.15
FES #610	12" End Section						380.15
P-611	12" R.C.P. CI. III	55	380.06	379.19	1.57		384.00
MH #612	30" x 30" Box						384.00
P-613	12" R.C.P. CI. III	19	379.19	378.89	1.58		378.89
HW #614	12" Headwall w/ Flaggate						378.89
HW #616	45" x 73" Headwall						381.15
P-617	45" x 73" R.C.P. CI. III	66	381.15	381.05	0.15		381.05
HW #618	45" x 73" Headwall						381.05
FES #620	15" End Section						388.80
P-621	15" R.C.P. CI. III	71	388.74	388.06	0.96		388.00
FES #622	15" End Section						388.00
CI #624	24" x 36" Box						392.24
Existing 18" R.C.P.							387.94
FES #626	15" End Section						385.82
P-627	15" R.C.P. CI. III	65	385.77	385.27	0.78		385.22
FES #628	15" End Section						385.22

This drawing and/or specifications is provided as an instrument of service provided by Cash Wagner & Associates, PC and is intended for use on this project only. All drawings, specifications, designs, models, ideas, calculations, and arrangements appearing herein constitute the original and unpublished work of and remains the property of Cash Wagner & Associates, PC. Any reproduction, use or disclosure of the proprietary information contained herein without the prior written consent of Cash Wagner & Associates, PC is strictly prohibited.

Written dimensions shown hereon shall take precedence over scaled dimensions. Contractors shall calculate and measure required dimensions. Notify Cash Wagner & Associates, PC with any variations in dimensions or conditions from those indicated on these drawings. This drawing was based on available information. Commencement of work constitutes verification and acceptance of existing conditions.

Application of a material or equipment to work installed by others constitutes acceptance of that work and assumption of responsibility for satisfactory installation.

GLEN A. MERRITT, P.E.
No. PE10409870
STATE OF INDIANA
PROFESSIONAL ENGINEER

Glen A. Merritt
SIGNATURE

22 Aug 22
DATE

CASH WAGNER & ASSOCIATES, P.C.
CONSULTING | ENGINEERING | SURVEYING

414 CITADEL CIRCLE
SUITE B
EVANSVILLE, IN 47715
PH: 812.401.5561
FAX: 812.401.5563
CELL: 812.774.2988
E-MAIL: GMERRITT@CASHWAGNER.COM

NO.	DATE	BY	DESCRIPTION
1	08.11.22	G.A.M.	Added side yard swale cross section and cross section K-K
2	08.22.22	G.A.M.	Added cross section L-L

REVISIONS

PROJECT: GOLDFINCH COVE
GREEN RIVER ROAD
EVANSVILLE, INDIANA

DATE: 07.20.22

DRAWING NO.: C-121

SHEET TITLE: DRAINAGE DETAILS SHEET 2

PROJECT NO.: 22-5012

DESIGNED BY: FILENAME: 5012 DrainageDtls

DRAWN BY: G.A.M.

LAYOUT TAB: SCALE: As Shown

RECEIVED
AUG 22 2022
Vanderburgh County Engineering