

**Note:**  
 All pipes measured center of structure to center of structure, to the nearest foot. All storm, sanitary and lateral pipes crossing roadway shall have sand backfill under and within 5 feet of pavement.  
 All storm sewer pipes shall be RCP, unless approved otherwise by owner and engineer.

STR#	LENGTH (FT)	SLOPE (FT/FT)	SIZE (IN)
1133	SEE SHEET 5		
1135	428	0.0517	12"
1140A	8	0.0050	15"
1139	27	0.0050	12"
1137	134	0.0148	12"
1141	430	0.0055	21"
1143	34	0.0035	12"
1145	SEE SHEET 9		

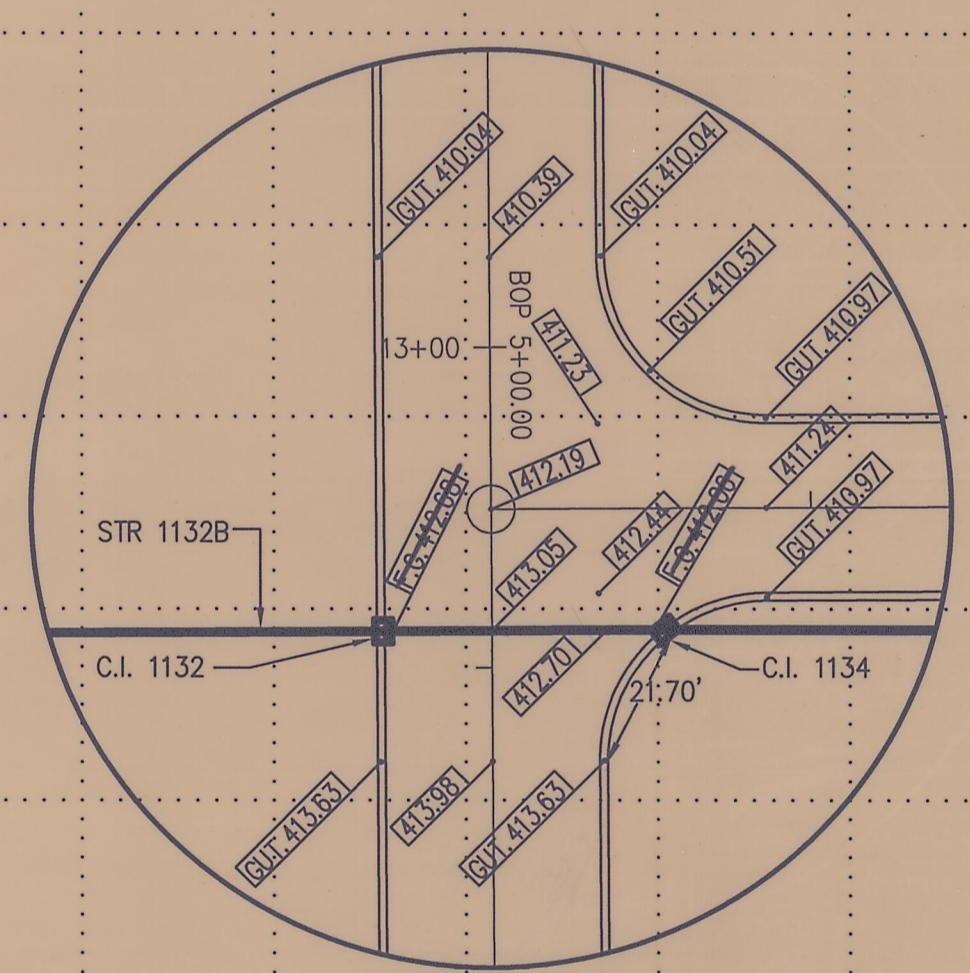

SCALE: 1" = 30'  
 DISTANCE IN CORNERS ARE FROM PC TO BACK OF CURB  
**CONTI DRIVE - CLEAR CREEK DRIVE**

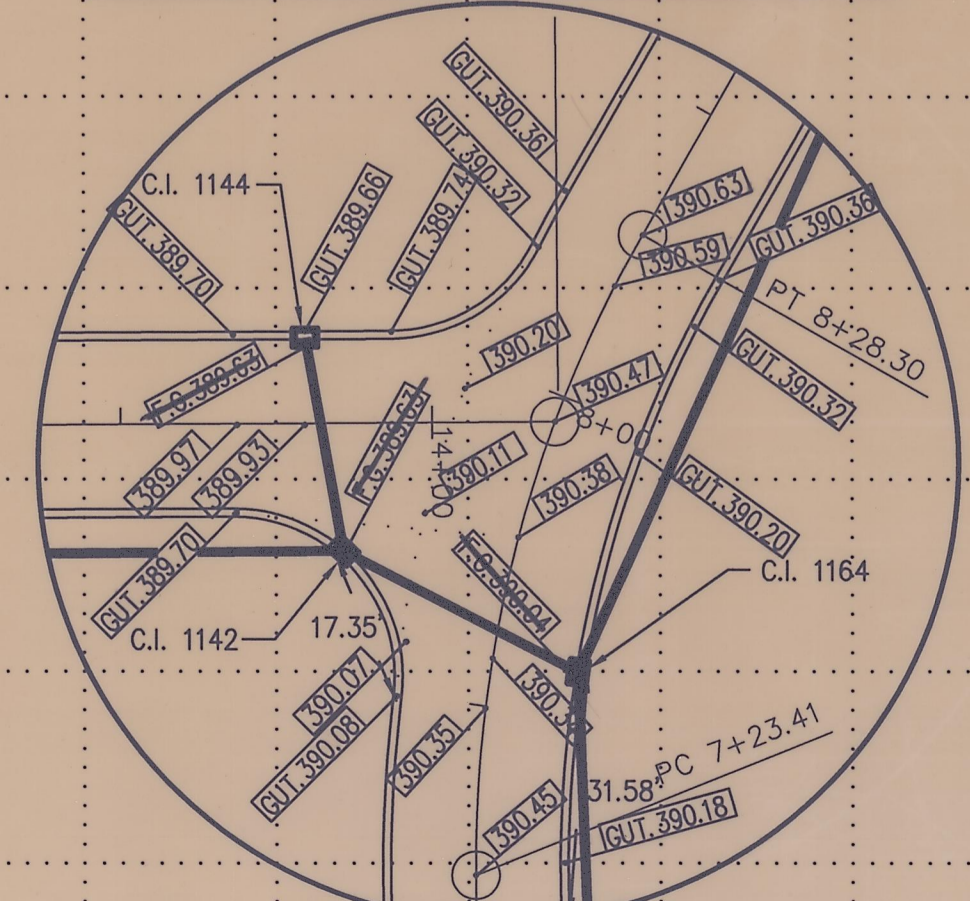

SCALE: 1" = 30'  
 DISTANCE IN CORNERS ARE FROM PC TO BACK OF CURB  
**CONTI DRIVE - SOUTHPORT DRIVE**

**Morley and Associates, INC.**  
 Consulting Engineers/Surveyors/Architects  
 605 S.E. Martin Luther King Jr. Blvd.  
 Evansville, Indiana 47713  
 (812) 464-9585

All ideas, designs, calculations, and arrangements indicated on this drawing are the property of Morley and Associates, Inc. and were created for the use on and in connection with the specified project. None of such ideas, designs, calculations, or arrangements shall be used by or disclosed to any other party without the written permission of Morley and Associates, Inc.  
 Written dimensions on these drawings shall have precedence over all dimensions and conditions on the job and Morley and Associates, Inc. must be notified of any variations from the dimensions and conditions shown by these drawings.

No.	By	Date	Description
1	JEM	4/14/97	Revise road grades and sewer elevations.
2	JEM	5/21/98	STORM SEWER AS BUILT'S

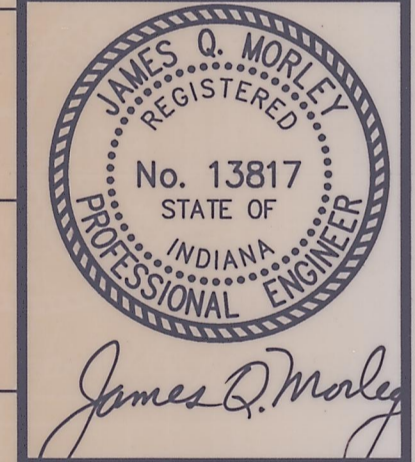

Project: Clear Creek Village - Section 1  
 Sheet Title: Conti Drive Plan and Profile  
 Sheet Number: 7  
 Hor. Scale: 1" = 50'  
 Ver. Scale: 1" = 5'  
 Designed By: JEM  
 Drawn By: G.A.H.  
 Checked By: JEM  
 Date: 09-27-96  
 Filename: RCP01003.DWG