

Existing Legend

- ⊕ B. Pipe Bolland
- Cap. Capacitor
- Gen. Generator
- DEB Electric Box (Transformer)
- LP Light Pole
- ⊕ TJ Underground Telephone Junction Box
- o GV Gas Valve
- o WV Water Valve
- o WM Water Meter
- o SM Storm Sewer Manhole
- o SMH Sanitary Sewer Manhole
- ⊕ FH Fire Hydrant
- ⊕ AD Area Drain
- ⊕ CI Curb Inlet
- o V Irrigation Valve
- UT Underground Telephone
- UE Underground Electric
- UW Underground Water
- UG Underground Gas
- F Fence
- CL Center Line
- PBL Property Boundary Line
- E Esasement Line
- RL Right-of-way Line
- POC Point Of Commencement
- POB Point Of Beginning
- (R) Record Dimension
- (M) Measured Dimension
- (C) Calculated Dimension
- LS Landscaping
- XX Zoning
- ⊕ Title Exception
- ⊕ Surveyor's Report Reference

Proposed Legend

- ▬ Proposed Heavy Duty Asphalt Pavement
- Wheel Stop
- ⊗ Parking Count
- XXX Spot Elevation
- ME: Match Existing
- EC: Edge of Concrete
- Gut: Gutter
- TC: Top of Curb
- 380 Proposed Contour
- ➔ Swale and Flow Direction

General Notes:

1. Contractor and materials shall comply with all local, state and federal codes, ordinances, rules, regulations, orders and other legal requirements of municipal authorities which bear on the performance of the work.
2. The contractor is cautioned that the location, elevation, size and/or material type of existing utilities as shown on these plans is based on records of various utility companies and, where possible, measurements taken in the field. The information is not to be relied on as being exact or complete. The contractor is responsible for the accurate location elevation, size and/or material type of all utilities and hazards whether shown or not. The contractor must contact the appropriate utility company at least 48 hours before any excavation to request exact field location elevation, size and/or material type of utilities. Indiana Underground Utility Locate Service Phone: 811
3. Material and installation specifications shall be in conformance with applicable portions of the INDOT Standard Specifications, (latest edition), memorandums and supplements unless specifically stated otherwise on these plans, contract documents or local code.
4. The contractor shall repair and/or replace all existing utilities damaged as a result of this project.
5. The contractor shall be responsible for notifying all occupants of interruption to their utilities that will be caused by this project.
6. The contractor shall maintain the road right-of-way which has been disturbed. Maintenance shall meet the approval of the governing engineer.
7. The Contractor shall verify all measurements and be responsible for any mistakes they may make as a result. If the Contractor discovers any discrepancy in figures on the drawings, he/she shall report same to the engineer before proceeding with any work affected by the discrepancy, and shall be held responsible for results should he/she fail to make such report.
8. Preferred minimum pavement slope = 0.5% flow.
9. All surfaces shall be graded to drain.
10. Local, state, and national laws and guidelines shall take precedence over design information if in conflict. Contractor shall inform client and Morley in writing if any conflicts arise.

Site Summary

- Proposed Use = Parking Lot
- Current Zoning Classification = M2
- Proposed Parking Spaces = 18 spaces
- Proposed Impervious Area = 16,675 SF

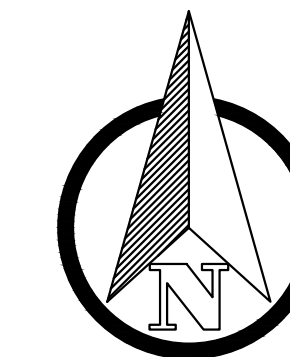

SCALE 1" = 20'

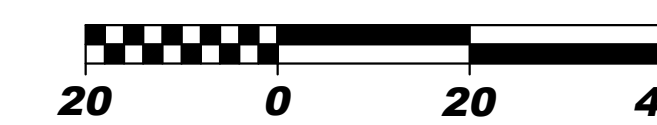

General Grading and Drainage Notes:

1. All maximum earthwork graded slopes is 3:1 unless otherwise noted on plans.
2. Minimum pavement slope = 0.5%.
3. All surfaces shall be graded to drain.
4. Local, state, and national laws and guidelines shall take precedence over design information if in conflict. Contractor shall inform client and Morley and Associates, Inc. in writing if any conflicts arise.
5. Slope grades to direct water away from buildings and prevent ponding.
6. All areas of new facilities shall comply with the Americans with Disabilities Act (ADA) Accessibility Guidelines.
7. All disturbed areas to be seeded and mulched.

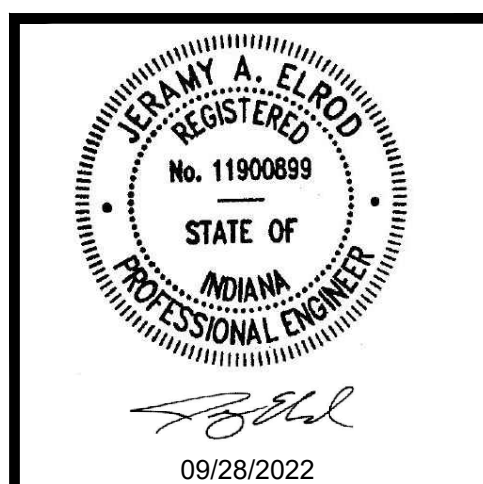
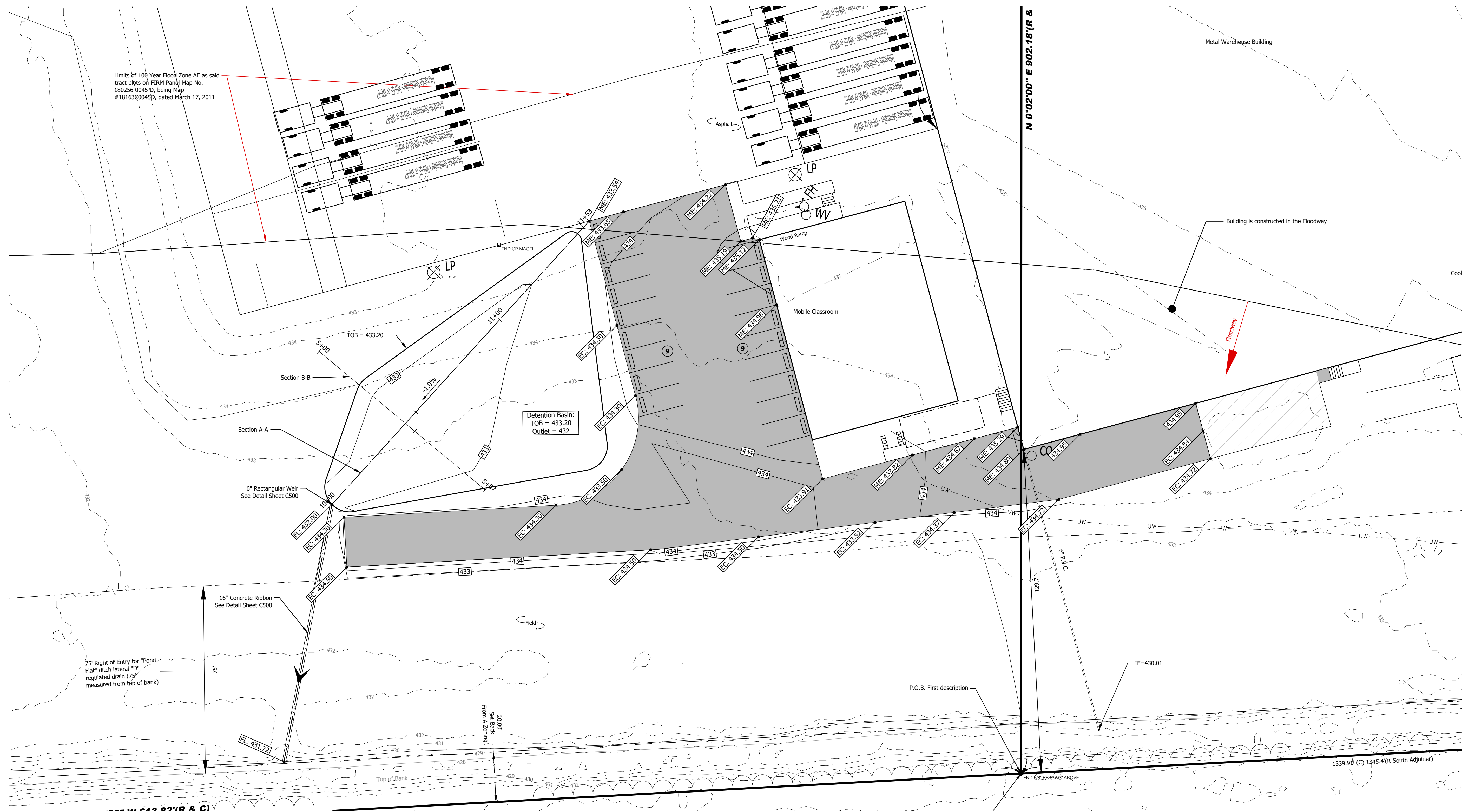

All ideas, designs, calculations, and arrangements indicated or represented by this drawing are owned by and are the property of Morley and Associates, Inc. and were created as instruments of service for use on and in connection with the specified project. Morley and Associates retains all common law, statutory law and other rights, including copyrights. No drawings or electronic files shall be reused for any purpose other than the project. They shall not be disclosed to or be used by any other person or firm without the written prior consent of Morley and Associates, Inc.

Written dimensions on these drawings shall have precedence over scale dimensions. Contractors shall verify and be responsible for all dimensions and conditions on the job and Morley and Associates, Inc. must be notified of any variations from the dimensions and conditions shown by these drawings.

If differences exist between electronic files and the signed and sealed hard copy drawings, the hard copy shall govern.

4800 Rosebud Ln., Westlough, IN 47330
812.464.9565 Phone 812.464.2514 Fax
morleycorp.com

Ameriquel Group, LLC
18200 Highway 41 North
Evansville, IN

Civil
Grading Plan

No.	By	Date
Revisions		
Scale: 1" = 20'		
Designed By:	JAE	Job Number: 7296.1.003-B
Drawn By:	AN	Date: 09/28/2022

Filename: 7296 Civil Base
Sheet Number:

C203