

Scholz & Nolan's Subdivision

of Lots No 6, 7, 8, and 9 in Block No 1, and Lots No 1, 2, 3, 4, and 5 in Block No 2 of Scholz & Nolan's Enlargement, an Addition to the City of Evansville

Waverley Land Co
by Chas J Scholz Pres't
John J Nolan Secy

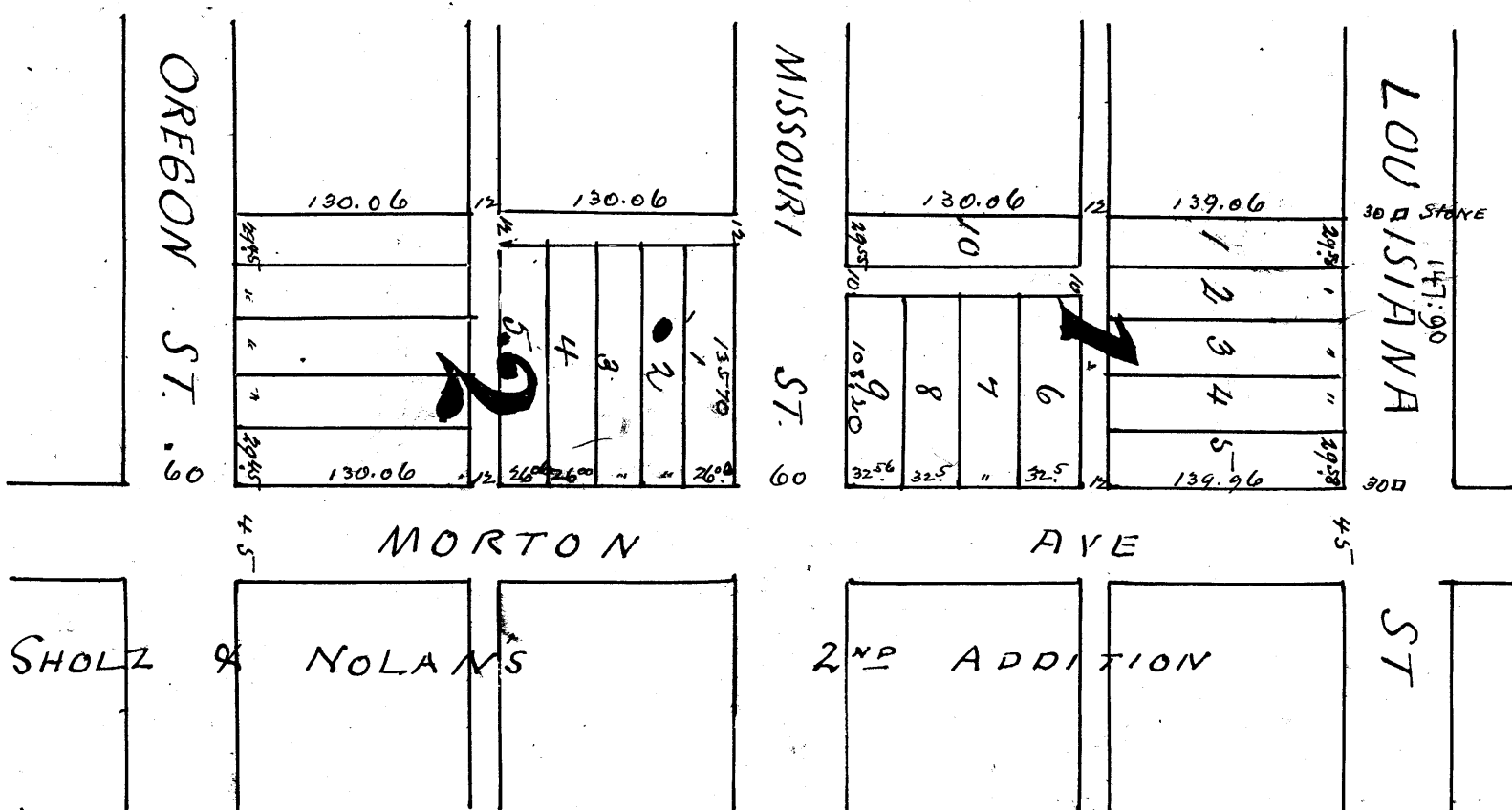
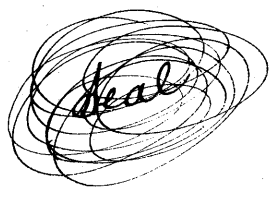

State of Indiana
Madisonburg Co 3⁶⁸

Board of Public Works
July 5, 1913
Evansville Ind.
J. E. Stickelmaier
J. G. Pickwood
Edward Schmitt

Before me the undersigned Notary Public in and said County and State personally appeared the within named Waverley Land Co by Chas J Scholz Pres't and John J Nolan Secy and acknowledged the execution of this plat
Witness my hand and notarial Seal this 3^d day of July 1913
My Commission expires Aug. 26, 1914



L. A. Althoff
Notary Public

Recorded July 21, 1913

[Signature] N.P.C.