

# Hollywood

an addition to the Town of Howell as laid out by Rosina Striebel proprietor thereof, described as follows: Beginning at a point 290.4 ft east and 588 ft north of the south west corner of the North west Quarter of Section 35, Township 6 South of Range 11 West thence north 678.4 ft thence East 407.9 along south line of Mt Vernon Road thence South 709.1 thence west to place of beginning

Rosina Striebel

State of Indiana  
Pauperburgh Co

Before me a Notary Public in and for said Co. personally appeared Rosina Striebel and acknowledged the execution of this plat this 9th day of September 1914.

Witness my hand and notarial seal this day and date above written

Edmund L Craig

Notary Public

My Commission Expires Nov 15 1916

Be it resolved by the Board of Trustees of the Town of Howell:

That the Plat for Hollywood addition to the Town of Howell filed with the Town Clerk on the 14th day of September, 1914, by Rosina Striebel is hereby approved and our consent is hereby given that it may be duly recorded.

This the 14th day of September 1914

W L Walden

Attorney

John O Wilder

Narry K Clark  
Clerk of Howell

Recorded Sept 16: 1914

*[Signature]*

(For Modification of Restrictions of this plat. see Misc. Record "M" page 541.)

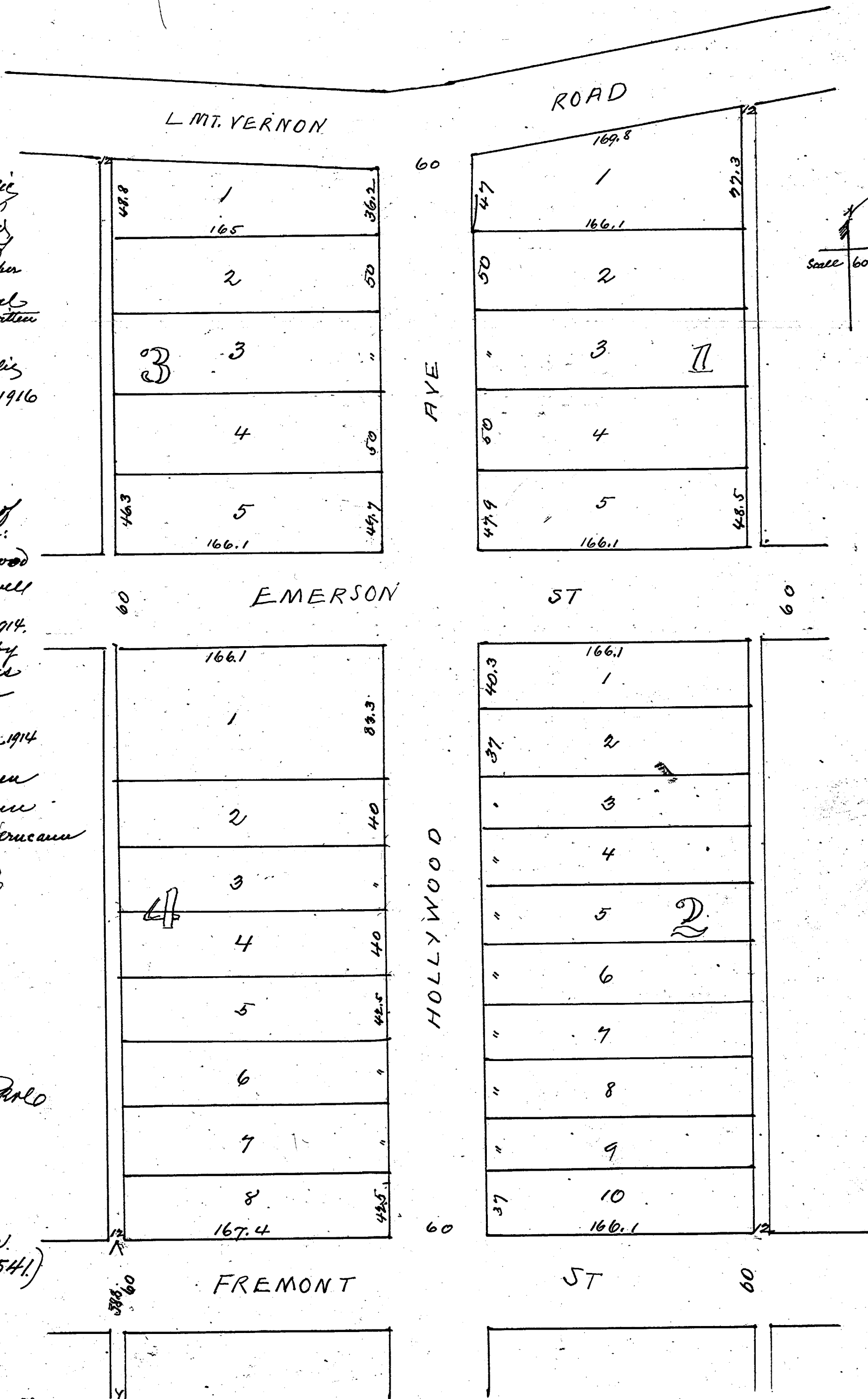

290.4  
Stone  
SW Cor  
NW Quarter  
Sec 35, 6, 11