

#9334

HIGHLAND PLACE ---BLOCK A and B.

Being a re-plat of Blocks Five(5), Nine (9), Ten (10), and Eleven(11) in HIGHLAND PLACE, An addition to the City of Evansville, excepting however Lots Six (6) and Seven (7), in Block Nine(9), and Lot Twenty-one(21) in Block Ten (10), which are not included in this plat.

The property included in this plat is located in the City of Evansville, Indiana, and described and bounded as follows:

Beginning at a point on the west line of First Ave., at the southeast corner of Lot Twenty-one (21) in Block Ten (10) of Highland Place Addition; thence west 140.2 feet; thence north 25 feet, to the south line of an alley; thence west on the south line of said alley 643.95 feet to the east line of Third Ave; thence south on said east line of Third Ave. 300 feet to the north line of an alley; thence east on said alley line 631.65 feet; thence north 45 degrees East; along an alley line, 14.14 feet to the west line of an intersecting alley; thence north along said alley line 50 feet to the north line of an intersecting alley; thence east along said alley line 140.2 feet to the west line of First Ave; thence north 215.0 feet to the place of beginning.

Said parcel of real estate includes all of said Blocks Five (5), Nine (9), Ten (10) and Eleven (11) in Highland Place, an addition to the City of Evansville as originally platted, excepting said lots Six (6), Seven (7) and the south ten (10) feet of lot Eight (8) in Block Nine (9), and excepting also lot Twenty-one (21) in Block Ten (10); and said platted real estate also includes all vacated streets and alleys included within the above boundaries.

Said parcel of real estate is divided into Two (2) blocks, marked respectively "Block A" and Block B", which are of the dimensions as shown on said plat.

This plat is made by Klammer Furniture Corporation and Evansville Desk Company, the owners of said above described real estate; said Klammer Furniture Corporation being the owner of that part of said parcel included in "Block A", and said Evansville Desk Company being the owner of that part of said parcel included in "Block B".

Signed this 2nd day of December 1932.

KLAMER FURNITURE CORPORATION  
By H.W.Goebel Sec'y & Tr.

EVANSVILLE DESK COMPANY  
By William M. Elles, President.

CITY ZONING CLASSIFICATION

All private property included within this plat is classified under the Evansville Zone Ordinance in the following districts;

- "E" heavy Industrial Use District
- "E" Height & Area

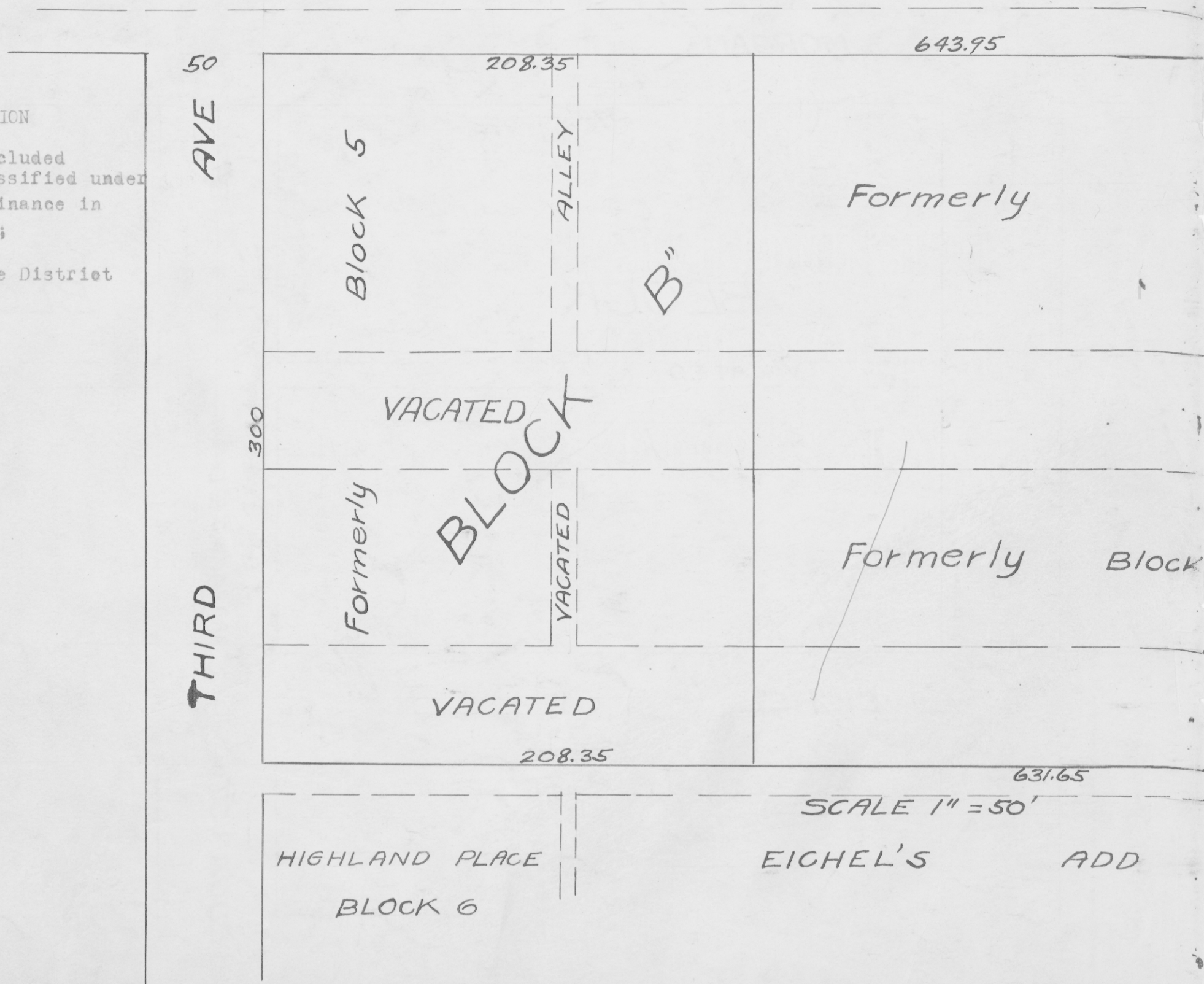

HIGHLAND PLACE  
BLOCK 6

SCALE 1" = 50'  
EICHEL'S ADD