

FOR APPROVAL
DATE _____ BY _____

MAR 05 1998

Red Bank Road

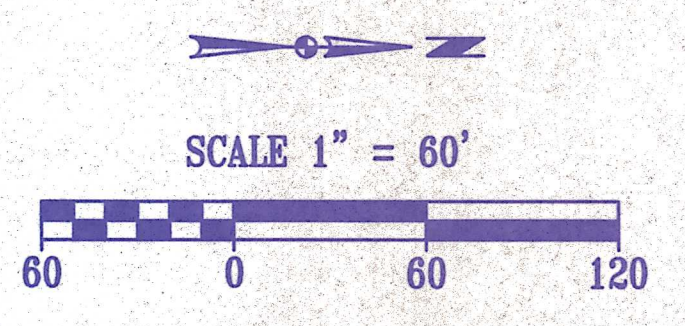

7.44± Acres Tract
LIMITS OF 100 YEAR FLOOD - ZONE A
SCALED FROM FIRM MAP
COMMUNITY PANEL 180256 0100 B
DATED MARCH 19, 1982

Morley and Associates, Inc.
Consulting Engineers/Surveyors/Architects
605 S.E. Martin Luther King Jr. Blvd.
Evansville, Indiana, 47713
(812) 464-9585

All design, calculations, and measurements indicated or represented by this drawing are owned by and the property of Morley and Associates, Inc. and were created for the use and in connection with the specified project. None of such items, in whole or in part, may be copied, reproduced, or otherwise used without the written permission of Morley and Associates, Inc. Written dimensions on these drawings shall have precedence over all dimensions and conditions on this job and Morley and Associates, Inc. must be notified of any variations from the dimensions and conditions shown by these drawings.

No.	By	Date	Description

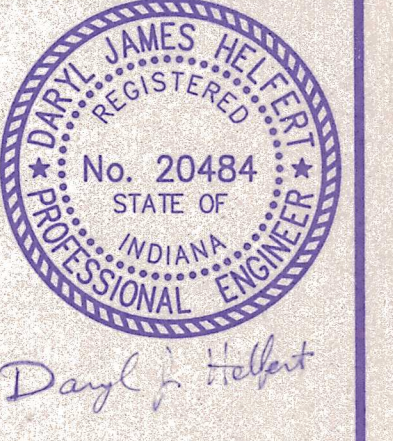

Project: **Winstead Place Subdivision**
Sheet Title: **Drainage Plan**
Scale: 1" = 60'
Designed By: D.J.H. Job Number: 97-3724-1
Drawn By: J.E.M. Date: 2/18/98
Checked By: D.J.H. Filename: 3724BASE.DWG
Sheet Number: **3** of 12

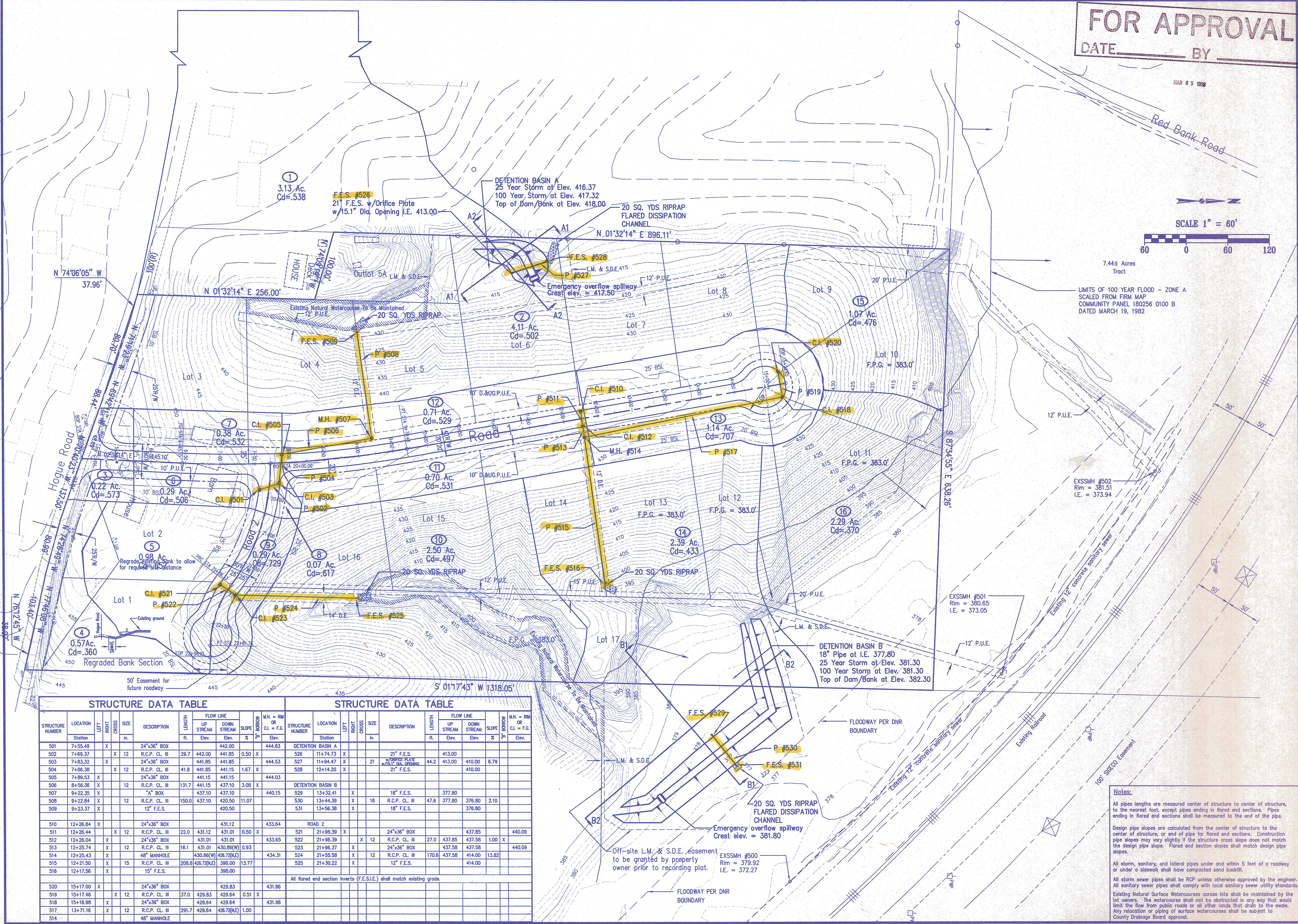

STRUCTURE DATA TABLE										STRUCTURE DATA TABLE										
STRUCTURE NUMBER	LOCATION Station	LEFT RIGHT CROSS	SIZE In.	DESCRIPTION	FLOW LINE			M.H. OR CL. = F.G. Elev.	STRUCTURE NUMBER	LOCATION Station	LEFT RIGHT CROSS	SIZE In.	DESCRIPTION	FLOW LINE			M.H. OR CL. = F.G. Elev.			
					LENGTH	UP STREAM Elev.	DOWN STREAM Elev.							SLOPE %	LENGTH	UP STREAM Elev.		DOWN STREAM Elev.	SLOPE %	
501	7+55.49	X	24"x36" BOX		442.00			444.83	526	11+74.73	X	21"	F.E.S.	413.00				413.00		
502	7+69.37	X	12" R.C.P. CL. III	29.7	442.00	441.85	0.50	X	527	11+94.47	X	21"	R.C.P. CL. III	410.00	6.79			410.00		
503	7+83.32	X	24"x36" BOX		441.85			444.53	528	12+14.20	X	21"	F.E.S.	410.00				410.00		
504	7+96.38	X	12" R.C.P. CL. III	41.8	441.85	441.15	1.67	X	444.03											
505	7+89.53	X	24"x36" BOX		441.15			440.15	529	13+32.41	X	18"	F.E.S.	377.80				377.80		
506	8+56.36	X	12" R.C.P. CL. III	131.7	441.15	437.10	3.08	X	530	13+44.39	X	18"	R.C.P. CL. III	376.80	2.10			376.80		
507	9+22.35	X	"A" BOX		437.10			440.15	531	13+56.38	X	18"	F.E.S.	376.80				376.80		
508	9+22.84	X	12" R.C.P. CL. III	150.0	437.10	420.50	11.07	X												
509	9+23.57	X	12" F.E.S.		420.50															
510	12+26.84	X	24"x36" BOX		431.12			433.64	521	21+98.39	X	24"x36" BOX		437.85				440.09		
511	12+26.44	X	12" R.C.P. CL. III	22.0	431.12	431.01	0.50	X	522	21+98.39	X	12" R.C.P. CL. III	27.0	437.85	437.58	1.00	X	440.09		
512	12+26.04	X	24"x36" BOX		431.01			433.65	523	21+96.37	X	24"x36" BOX		437.58				440.09		
513	12+25.74	X	12" R.C.P. CL. III	16.1	431.01	430.86(W)	0.93	X	524	21+55.58	X	12" R.C.P. CL. III	170.6	437.58	414.00	13.82				
514	12+25.43	X	48" MANHOLE		430.86(W)	428.72(N)		434.31	525	21+30.22	X	12" F.E.S.		414.00						
515	12+21.50	X	15" R.C.P. CL. III	208.6	428.72(N)	398.00	13.77	X												
516	12+17.56	X	15" F.E.S.		398.00															
520	15+17.00	X	24"x36" BOX		429.83			431.96												
519	15+17.46	X	12" R.C.P. CL. III	37.0	429.83	429.64	0.51	X												
518	15+16.98	X	24"x36" BOX		429.64			431.96												
517	13+71.16	X	12" R.C.P. CL. III	291.7	429.64	428.72(N)	1.00	X												
514		X	48" MANHOLE		428.72(N)															

All flared end section inverts (F.E.S.I.E.) shall match existing grade.

Notes:
All pipes lengths are measured center of structure to center of structure, to the nearest foot, except pipes ending in flared end sections. Pipes ending in flared end sections shall be measured to the end of the pipe.
Design pipe slopes are calculated from the center of structure to the center of structure, or end of pipe for flared end sections. Construction pipe slopes may vary slightly if the structure cross slope does not match the design pipe slope. Flared end section slopes shall match design pipe slopes.
All storm, sanitary, and lateral pipes under and within 5 feet of a roadway or under a sidewalk shall have compacted sand backfill.
All storm sewer pipes shall be ROP unless otherwise approved by the engineer. All sanitary sewer pipes shall comply with local sanitary sewer utility standards.
Existing Natural Surface Watercourses across lots shall be maintained by the lot owners. The watercourse shall not be obstructed in any way that would limit the flow from public roads or all other lands that drain to the swale. Any relocation or piping of surface watercourses shall be subject to County Drainage Board approval.