

LEGEND

- PROPERTY LINE
- PROPOSED BUILDING
- FUTURE BUILDING EXPANSION
- EXISTING BUILDING
- PROPOSED CURB AND GUTTER
- PROP. MISC WALKS, PADS, ECT.
- FUTURE CURB AND GUTTER
- PAINTED ISLAND
- CURB ISLAND
- HANDI-CAPPED PARKING SPACE
- VAN ACCESSIBLE
- NEW OR RELOCATED LIGHTING
- HEAVY DUTY PAVEMENT
- STANDARD DUTY PAVEMENT
- CONCRETE PAVEMENT

- GENERAL NOTES**
- ALL WORK SHALL BE DONE IN ACCORDANCE WITH THE PLANS AND SITE WORK SPECIFICATIONS.
 - ALL NECESSARY PERMITS AND APPROVALS FROM AGENCIES GOVERNING THIS WORK SHALL BE SECURED PRIOR TO BEGINNING CONSTRUCTION.
 - CONTRACTOR IS RESPONSIBLE FOR PROTECTION OF ALL PROPERTY CORNERS AND SHALL REPLACE ALL PINS DAMAGED DURING CONSTRUCTION.
 - REFERENCE ARCHITECT'S PLANS FOR BUILDING DIMENSIONS, TRUCK DOCKS, SIDEWALKS, DUMPSTER PADS, STEPS, TRANSFORMER PADS, ECT.
 - ALL DIMENSION SHOWN TO BUILDING ARE TO OUTSIDE FACE OF BUILDING.
 - CONTRACTOR SHALL REFER TO ARCHITECT'S PLANS AND SPECIFICATIONS FOR ACTUAL LOCATION OF ALL UTILITY ENTRANCES TO INCLUDE SANITARY SEWER LATERALS, DOMESTIC AND FIRE PROTECTION WATER SERVICE, ELECTRICAL, TELEPHONE AND GAS SERVICE. CONTRACTOR SHALL COORDINATE INSTALLATION OF UTILITIES IN SUCH A MANNER TO AVOID CONFLICTS AND ASSURE PROPER DEPTHS ARE ACHIEVED AS WELL AS COORDINATING WITH THE REGULATORY AGENCY AS TO LOCATION AND SCHEDULING OF TIE-INS/CONNECTIONS TO THEIR FACILITIES.
 - EXISTING UTILITY LINES SHOWN ARE APPROXIMATE LOCATIONS ONLY. THE CONTRACTOR SHALL FIELD VERIFY ALL EXISTING UTILITY LINE LOCATIONS AND ELEVATIONS PRIOR TO ANY CONSTRUCTION. ANY DEVIATIONS FROM THE DESIGN LOCATIONS SHALL BE REPORTED TO THE OWNER OR ENGINEER PRIOR TO CONSTRUCTION.
 - THE SITE WORK CONTRACTOR SHALL COORDINATE THE INSTALLATION OF ALL UNDERGROUND UTILITIES WITH HIS WORK. ALL UNDERGROUND UTILITIES (WATER, SANITARY SEWER, STORM SEWER ELECTRICAL) SHALL BE IN-PLACE PRIOR TO THE PLACEMENT OF BASE COURSE MATERIAL.
 - CONTRACTOR IS RESPONSIBLE FOR PROTECTING EXISTING BENCHMARK AND RELOCATION BENCHMARK IF NECESSARY. BENCHMARK SHALL BE RELOCATED TO ORIGINAL ELEVATION. PROPERTY AND TOPOGRAPHIC SURVEY FROM RECORD DRAWING PREPARED BY MORLEY ASSOCIATES, EVANSVILLE, IN.
 - THE SITE WORK SHALL MEET OR EXCEED THE WAL-MART SITE WORK SPECIFICATIONS.

- SITE LAYOUT NOTES**
- CONTRACTOR SHALL MATCH EXISTING CURB AND GUTTER IN GRADE, TYPE AND ALIGNMENT.
 - DIMENSIONS TO CURB AND GUTTER INDICATE EDGE OF PAVEMENT UNLESS OTHERWISE NOTED.
 - SEE DRAWING C5 FOR DETAILS.

- SITE LIGHTING NOTES**
- ALL PARKING LOT LIGHTING POLES AND FIXTURES WITH LAMP AND REQUIRED PAINT WILL BE PROVIDED BY WAL-MART AND INSTALLED BY THE SITE CONTRACTOR. THE CONTRACTOR SHALL SUPPLY WAL-MART WITH A ONE YEAR WARRANTY CERTIFICATE. ALL INCURRED COSTS FOR RECEIVING, STORAGE, LIABILITY AND WARRANTY LABOR SHALL BE INCLUDED IN THE INSTALLATION CONTRACT PRICE.
 - SITE LIGHTING CIRCUITRY, PHOTOMETRICS AND FOUNDATION DESIGN PROVIDED BY WAL-MART STORES, INC.
 - LIGHT POLES TO BE RELOCATED SHALL BE REMOVED AND STOCK PILED ON SITE FOR REUSE.

SITE SUMMARY

LOCATION	
EVANSVILLE, INDIANA	STATE ROAD No. 62
BEFORE EXPANSION WAL-MART TAX PLAT AREA ONLY	
PROPERTY	WAL-MART TAX PLAT 9.4 ac.
BUILDING	
TOTAL	91,652s. f.
BASE BLDG.	81,922s. f.
PARKING	
491 spaces	6.0/1000s. f.
AFTER EXPANSION WAL-MART TAX PLAT AREA ONLY	
PROPERTY	WAL-MART TAX PLAT 11.3 ac.
BUILDING	
PROTOTYPE	TOTAL 119,021s. f.
BASE BLDG.	104,368s. f.
PARKING	
571 spaces	5.5/1000s. f.

Partnership Engineering

JAN 11 1994

PRINTED & ISSUED

FOR APPROVAL

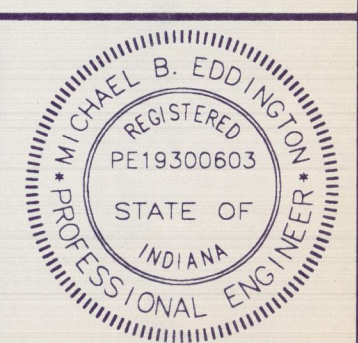
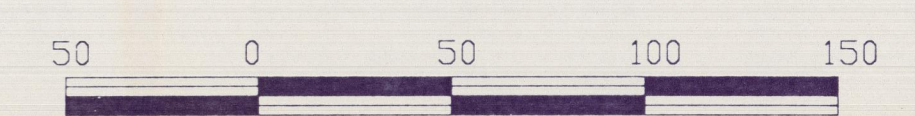

SITE PLAN

WAL-MART EXPANSION
EVANSVILLE, INDIANA
FOR
WAL-MART STORES, INC.
BENTONVILLE, ARKANSAS

PROJ: W9308N
SCALE: DATE: 01-06-94
DRAWN: CHECKED: K.W.
M.D.E.
C1-R0

APPROVAL CHECKLIST

Agency	Avail. Letters	Date Submitted	Date Approved
Indiana Dept. of Environ. Mgt.			
Water			
Sanitary Sewer			
Indiana Dept. of Fire Prevention			
Expansive Water and Sewer			
Sanitary Sewer			
Water			
Water and Sewer Utility Board			
City / County "One Stop Permit" Approvals		1-4-94	
Arcad Plan Commission			
Zoning Enforcement			
Building Commissioner			
Evansville Urban Transportation			
County Drainage Engineer			
Southern Ind. Gas and Electric			
Electric			
Gas			
Indiana Bell			
NPDES notification (ASAP)			
Water Flow Tests conducted on:		1-5-94	
Plans to BSW on:			
revised: 01-07-94			

NO.	TYPE	QTY.	CATALOG NUMBER	DESCRIPTION/LAMP
1	AV		WGDH-194VS-480-400MH-BLP	4-WAY (MS 400 BUJ)
2	AV-WOD	2	WGDH-193VS-17M-J-480-400-MH-BLP	4-WAY (3 MS 400 BUJ) (1 MS 400 HOR)
3	BV-E	1	WGDH-193VS-480-400MH-BLP	3-WAY (MS 400 BUJ)
4	BV	1	WGDH-192VS-480-400MH-BLP	2-WAY (MS 400 BUJ)
5	CV	1	WGDH-191VS-480-400MH-BLP	1-WAY (MS 400 BUJ)
6	D	1	WGDH-197FM-480-400MH-BLP	1-WAY (MS 400 HOR)
7	E	1	WGDH-192-480-400MH-BLP	2-WAY (MS 400 HOR)
8	F	1	WGDH-191-480-400MH-BLP	1-WAY (MS 400 HOR)
9	G	1	WGDH-193-480-400MH-BLP	1-WAY (MS 400 HOR)
10	H	1	WGDH-1923-480-400MH-BLP	2-WAY (MS 400 HOR)
11	J-WOD	2	WGDH-1923-480-400MH-BLP	2-WAY (MS 400 HOR)
12	XV	1	WGDH-284VS-480-1000MH-BLP	4-WAY (MS 1000 BUJ)
13	AV-XV	1	WGD-785-39-11-DM-PP	3P POLE STEEL
14	AV-WOD	1	GALLON BLACK PAINT	PAINT
15		1	MS-400 HOR	HORIZONTAL LAMP
16		1	MS-400 BUJ	VERTICAL LAMP
17		1	WGD-31P	STEEL POLE TOP FITTER

NO.	REVISIONS	BY	DATE

Partnership Engineering
Consulting Engineers

MICHIGAN OFFICE: 2080 Knaprock Ave, Grand Rapids, Michigan (616) 363-4775 49505

ALABAMA OFFICE: 7880 Columbus Rd, Birmingham, Alabama (205) 823-9500 35216

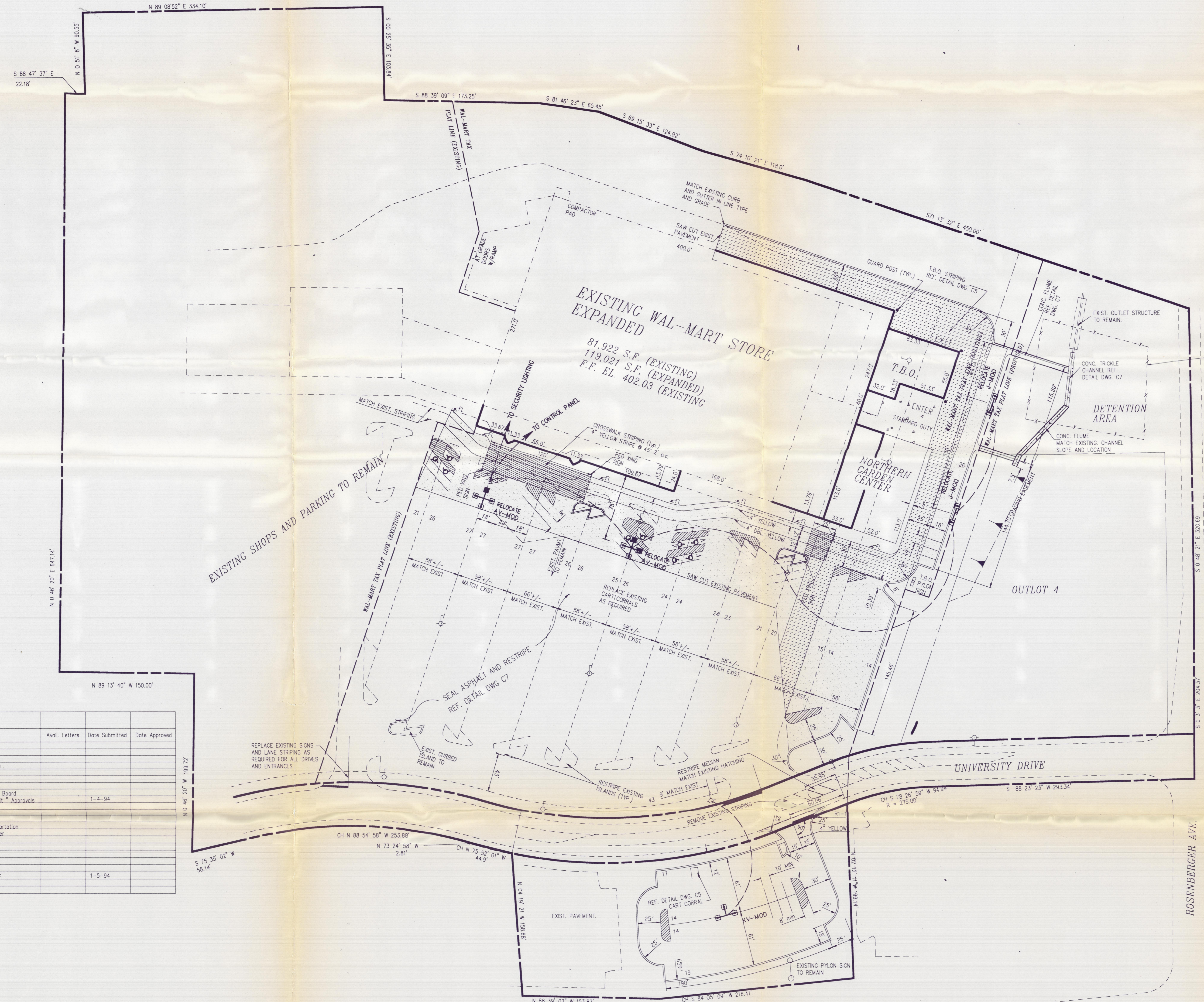

FILE NAME: W9308N