

Sanitary Line A Alignment Profile

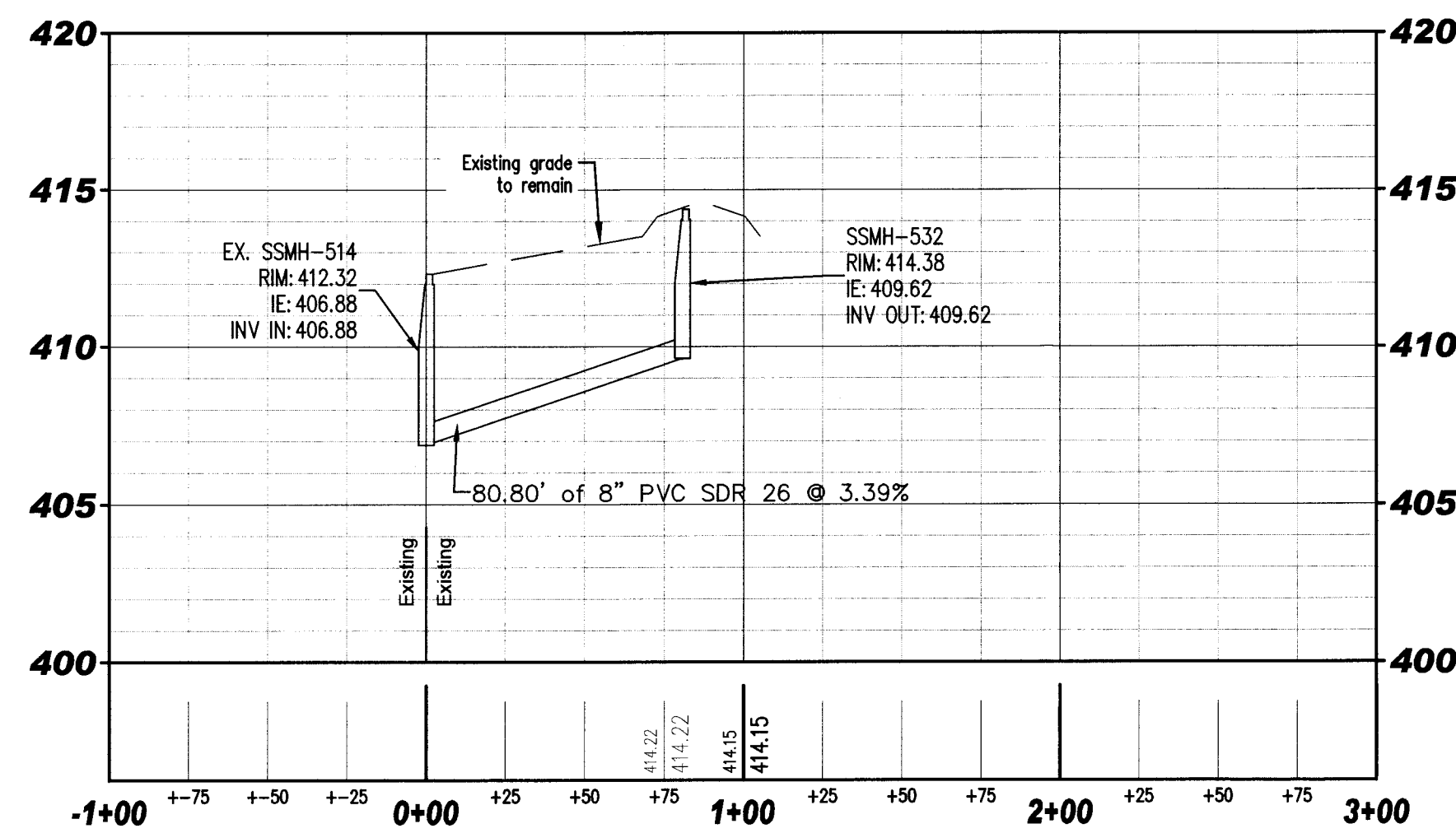

Sanitary Line B Alignment Profile

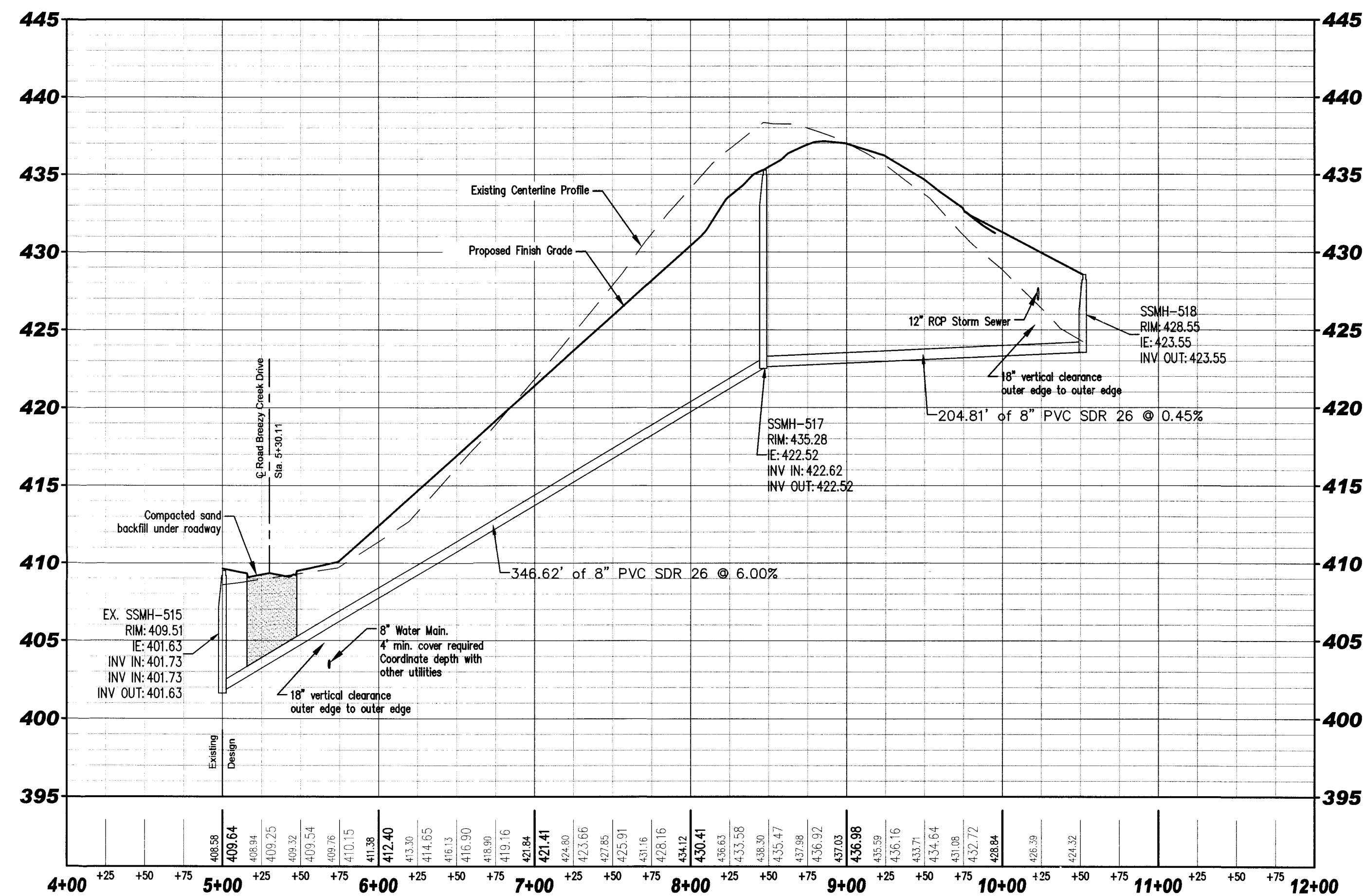

Sanitary Line C Alignment Profile

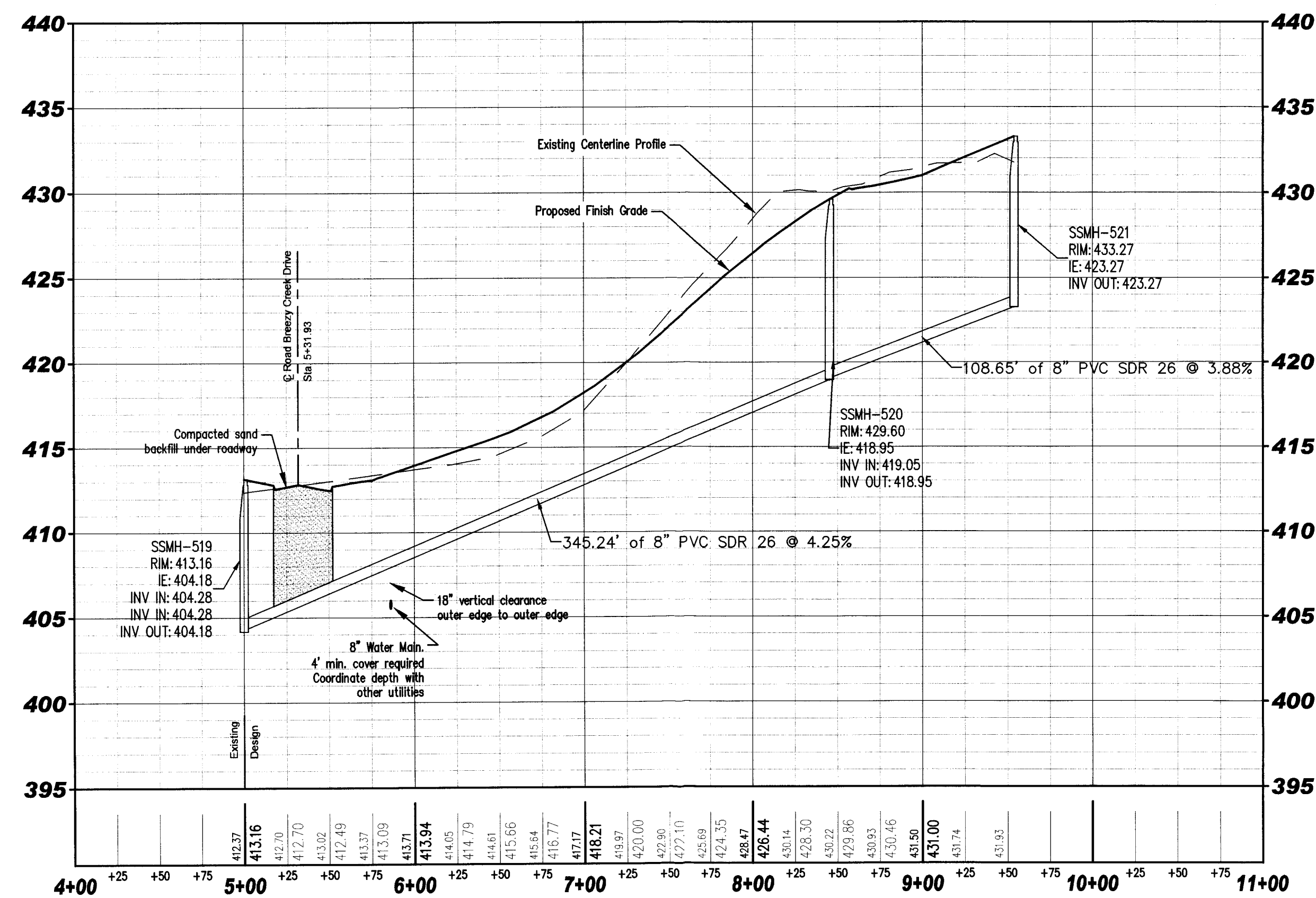

**Sanitary Sewer General Notes:**

- Any lateral pipes with less than 3 foot of cover above the top of pipe shall be Ductile Iron Pipe Class 52 within the public utility easements and right-of-ways. Ductile Iron Pipe Cement Lined Class 52 shall conform with ANSI Specification A21-51-1976 and AWWA Specification C151-76, latest revisions. All Ductile Iron Pipe shall be bituminous coated outside in accordance with AWWA Specification C-151-76.
- The contractor is cautioned that the location and/or elevation of existing utilities as shown on these plans is based on records of various utility companies, and where possible measurements taken in the field. The information is not to be relied on as being exact or complete. The contractor must contact the appropriate utility company at least 48 hours before any excavation to request exact field location of utilities.  
Indiana Underground Utility Locate Service  
Phone: 811
- Any sanitary sewer trunk lines installed within non-virgin fill material shall be backfilled with engineered fill.
- All sanitary sewer pipes and laterals under and within 5 feet of a roadway or under a sidewalk shall have compacted sand backfill.
- Laterals shall be provided to all lots by contractor.
- Separation between water mains and sewer lines shall be 10' horizontally and 18" vertically measured from outside edge of pipe.
- Material specifications shall be in conformance with applicable portions of the INDOT standard specifications, (latest edition) unless specifically stated otherwise on these plans, contract documents or local code.
- All pipe lengths are measured center of structure to center of structure.
- Design pipe slopes are calculated from the center of structure to the center of structure.
- Contractor shall comply with all local, state and federal codes, ordinances, rules, regulations, orders and other legal requirements of municipal authorities which bear on the performance of the work.

**Sanitary Sewer Line Material List:**

4	452 LF	8" SDR-26 PVC Sanitary Sewer Main
3	236 LF	4" SDR-26 PVC Lateral
83		2" PVC Lateral Markers
16		48" Diameter Eccentric Manholes

The sanitary sewer line material list is not meant to be exhaustive of all necessary components for construction and should not be used as a complete "take-off" for bidding. Installation of all materials are to be in compliance with the most recent edition of the Evansville Water and Sewer Utility standards. Refer to sanitary sewer detail sheet for additional information.

**General Notes:**

- Contractor shall comply with all local, state and federal codes, ordinances, rules, regulations, orders and other legal requirements of municipal authorities which bear on the performance of the work.
- The contractor is cautioned that the location and/or elevation of existing utilities as shown on these plans is based on records of various utility companies, and where possible measurements taken in the field. The information is not to be relied on as being exact or complete. The contractor must contact the appropriate utility company at least 48 hours before any excavation to request exact field location of utilities.  
Indiana Underground Utility Locate Service  
Phone: 811
- Material specifications shall be in conformance with applicable portions of the INDOT standard specifications, (latest edition) unless specifically stated otherwise on these plans, contract documents or local code.
- Reinforced concrete pipe (Class III min.) and precast flared end sections with rubber gaskets shall meet the requirements ASTM C-76 and C-443. Rubber gaskets shall be "Grip Seal" as manufactured by Forsheda Pipe Seal Company or approved equal.

Engineering  
Surveying  
Architecture  
Construction Management



4809 Pleasant Lane  
Newburgh, IN 47250  
(812) 664-9585  
www.morleyandassociates.com

Revisions	Description	Date	By	No.

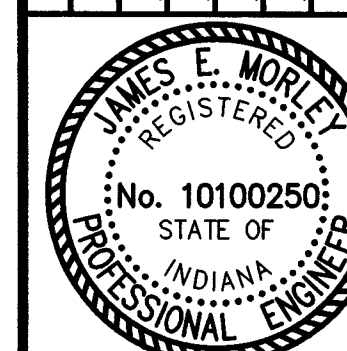

4-4-16

The Hills - Sterchi Homes Corporation  
**Sanitary Lines A, B, and C Plan and Profile**  
Evansville, Indiana

Scale: H: 1" = 50', V: 1" = 5'

Designed By: JEM Job Number: 5553.4.007-B  
Drawn By: ARK Date: 4/4/2016

Filename: J:\502a\5553-4\5553-4-01.dwg  
Sheet Number: C-114

RECEIVED BY THE  
VANDERBURGH COUNTY  
SURVEYORS' OFFICE  
4/5/16 BA