

Install Flap Guard on Structure 25 at time of pipe installation and prior to allowing Detention Basin 2 to accumulate storm runoff to prevent the risk of backflow into adjacent residential properties

100 Year Flood Contour = Elevation 384'

West side of Earthen Berm Drainage Grass Swale and west side Maintenance Path at 1% slope (Typical) with demising points as shown Draining toward Beehive Structures shown See typical Berm and Swale detail sheet 1.6

100 Year Flood Contour = Elevation 384'

Earthen Berm Buffer with Privacy Fence Max. slope 4 horz. to 1 vert. (Typical) Top of Berm at 7' above existing adjacent grade to the west plus 5' high fence with the west bank draining toward Beehive Structures shown - Buffer spans entire west property line - See detail sheet 1.6

SEE SHEET 15 FOR ENLARGED DRAINAGE PLAN THIS AREA

End Iron with Red Cap (Flush)

**LEGEND**

- 380 --- EXISTING GRADE
- 380 — PROPOSED GRADE
- + 385.45 EXISTING SPOT GRADE
- + 385.05 Rim PROPOSED SPOT GRADE
- H.P. SPOT GRADE HIGH POINT
- L.P. SPOT GRADE LOW POINT
- M.P. MAINTENANCE PATH GRADE
- F.L. SWALE FLOW LINE GRADE

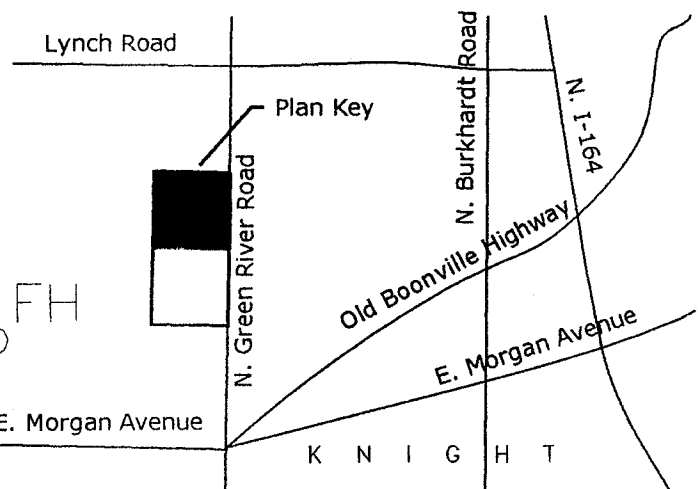

**KEY MAP**  
N.T.S.

NOTE: SEE SHEET 15 FOR ADDITIONAL NOTES AND SHEET 16 FOR DRAINAGE DETAILS. SEE ALSO SHEET 18 FOR EROSION CONTROL PLAN AS WELL AS 'CONSTRUCTION SITE STORMWATER RUNOFF CONTROL MANUAL' FOR MEASURE IMPLEMENTATION RELATIVE TO LAND DISTURBANCE FOR SCHEDULING RELATIVE TO DRAINAGE WORK.

**NORTH DRAINAGE PLAN**  
1" = 50'

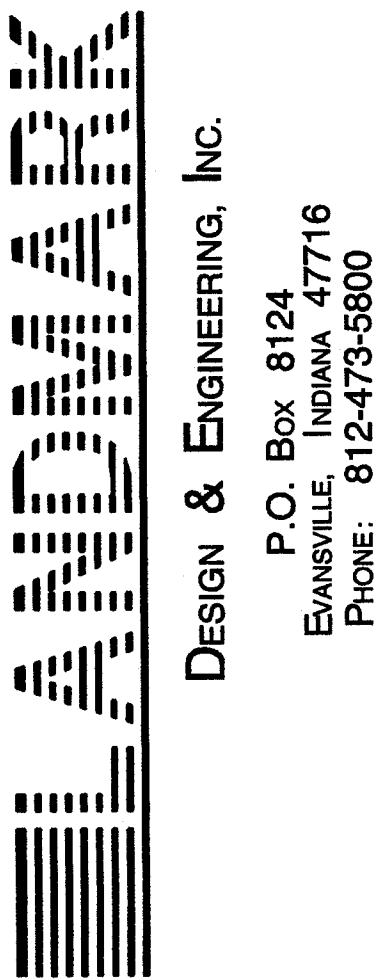

THIS DRAWING IN ITS ENTIRETY IS THE EXPLICIT PROPERTY OF LANDMARK DESIGN AND ENGINEERING, INC. ANY REPRODUCTION WITHOUT EXPRESS WRITTEN CONSENT OF AN AUTHORIZED REPRESENTATIVE OF LANDMARK DESIGN & ENGINEERING, INC. ANY DEVIATION IN WORD OR OMISSION FROM LATEST CODE REQUIREMENTS IS NOT INTENTIONAL AND SHALL NOT ALLEVIATE CONTRACTOR'S RESPONSIBILITY TO UPHOLD AND REQUIREMENTS. THIS PLAN IS NOT A PART OF ANY CONTRACT UNLESS SPECIFICALLY NOTED IN SAID CONTRACT.

REVISIONS	
NO.	DESCRIPTION

**NORTH DRAINAGE PLAN**  
**STONEFIELD CROSSING SUBDIVISION**  
2800 N. GREEN RIVER ROAD  
EVANSVILLE, INDIANA



DRAWN BY: DET DATE: 8-17-07

DRAWING NUMBER: **1.5N**