

**CROSS SECTION C-C**  
Scale: N.T.S.

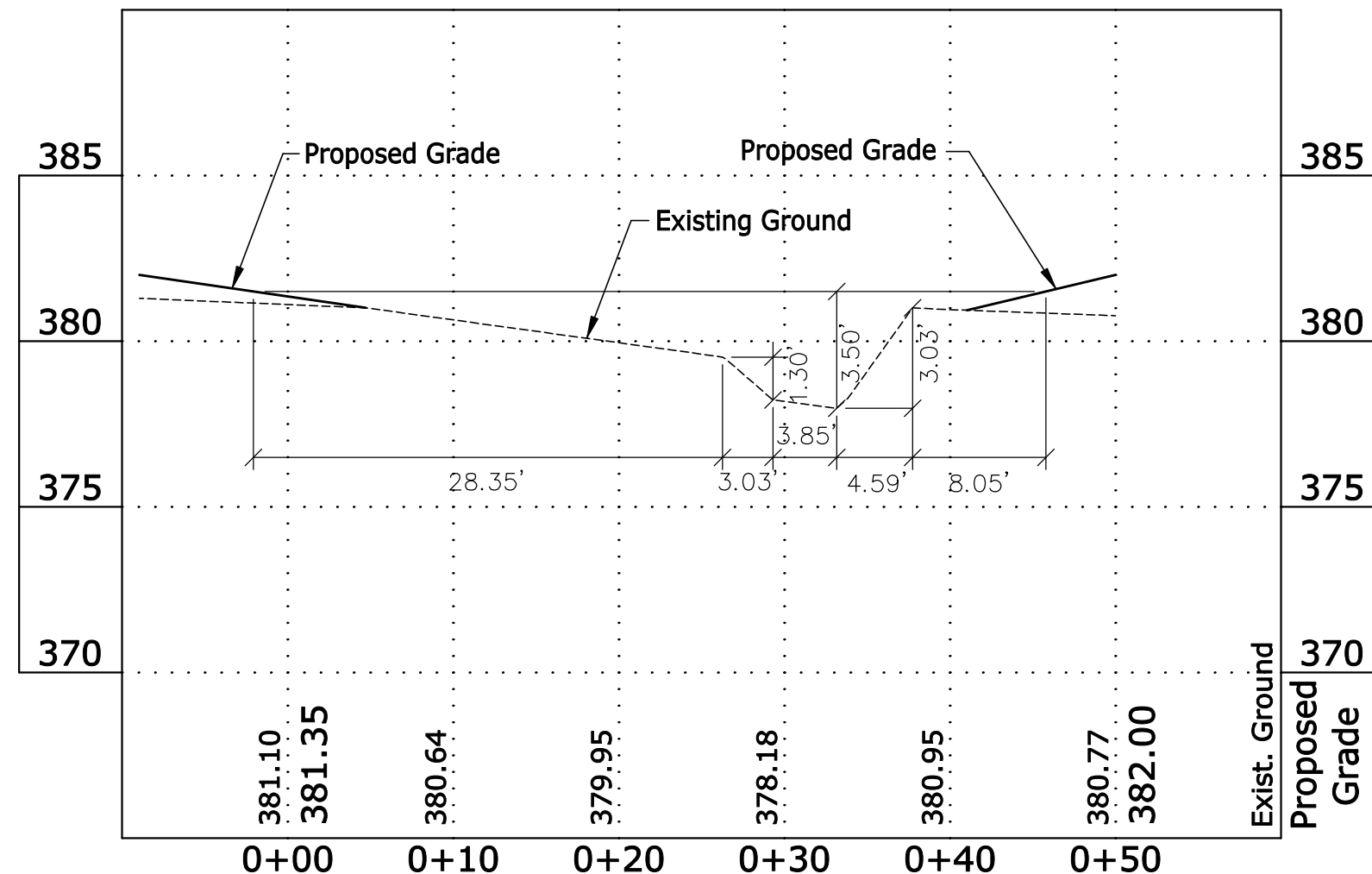

**CROSS SECTION K-K**  
Scale: N.T.S.

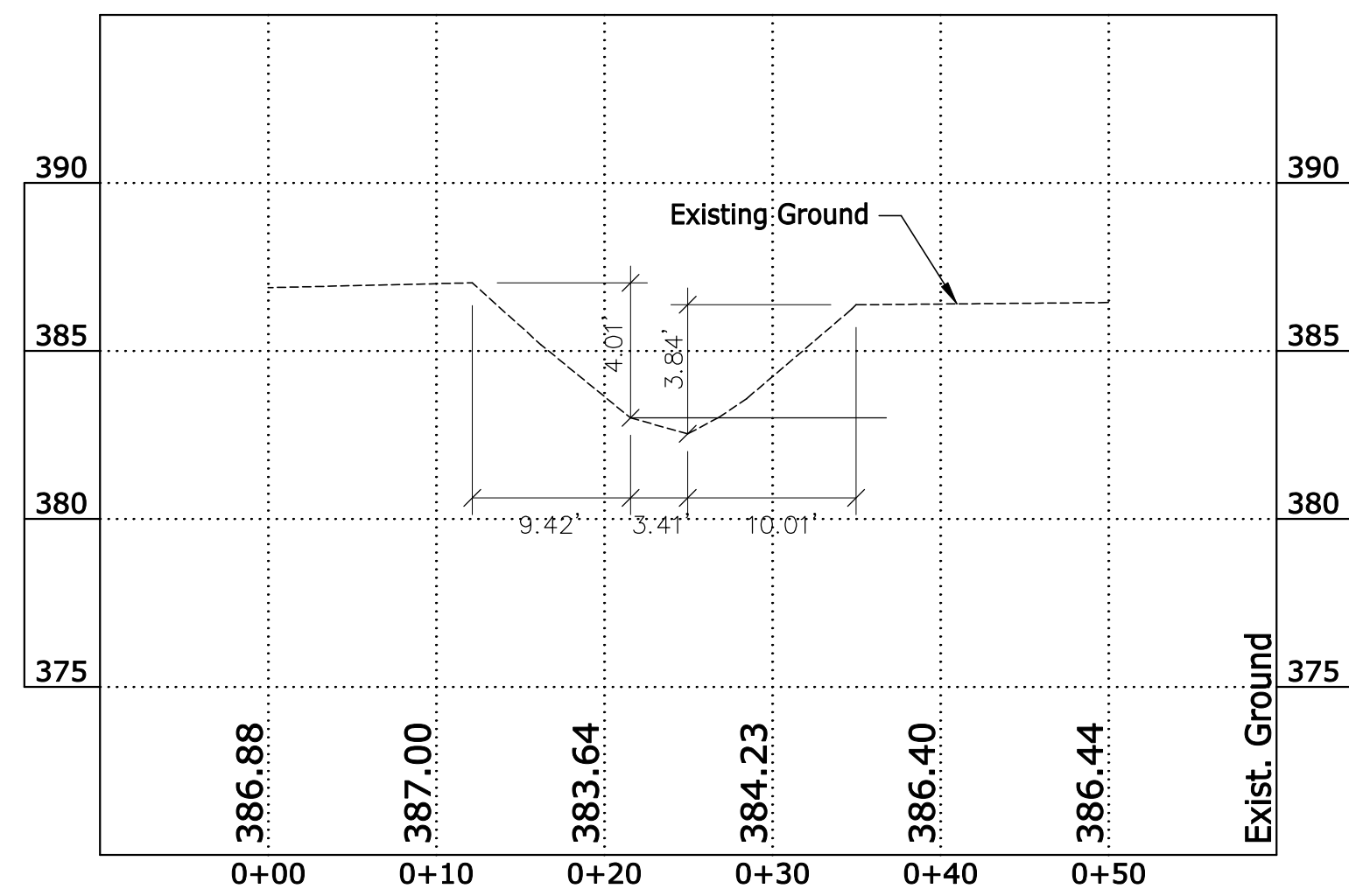

**CROSS SECTION I-I**  
Scale: N.T.S.

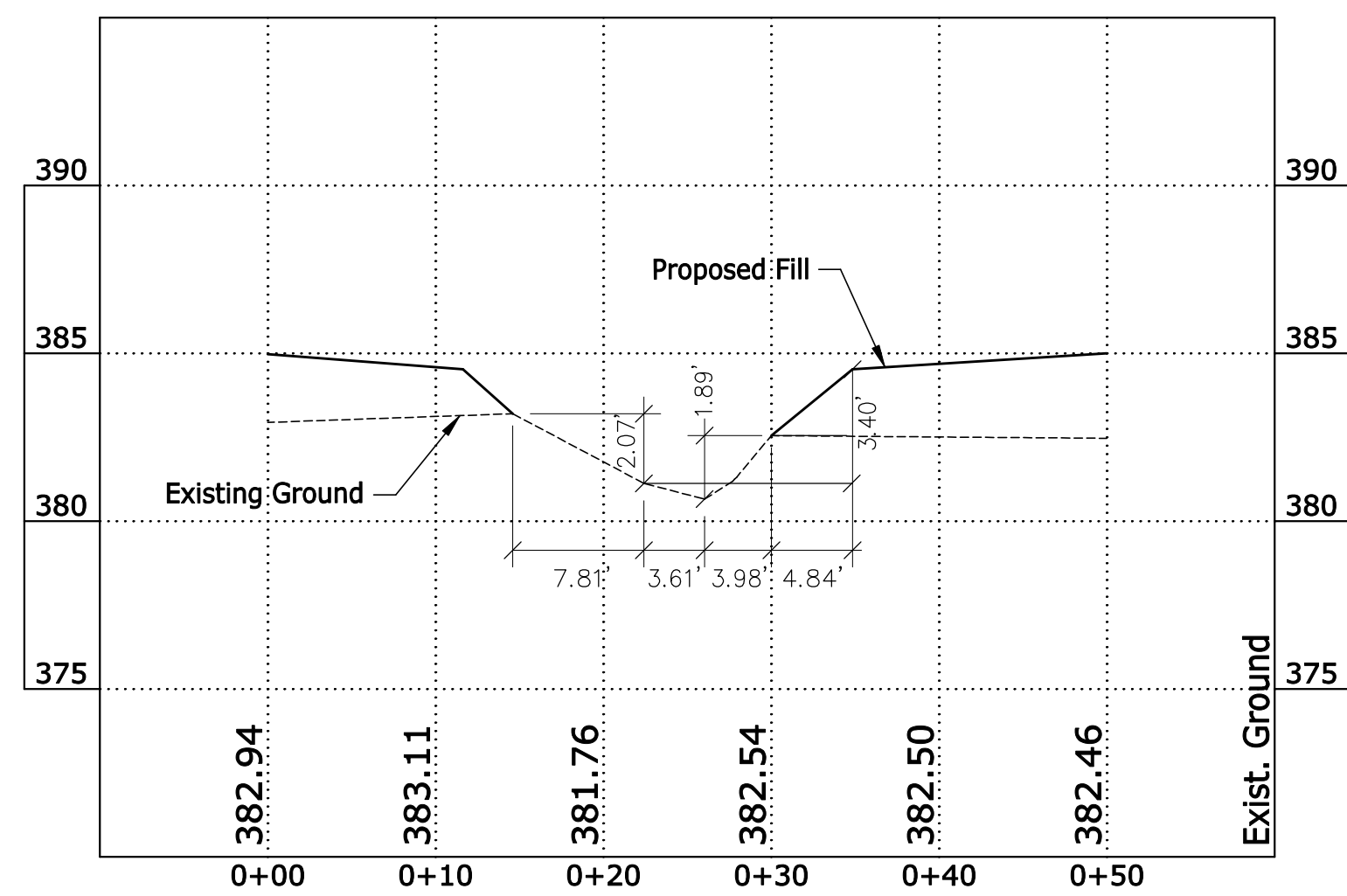

**CROSS SECTION J-J**  
Scale: N.T.S.

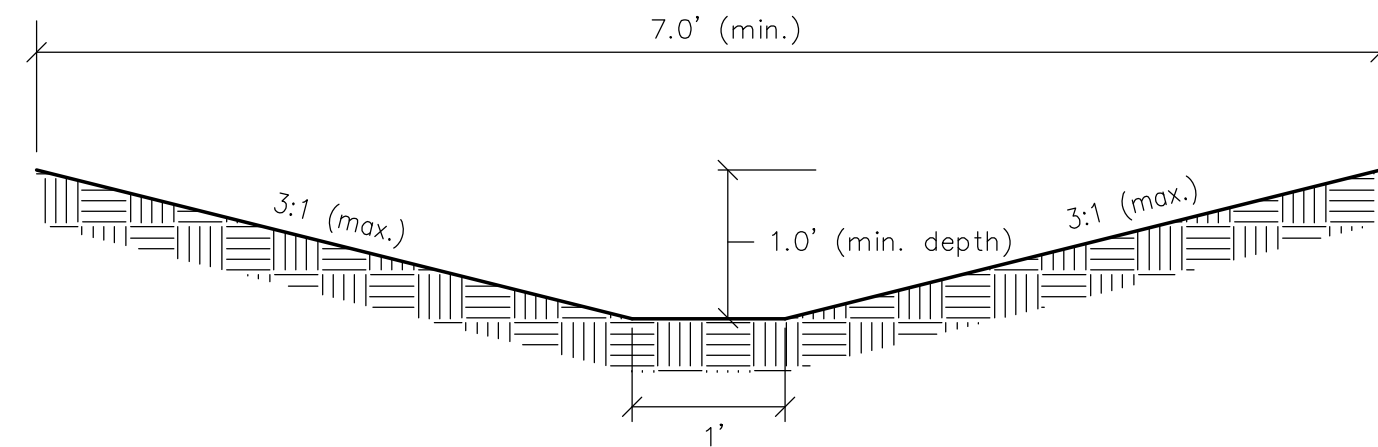

**SIDE YARD SWALE CROSS-SECTION**  
Scale: N.T.S.

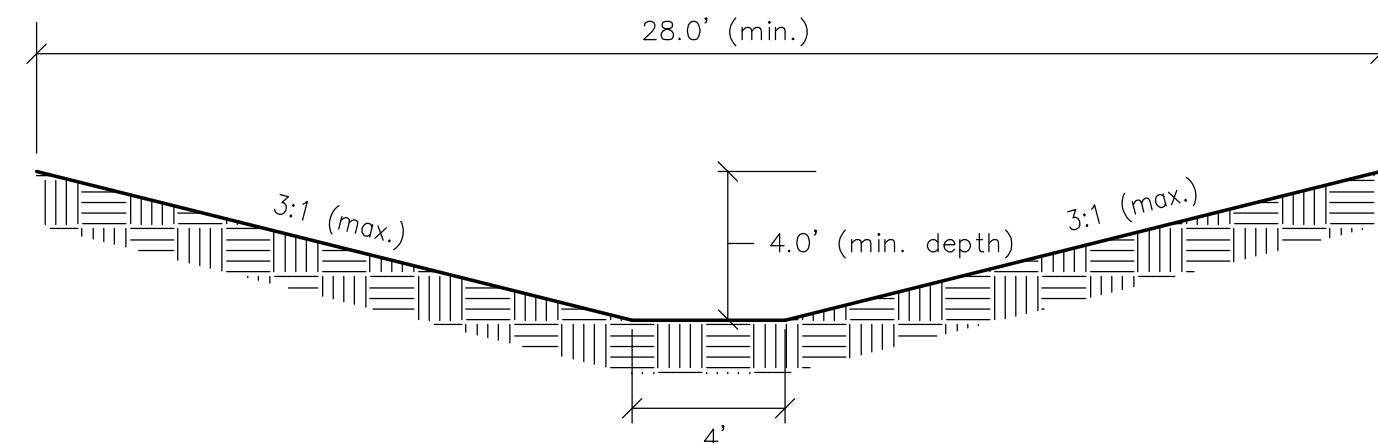

**CROSS-SECTION L-L**  
Scale: N.T.S.

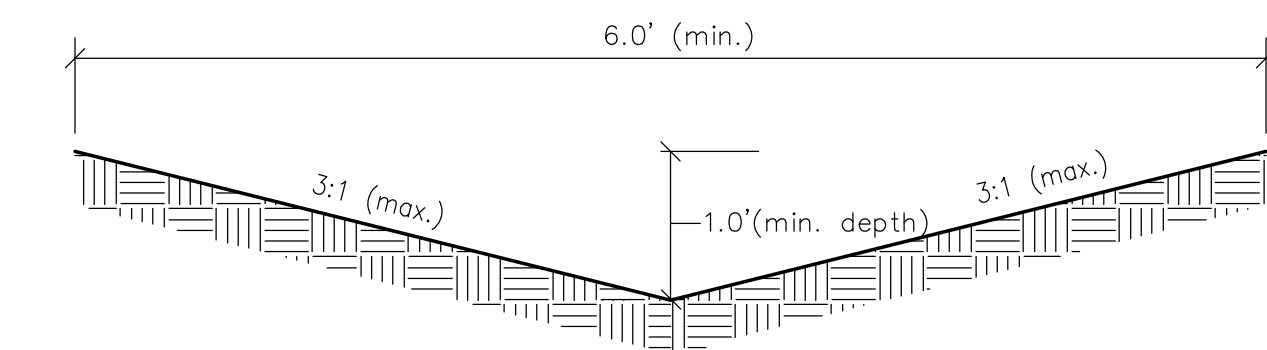

**SURFACE OVERFLOW SPILLWAY CROSS-SECTION**  
Scale: N.T.S.

- NOTES:**
1. Required between lots 30 & 31, 38 & 39, 39 & 40, 41 & 42, 49 & 50, 79 & 80, 85 & 86, 106 & 107, 112 & 113 & 115 & 116, 120 & 121, 124 & 125, 164 & 165, 168 & 169.
  2. The high point of the spillway shall be located at the back of the sidewalk.
  3. The maximum elevation of the spillway shall be 6" above the curb inlet front of grate elevation unless otherwise noted.

SWALE TABLE				
Swale Number	Slope %	Length Feet	Erosion Control Protection Required	
			#1	1.53
#2	0.80	240	Seeded and Mulched	
#3	0.80	60	Seeded and Mulched	
#4	0.80	240	Seeded and Mulched	
#5	0.80	239	Seeded and Mulched	
#6	0.80	292	Seeded and Mulched	
#7	0.80	439	Seeded and Mulched	
#8	2.47	170	Staked Sod	
#9	2.16	104	Staked Sod	
#10	0.80	489	Seeded and Mulched	
#11	0.80	310	Seeded and Mulched	
#12	0.80	315	Seeded and Mulched	
#13	1.30	260	Erosion Control Blanket	
#14	0.80	288	Seeded and Mulched	
#15	1.81	150	Erosion Control Blanket	
#16	0.80	177	Seeded and Mulched	
#17	0.80	110	Seeded and Mulched	

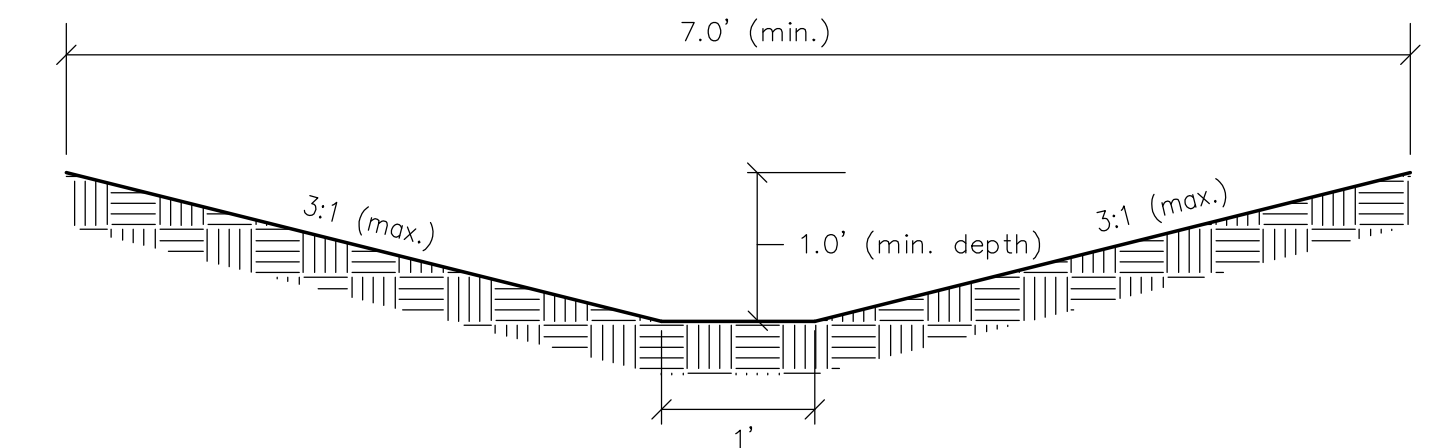

**TYPICAL SWALE CROSS-SECTION**  
Scale: N.T.S.

STORM SEWER STRUCTURE DATA TABLE						
Structure Number	Size	Description	Length Feet	Invert In	Invert Out	Rim = AD/MH FG = CI IE = FES
				Elev.	Elev.	% Elev.
Double CI #500		24" x 74" Box				384.51
P-501	15"	R.C.P. CI. III	52	382.01	381.86	0.29
CI #502		24" x 36" Box				384.51
P-503	15"	R.C.P. CI. III	27	381.86	381.65	0.77
Double CI #504		24" x 74" Box				384.51
P-505	18"	R.C.P. CI. III	150	381.65	380.46	0.80
FES #506		12" End Section				383.78
P-507	12"	R.C.P. CI. III	137	383.68	381.33	1.71
Double CI #508		24" x 74" Box				384.52
P-509	15"	R.C.P. CI. III	26	381.33	380.89	1.71
Double CI #510		24" x 74" Box				384.52
P-511	24"	R.C.P. CI. III	150	380.89	380.46	0.29
AD #512		30" x 46" Box				384.70
P-513	30"	R.C.P. CI. III	135	380.46	379.97	0.36
CI #514		30" x 46" Box				384.43
P-515	30"	R.C.P. CI. III	26	379.97	379.88	0.36
CI #516		30" x 46" Box				384.43
P-517	30"	R.C.P. CI. III	41	379.88	379.72	0.38
FES #518		30" End Section				379.70
FES #520		18" End Section				382.32
P-521	18"	R.C.P. CI. III	132	382.27	381.16	0.84
CI #522		24" x 36" Box				384.52
P-523	18"	R.C.P. CI. III	27	381.16	380.87	1.09
CI #524		24" x 36" Box				384.52
P-525	21"	R.C.P. CI. III	128	380.87	379.75	0.87
FES #526		21" End Section				379.70
CI #528		24" x 36" Box				384.51
P-529	12"	R.C.P. CI. III	26	382.26	382.14	0.46
CI #530		24" x 36" Box				384.51
P-531	12"	R.C.P. CI. III	129	382.14	379.81	1.81
FES #532		12" End Section				379.70
CI #632		24" x 36" Box				384.51
P-633	12"	R.C.P. CI. III	26	382.26	381.74	2.00
CI #634		24" x 36" Box				384.51
P-635	18"	R.C.P. CI. III	197	381.74	381.05	0.35
CI #534		24" x 36" Box				384.51
P-535	18"	R.C.P. CI. III	26	381.05	380.94	0.44
CI #536		24" x 36" Box				384.51
P-537	18"	R.C.P. CI. III	129	380.94	379.76	0.91
FES #538		18" End Section				379.70
FES #540		15" End Section				379.70
P-541	15"	R.C.P. CI. III	35	379.55	378.65	2.56
HW #542		15" Headwall w/ Flapgate				378.65
CI #544		24" x 36" Box				384.30
P-545	12"	R.C.P. CI. III	59	378.12	377.33	1.34
FES #546		12" End Section				377.25
CI #548		24" x 36" Box				384.51
P-549	12"	R.C.P. CI. III	26	382.26	382.12	0.52
CI #550		24" x 36" Box				384.51
P-551	12"	R.C.P. CI. III	195	382.12	377.41	2.42
AD #552		30" x 30" Box				380.50
P-553	18"	R.C.P. CI. III	49	377.41	377.27	0.29
FES #554		18" End Section				377.25
CI #556		24" x 36" Box				384.30
P-557	12"	R.C.P. CI. III	42	382.20	381.99	0.50
CI #558		24" x 36" Box				384.30
P-559	12"	R.C.P. CI. III	38	381.99	380.70	3.40
CI #560		24" x 36" Box				384.53
P-561	12"	R.C.P. CI. III	152	380.70	377.38	2.18
FES #562		12" End Section				377.25

STORM SEWER STRUCTURE DATA TABLE						
Structure Number	Size	Description	Length Feet	Invert In	Invert Out	Rim = AD/MH FG = CI IE = FES
				Elev.	Elev.	% Elev.
HW #564		60" Headwall				379.92
P-565	60"	R.C.P. CI. III	114	379.92	379.75	0.15
HW #566		60" Headwall				379.75
FES #570		12" End Section				377.25
P-571	12"	R.C.P. CI. III	73	377.23	377.00	0.32
HW #572		12" Headwall w/ Flapgate				377.00
CI #574		24" x 36" Box				384.52
P-575	12"	R.C.P. CI. III	26	382.27	382.02	0.95
CI #576		24" x 36" Box				384.52
P-577	15"	R.C.P. CI. III	126	382.02	380.24	1.42
FES #578		15" End Section				380.15
CI #580		24" x 36" Box				384.51
P-581	12"	R.C.P. CI. III	26	382.26	382.01	0.95
CI #582		24" x 36" Box				384.51
P-583	15"	R.C.P. CI. III	126	382.01	380.23	1.41
FES #584		15" End Section				380.15
FES #586		12" End Section				382.70
P-587	12"	R.C.P. CI. III	137	382.68	382.26	0.31
CI #588		24" x 36" Box				384.51
P-589	12"	R.C.P. CI. III	26	382.26	381.92	1.30
CI #590		24" x 36" Box				384.51
P-591	12"	R.C.P. CI. III	36	381.92	380.40	4.20
FES #592		12" End Section				380.15
FES #594		12" End Section				381.62
P-595	12"	R.C.P. CI. III	101	381.59	381.02	0.56
MH #596		30" x 30" Box				385.30
P-597	12"	R.C.P. CI. III	27	381.02	380.88	0.54
CI #598		24" x 36" Box				384.51
P-599	15"	R.C.P. CI. III	26	380.88	380.72	0.58
CI #600		24" x 36" Box				384.51
P-601	18"	R.C.P. CI. III	126	380.72	380.18	0.43
FES #602		18" End Section				380.15
CI #604		24" x 36" Box				384.44
P-605	12"	R.C.P. CI. III	26	382.19	381.94	0.95
CI #606		24" x 36" Box				384.44
P-607	15"	R.C.P. CI. III	126	381.94	380.23	1.36
FES #608		15" End Section				380.15
FES #610		12" End Section				380.15
P-611	12"	R.C.P. CI. III	55	380.06	379.19	1.57
MH #612		30" x 30" Box				384.00
P-613	12"	R.C.P. CI. III	19	379.19	378.89	1.58
HW #614		12" Headwall w/ Flapgate				378.89
HW #616		45" x 73" Headwall				381.15
P-617	45" x 73"	R.C.P. CI. III	66	381.15	381.05	0.15
HW #618		45" x 73" Headwall				381.05
FES #620		15" End Section				388.80
P-621	15"	R.C.P. CI. III	71	388.74	388.06	0.96
FES #622		15" End Section				388.00
CI #624		24" x 36" Box				392.24
Existing 18" R.C.P.						387.94
FES #626		15" End Section				385.82
P-627	15"	R.C.P. CI. III	65	385.77	385.27	0.78
FES #628		15" End Section				385.22

This drawing and/or specifications is provided as an instrument of service provided by Cash Wagner & Associates, PC and is intended for use on the project only. All drawings, specifications, design, models, ideas, calculations, and arrangements appearing herein constitutes the original and unpublished work of and remains the property of Cash Wagner & Associates, PC. Any reproduction, use or disclosure of the proprietary information contained herein without the prior written consent of the Cash Wagner & Associates, PC is strictly prohibited.

Written dimensions shown hereon shall take precedence over scaled dimensions. Contractors shall calculate and measure required dimensions. Notify Cash Wagner & Associates, PC with any variations in dimensions or conditions from those indicated on these drawings. This drawing was based on available information. Commencement of work constitutes verification and acceptance of existing conditions.

Application of a material or equipment to work installed by others constitutes acceptance of that work and assumption of responsibility for satisfactory installation.

**GLEY A. MERITT, JR.**  
REGISTERED PROFESSIONAL ENGINEER  
No. PE10403870  
STATE OF INDIANA

*G. Meritt*  
SIGNATURE  
22 Aug 22  
DATE

**CASH WAGNER & ASSOCIATES, PC**  
CONSULTING | ENGINEERING | SURVEYING

414 CITADEL CIRCLE  
SUITE B  
EVANSVILLE, IN 47715  
PH: 812.401.5561  
FAX: 812.401.5563  
CELL: 812.774.2988  
E-MAIL: GMERITT@CASHWAGNER.COM

NO.	DATE	BY	DESCRIPTION
1	08.11.22	G.A.M.	Added side yard swale cross section and cross section K-K
2	08.22.22	G.A.M.	Added cross section L-L

PROJECT NO.:	22-5012
DESIGNED BY:	
DRAWN BY:	G.A.M.
FILENAME:	5012 DrainageDtls
LAYOUT TAB:	
SCALE:	As Shown

PROJECT: **GOLDFINCH COVE**  
ADDRESS: **GREEN RIVER ROAD  
EVANSVILLE, INDIANA**

DATE: **07.20.22**  
DRAWING NO.: **C-121**  
SHEET TITLE: **DRAINAGE DETAILS  
SHEET 2**