

Persimmon Lane and Road #1

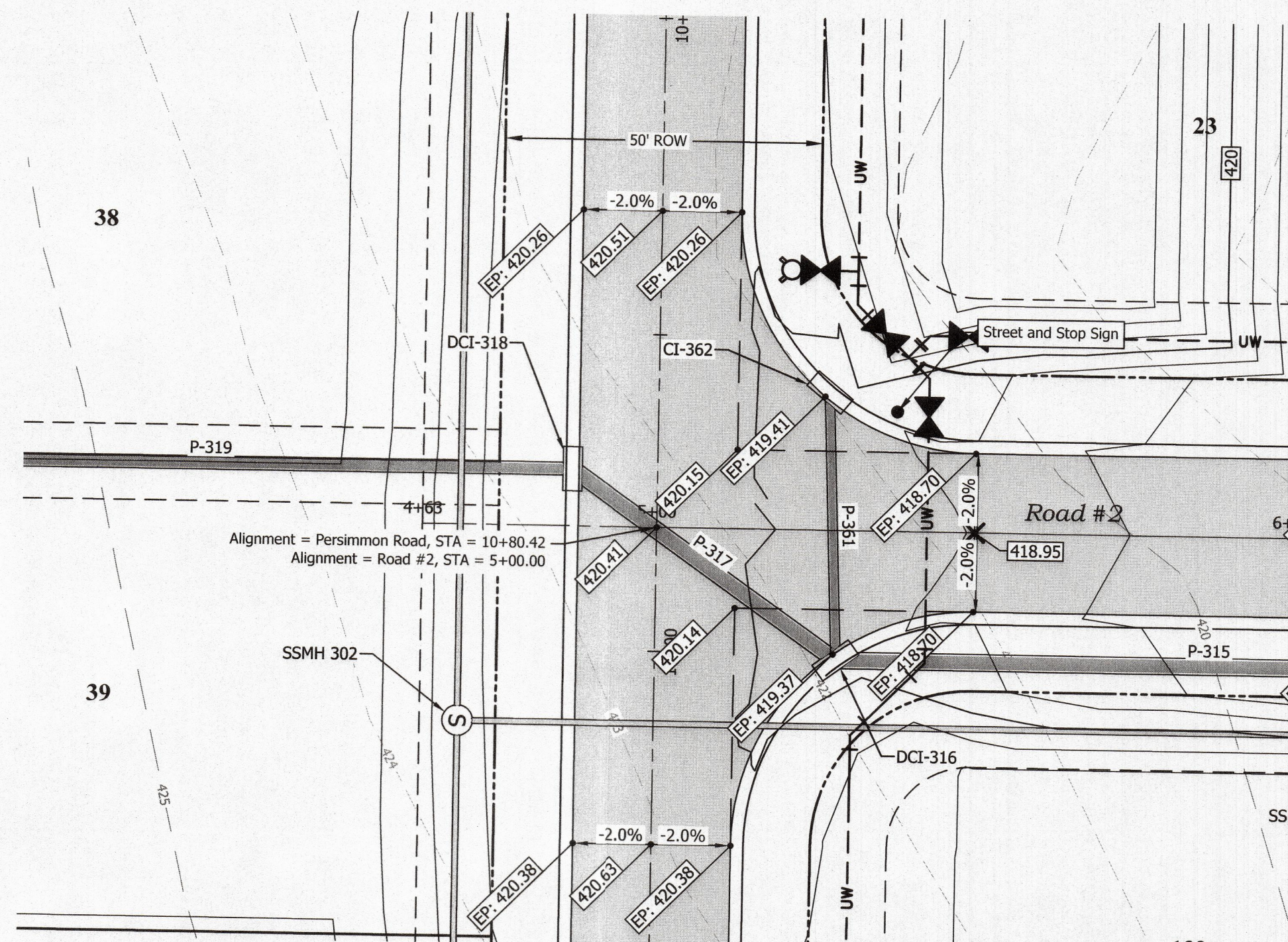

Persimmon Lane and Road #2

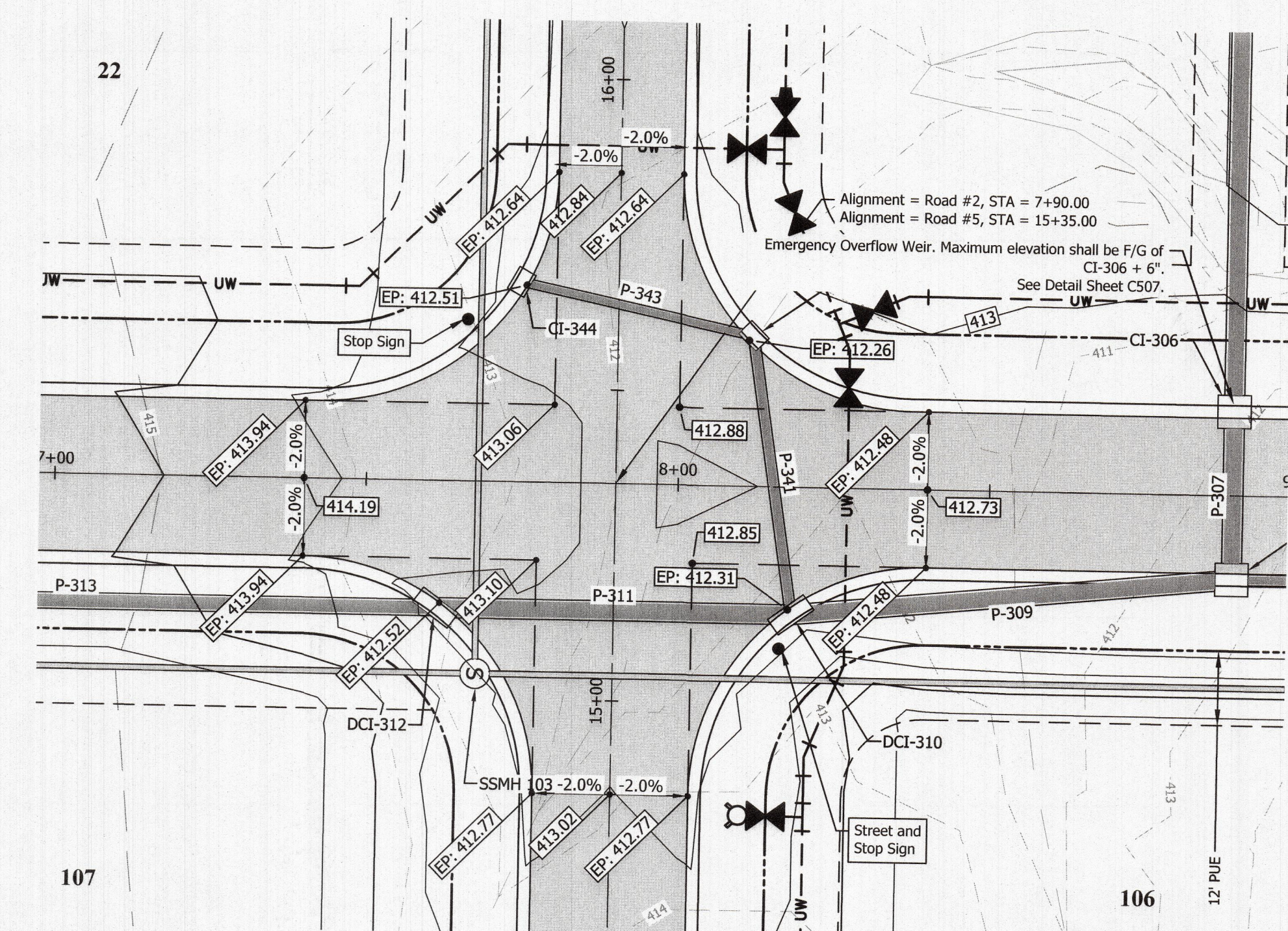

Road #2 and Road #5

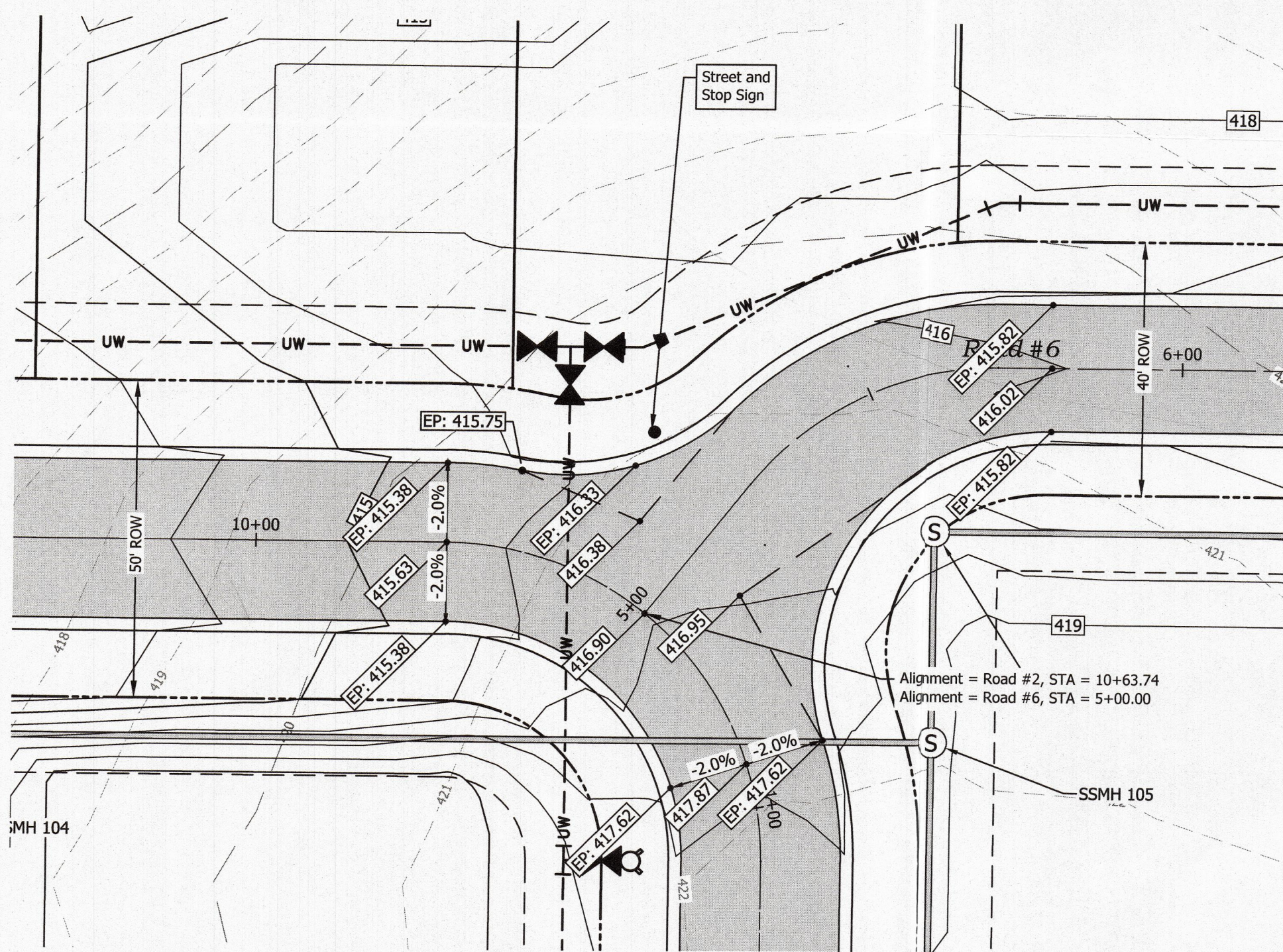

Road #2 and Road #6

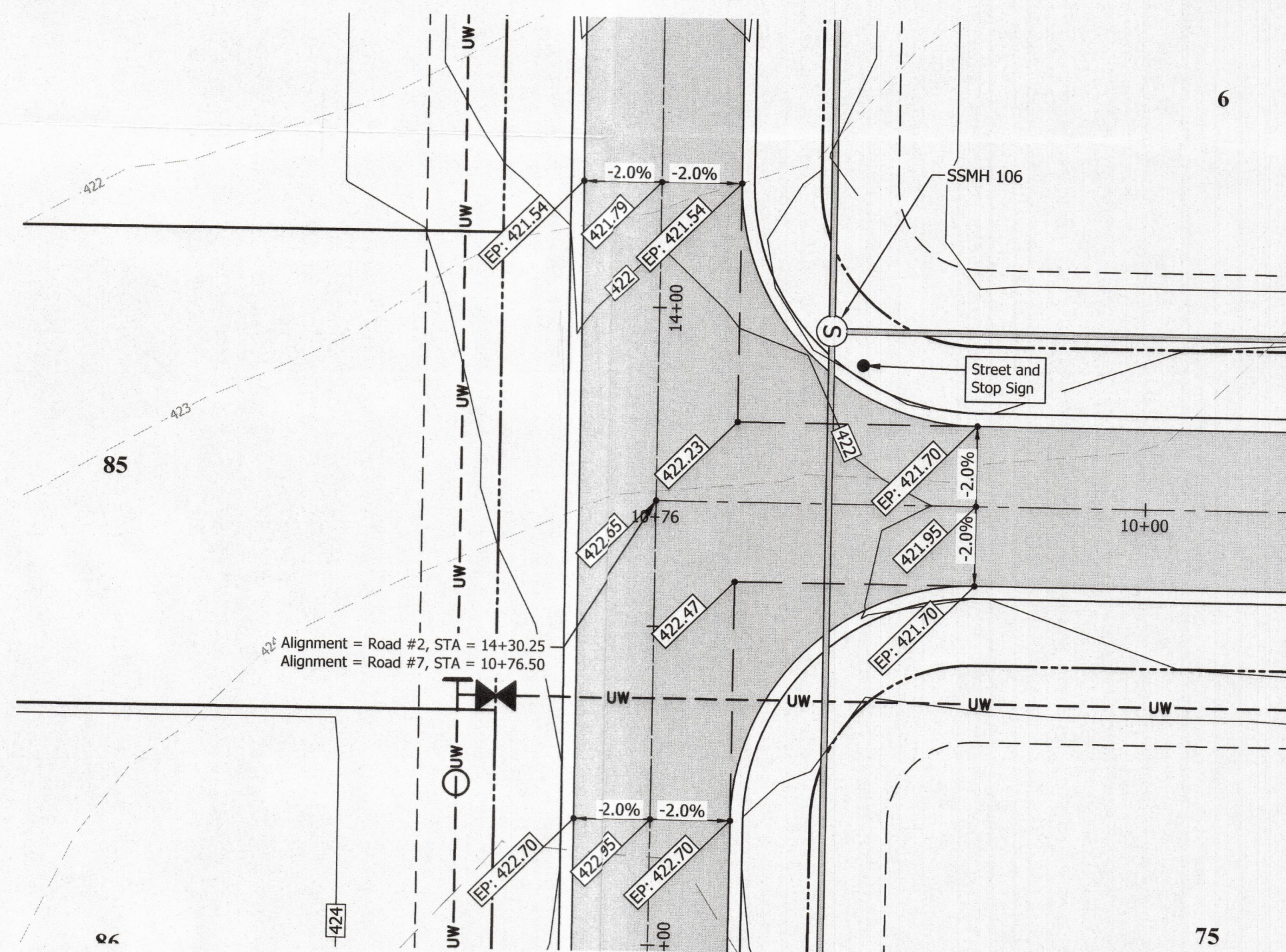

Road #2 and Road #7

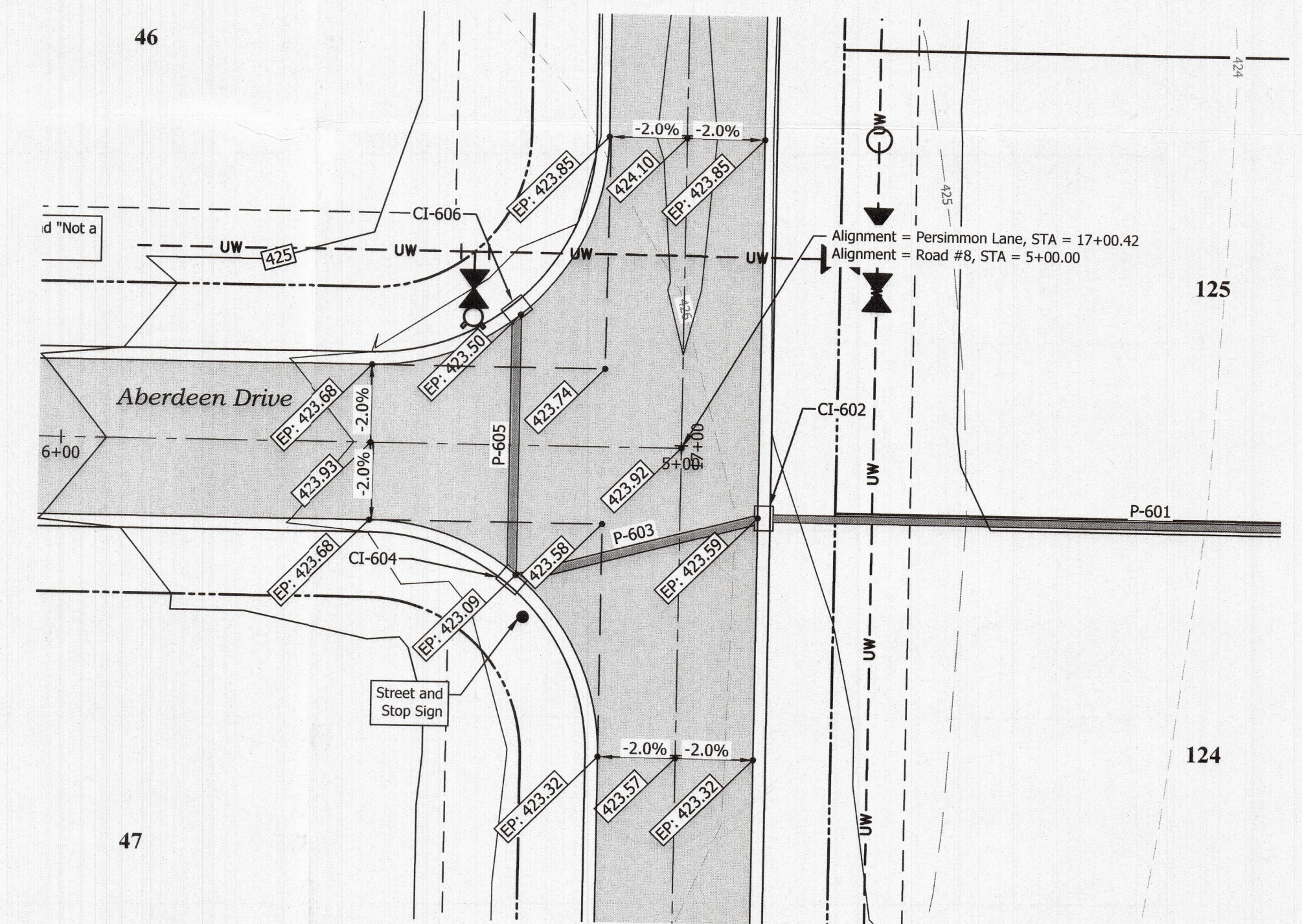

Persimmon Lane and Aberdeen Drive

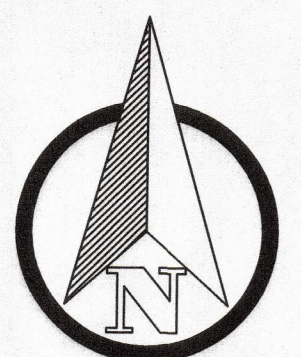

SCALE 1" = 20'

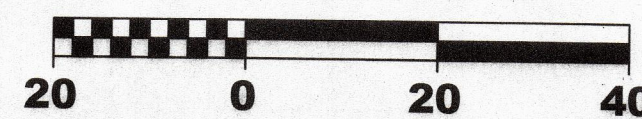

James E. Morley
4-26-22

Revisions		
No.	By	Date

All ideas, designs, calculations, and arrangements indicated or represented by this drawing are owned by and are the property of Morley and Associates, Inc. and were created as instruments of service for use on and in connection with the specified project. Morley and Associates retains all common law, statutory law and other rights including copyrights. No drawings or electronic files shall be reused for any purpose other than the project. They shall not be disclosed to or be used by any other person or firm without the written prior consent of Morley and Associates, Inc.

Written dimensions on these drawings shall have precedence over scale.

Contractors shall verify and be responsible for all dimensions and conditions on the job and Morley and Associates, Inc. must be notified of any variations from the dimensions and conditions shown by these drawings.

If differences exist between electronic files and the signed and sealed hard copy drawings, the hard copy shall govern.

4600 Rosebud Ln., Newburgh, IN 47630 812.464.9585 Fax 812.464.2514 Fax
 morleycorp.com

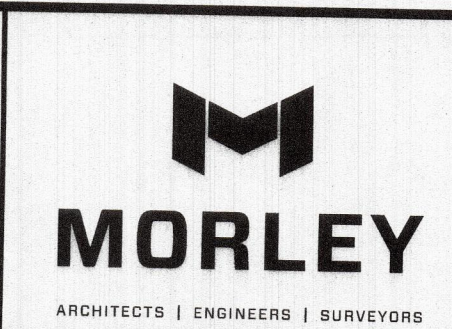

Project: Eleanor's Place
 Sheet Title: Intersection Details - 1
 Vanderburgh County, IN

Received by the Vanderburgh County Surveyor's Office
 APR 26 2022
 Time 10:00AM Initials AR
 Scale: 1" = 20'
 Job Number: 11822.4.001-B
 Date: 4.26.2022
 Filename: 11822 Civil Base
 Sheet Number: C500