

Str. No. 100

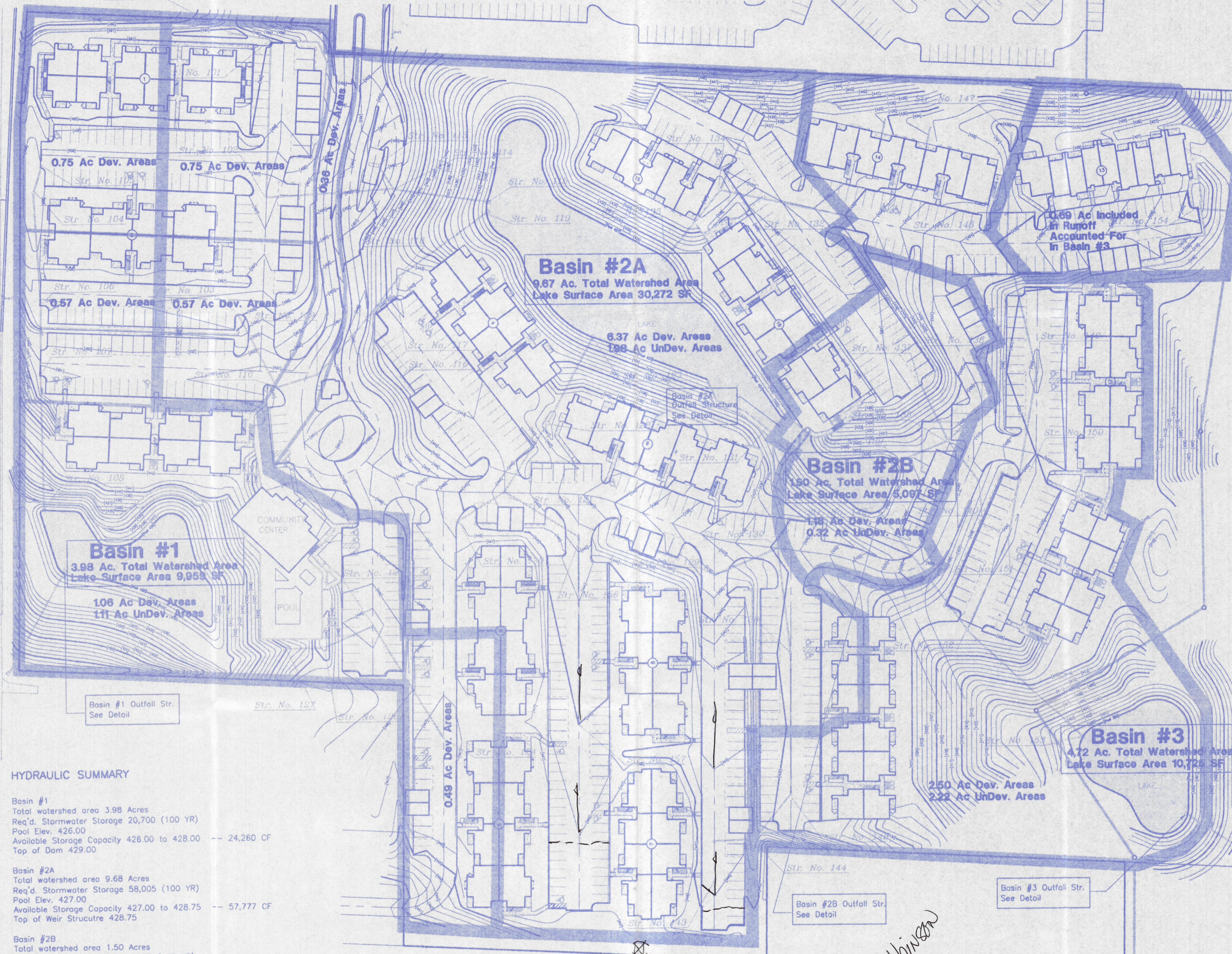

HYDRAULIC SUMMARY

Basin #1
Total watershed area 3.98 Acres
Req'd. Stormwater Storage 20,700 (100 YR)
Pool Elev. 426.00
Available Storage Capacity 426.00 to 428.00 -- 24,260 CF
Top of Dam 429.00

Basin #2A
Total watershed area 9.68 Acres
Req'd. Stormwater Storage 58,005 (100 YR)
Pool Elev. 427.00
Available Storage Capacity 427.00 to 428.75 -- 57,777 CF
Top of Weir Structure 428.75

Basin #2B
Total watershed area 1.50 Acres
Req'd. Stormwater Storage 7,802 (100 YR)
Pool Elev. 425.00
Available Storage Capacity 425.00 to 427.00 -- 12,258 CF
Top of Dam 429.00

Basin #3
Total watershed area 4.72 Acres
Req'd. Stormwater Storage 18,800 (100 YR)
Pool Elev. 399.00
Available Storage Capacity 399.00 to 401.00 -- 26,761 CF
Top of Dam 403.00

For additional information regarding storm sewers refer to sheet SD-4

For additional information regarding site grading refer to sheets SD-1 to SD-3

Dave Robinson

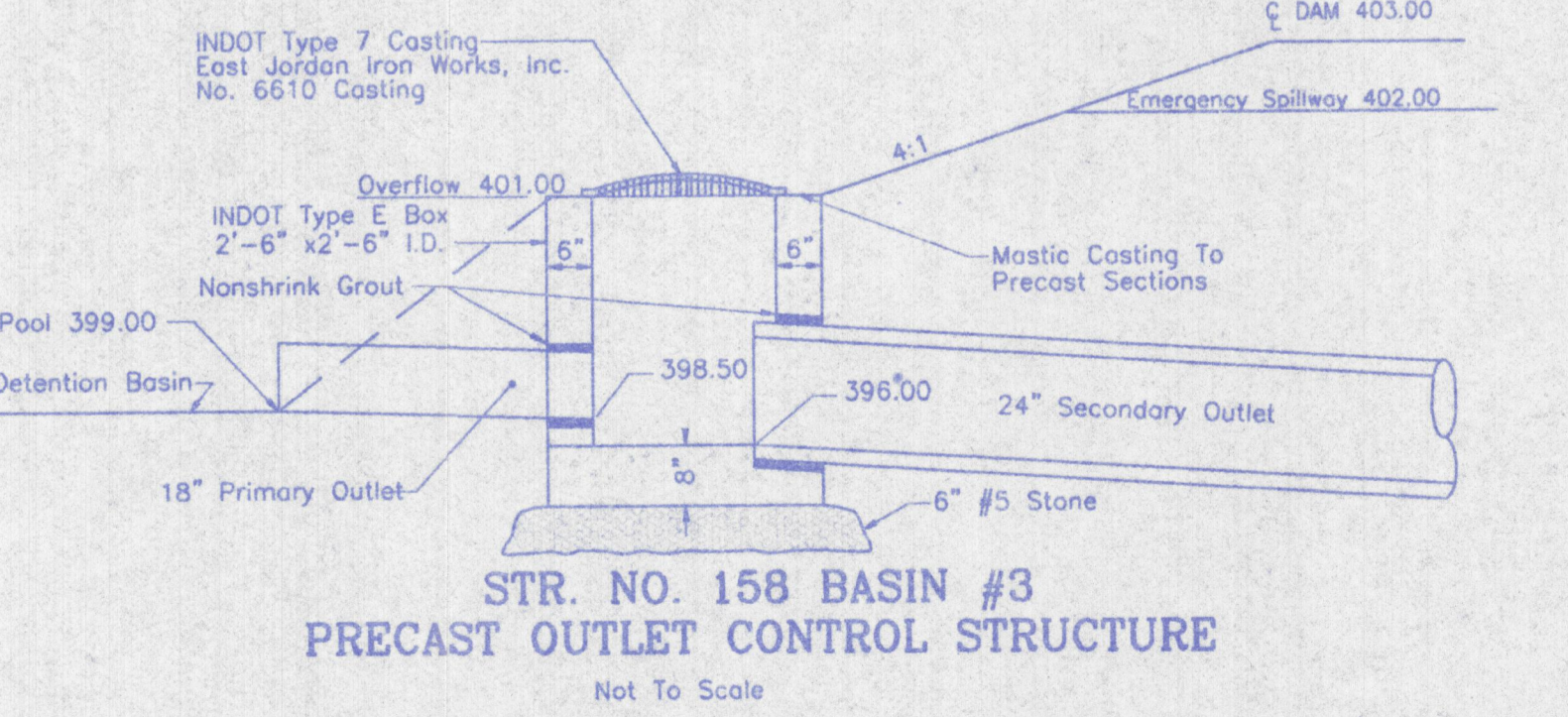
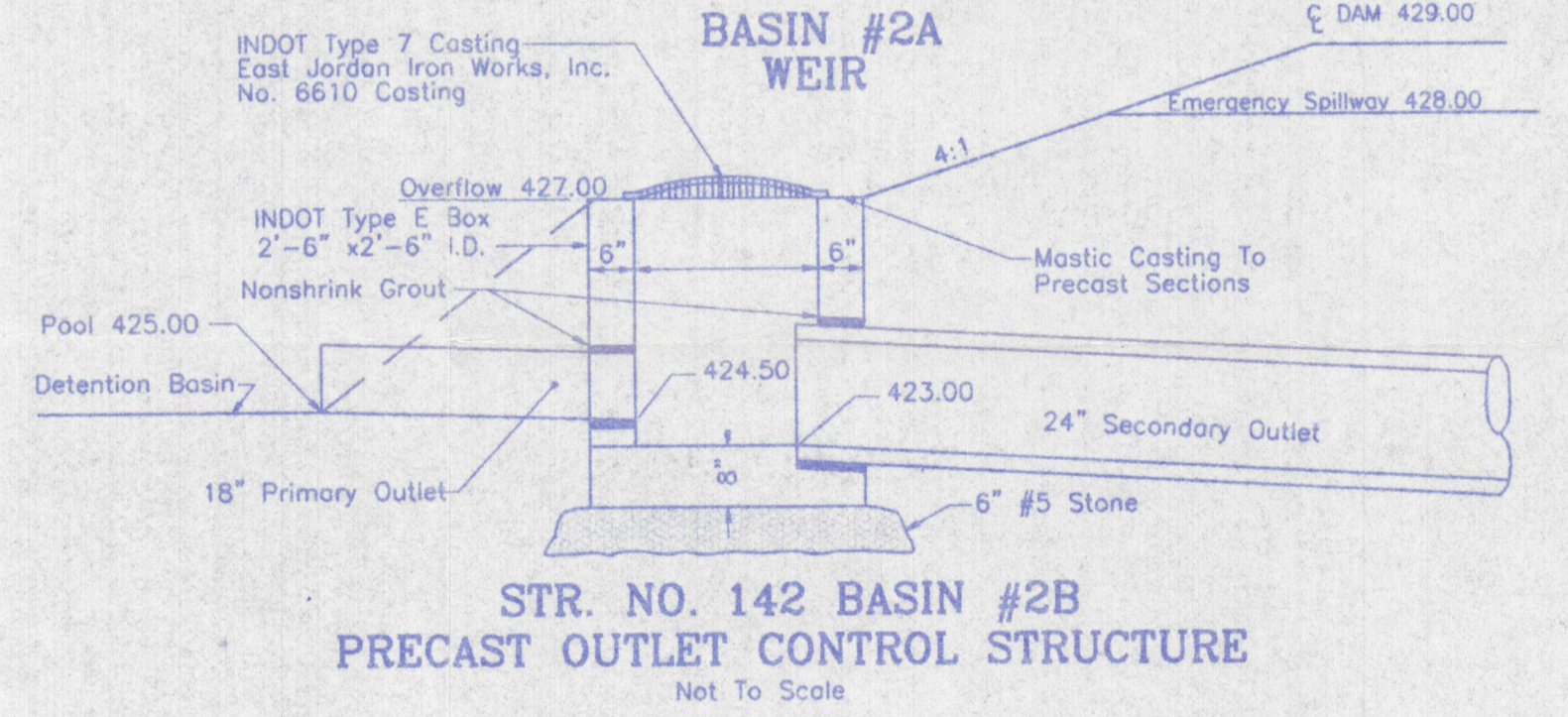
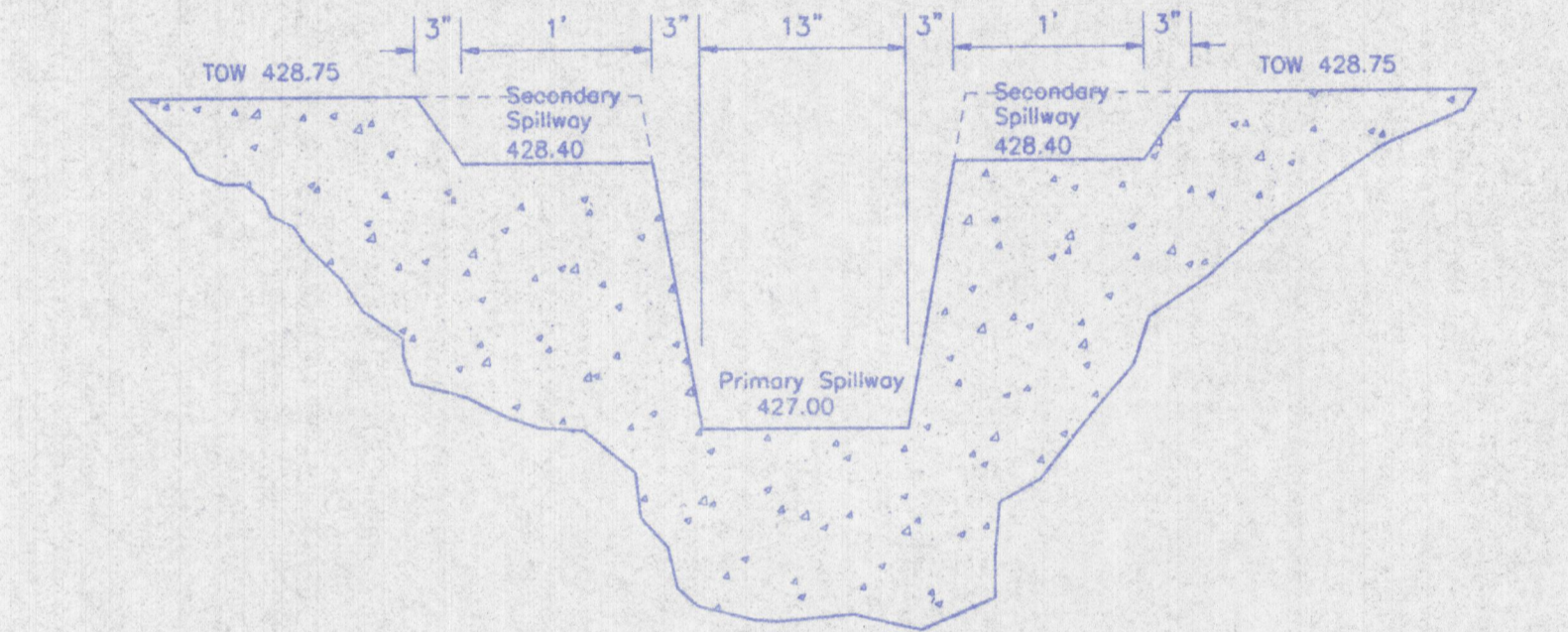
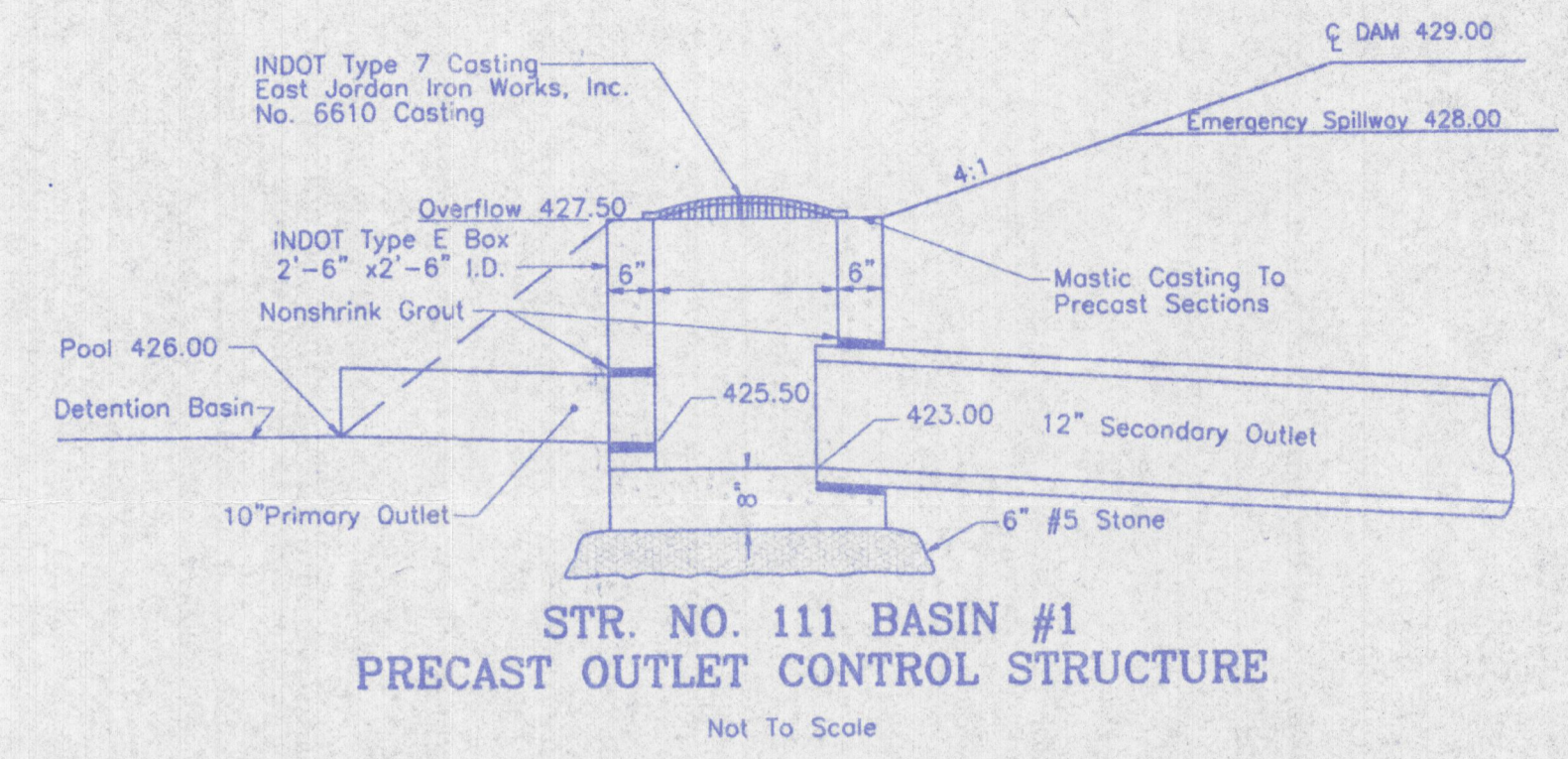
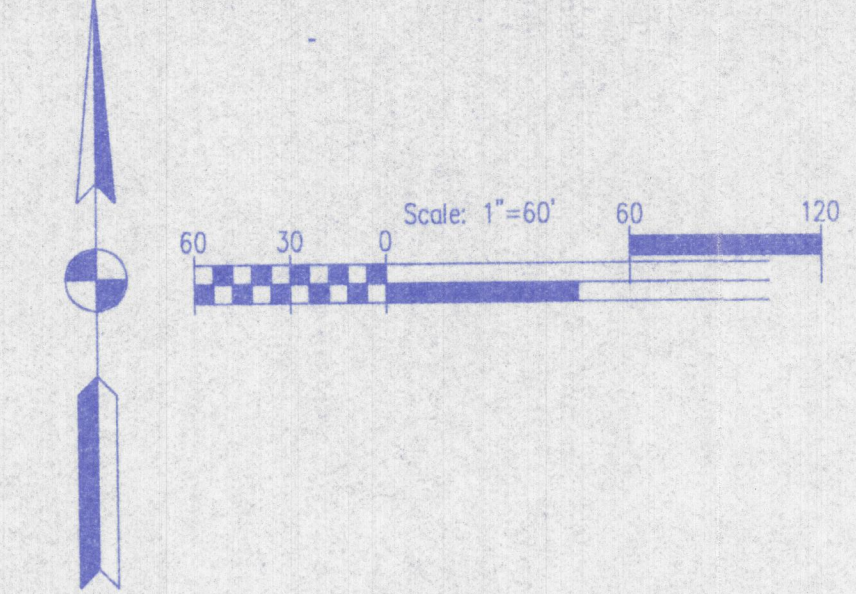

		OVERALL DRAINAGE PLAN	
		FOR COPPER CREEK APARTMENTS EVANSVILLE, INDIANA	
Prepared By BERNARDIN LOCHMUELLER & ASSOC., INC. Planners - Engineers - Surveyors	DATE: 9/17/99	PROJECT NO.:	ISSUED:
	198-0187-OPD		

S:\Projects\198-0187\OverallPlan.dwg 09/21/99 08:39 Ross