







LEGEND

-  PROPERTY BOUNDARY (FROM C/W)
-  INTERMITTENT STREAM
-  EPHEMERAL STREAM
-  PROPOSED STREAM CENTERLINE
-  PROPOSED STREAMBANKS
-  DITCH (NON-JURISDICTIONAL)
-  STREAM MITIGATION AREA (CONSERVATION EASEMENT)
-  JURISDICTIONAL WETLAND
-  STORMWATER POND

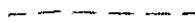
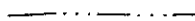

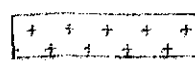
SOURCE: BASE MAP PROVIDED BY CASH WAGNER AND ASSOCIATES, INC

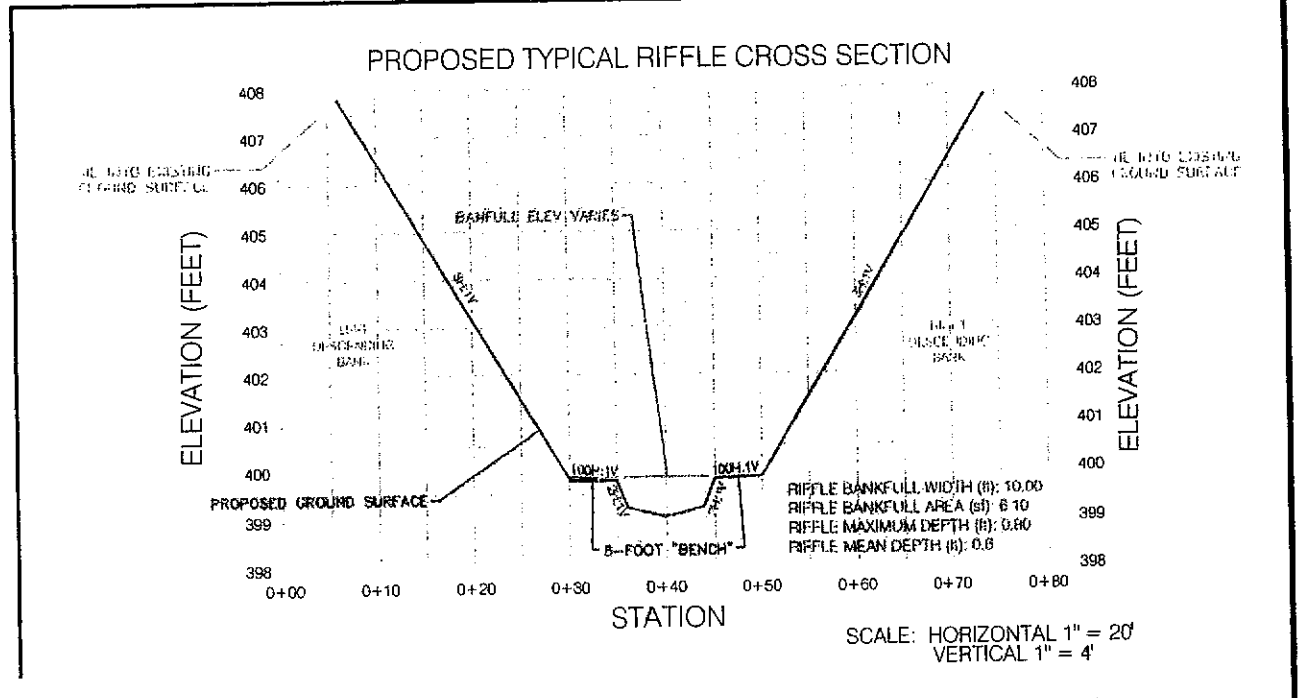
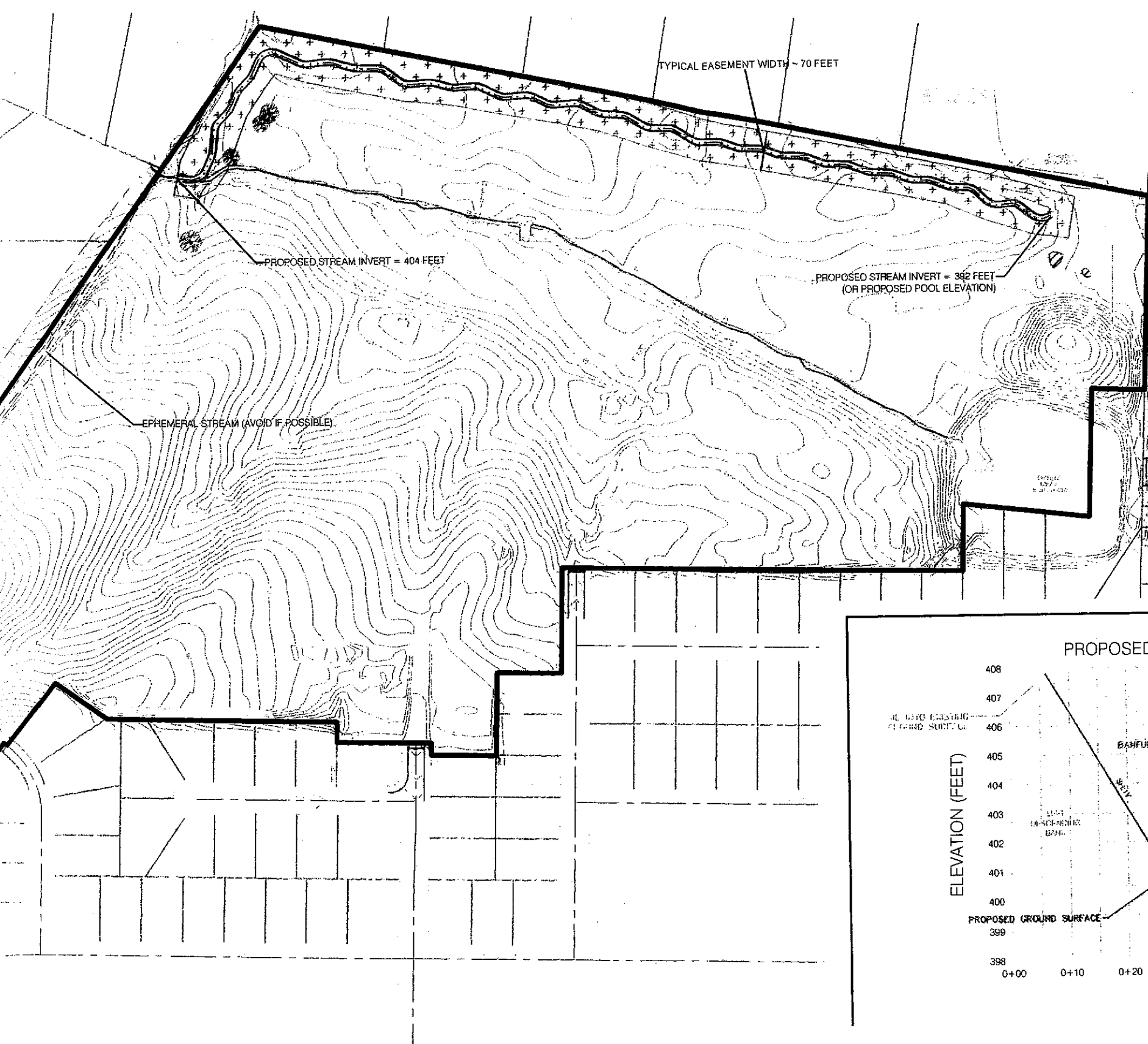
NOTE: JURISDICTIONAL WATER/WETLAND BOUNDARIES WERE DELINEATED AND SURVEYED USING GLOBAL POSITIONING SYSTEM EQUIPMENT BY REDWING WETLAND SCIENTISTS ON NOVEMBER 24, 2014. THESE BOUNDARIES HAVE NOT BEEN VERIFIED BY THE U.S. ARMY CORPS OF ENGINEERS. USE OF THIS MAP IS FOR PRELIMINARY PLANNING PURPOSES ONLY.

CAYMAN RIDGE DEVELOPMENT  
VANDERBURGH COUNTY, INDIANA



PRELIMINARY STREAM  
MITIGATION PLANFORM  
AND CROSS SECTION

REVISED DATE: 01-06-14

DRAWN BY: BMB

RECEIVED BY THE SURVEYOR'S OFFICE

FIGURE X

VANDERBURGH COUNTY SURVEYOR'S OFFICE *lw 1/24/15*

200  
FEET

Offsite and Undeveloped Drainage Subbasins  
Figure 1. DISCHARGE POINTS for the EXISTING DRAINAGE CONDITIONS

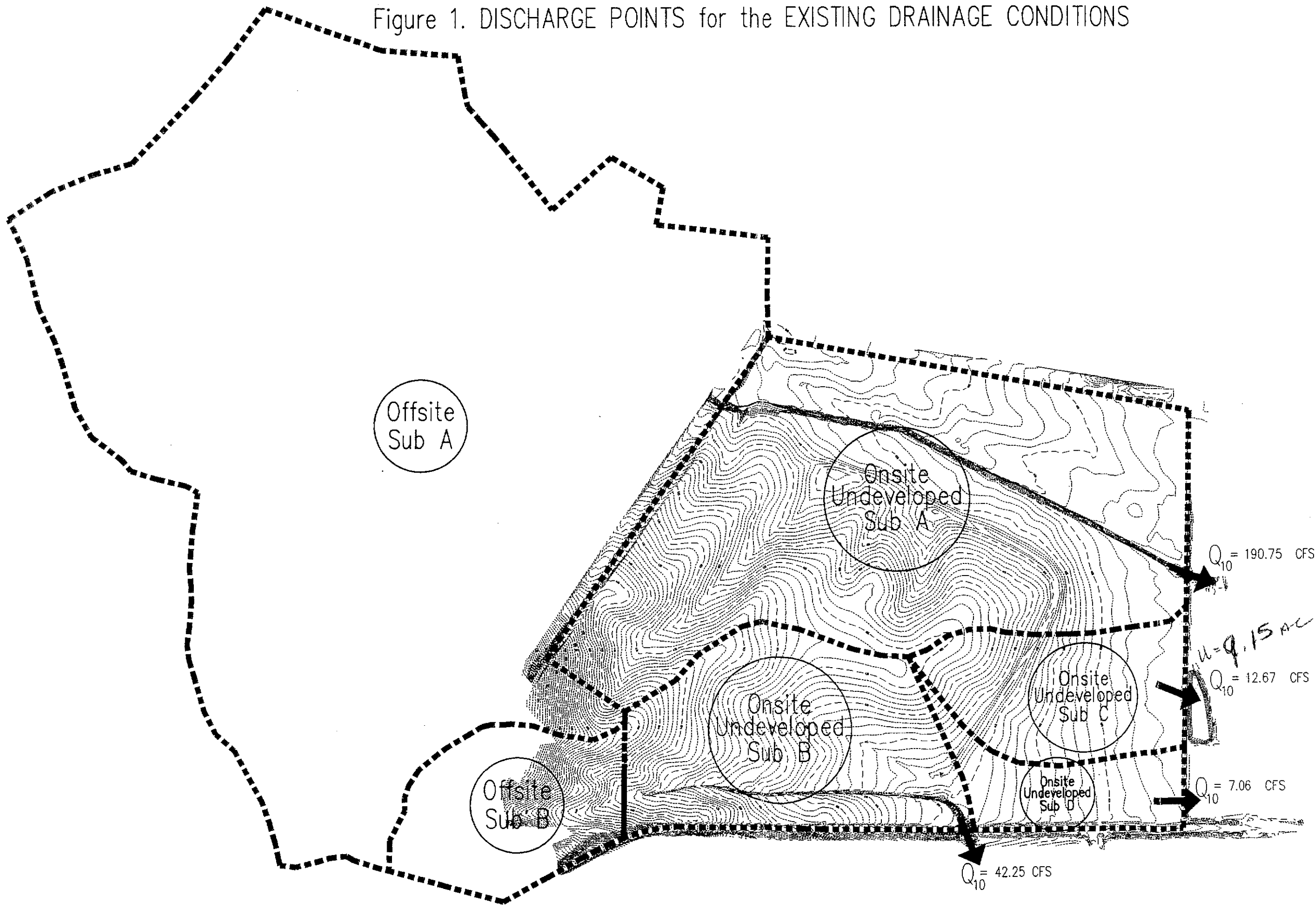

# Proposed Drainage Conditions

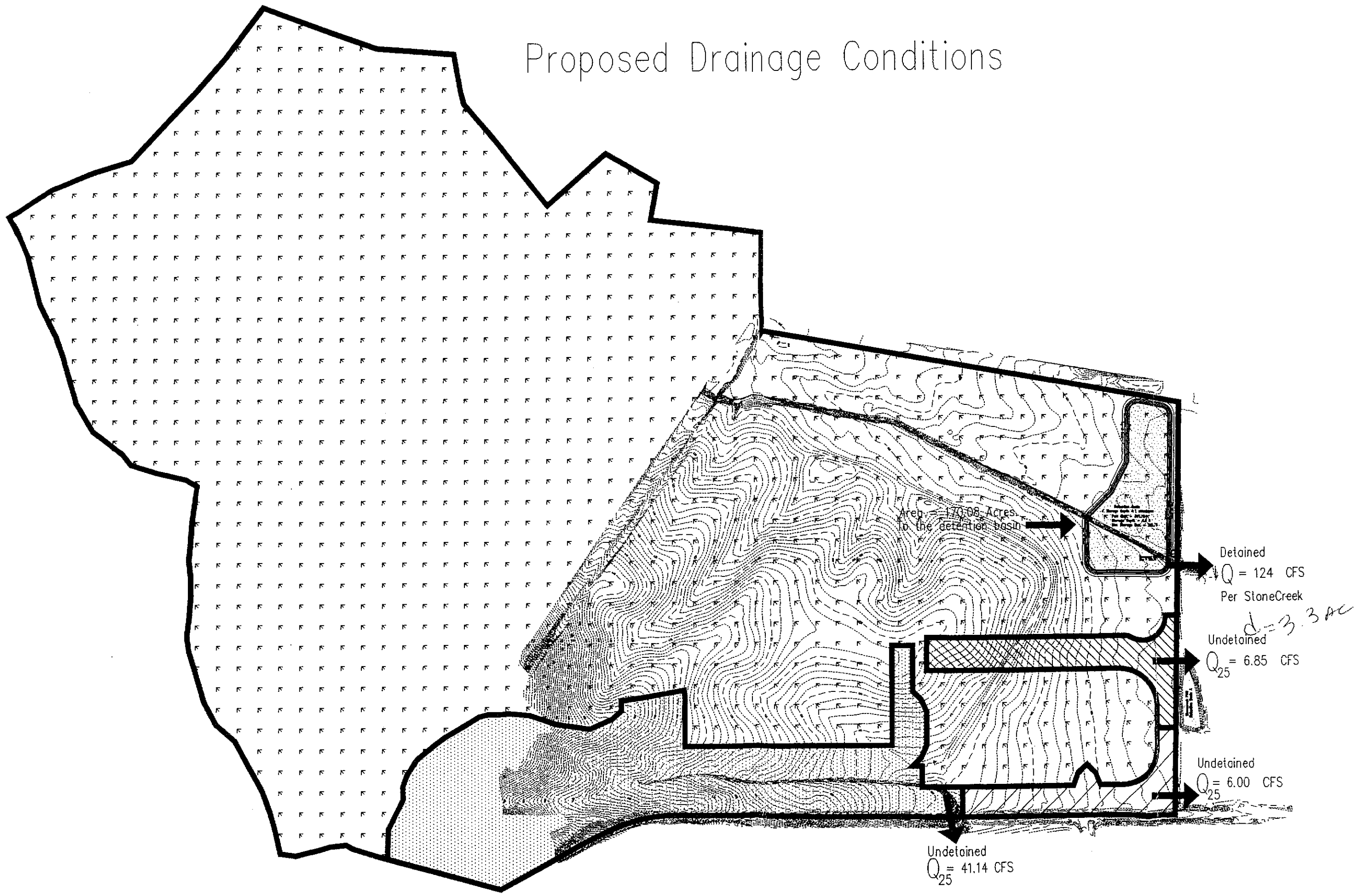

# Developed Drainage Subbasins

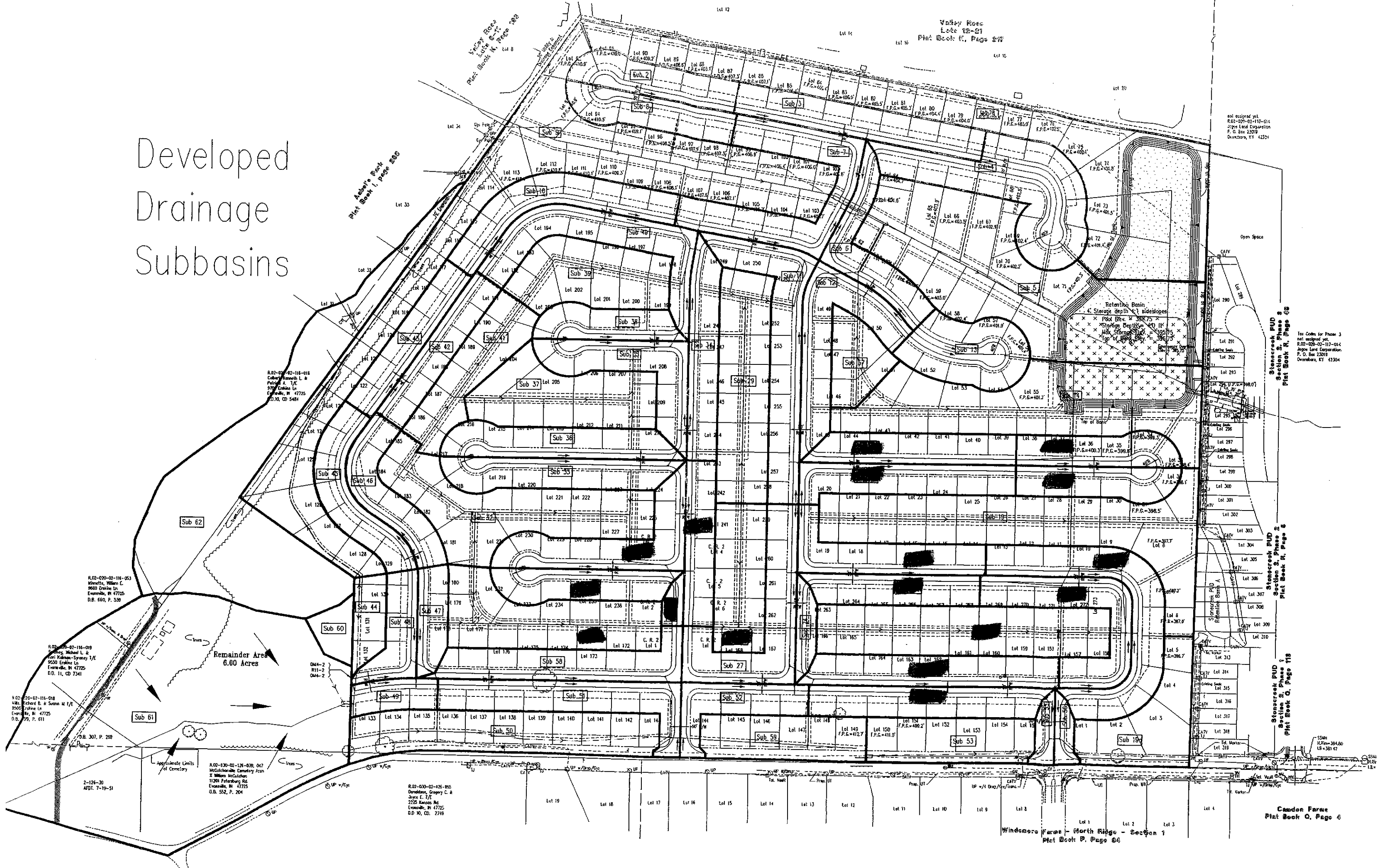

not assigned yet.  
R.02-02-02-117-014  
Joyce Land Corporation  
P. O. Box 22019  
Overland, KY 42304

Stonerock PUD  
Section 2, Phase 2  
Plat Book R, Page 69

Stonerock PUD  
Section 2, Phase 2  
Plat Book R, Page 6

Stonerock PUD  
Section 2, Phase 2  
Plat Book O, Page 118

Camdon Farms  
Plat Book O, Page 4

Windsore Farms - North Ridge - Section 1  
Plat Book P, Page 64

R.02-02-02-116-053  
Minnette, Wilma E.  
9600 Drake Ln.  
Evansville, IN 47725  
D.B. 660, P. 539

R.02-02-02-116-019  
Pattay, Michael L. &  
Toni Yidman-Sprynny T/E  
9550 Drake Ln.  
Evansville, IN 47725  
D.O. 11, CD 7341

R.02-02-02-116-018  
Wes, Richard B. & Susan M. T/E  
29055 Erlene Ln.  
Evansville, IN 47725  
D.B. 395, P. 611

2-124-30  
APD. 7-19-51

R.02-030-02-126-039, 042  
McClellan Cemetery Assn  
11200 Fatenburg Rd.  
Evansville, IN 47725  
D.B. 552, P. 204

R.02-030-02-126-035  
Dorshon, Gregory C. &  
Joyce E. T/E  
2225 Kansas Rd.  
Evansville, IN 47725  
D.D. 10, CD. 2719

See Code for Phase 3  
not assigned yet.  
R.02-02-02-117-014  
Joyce Land Corporation  
P. O. Box 22019  
Overland, KY 42304