

+140

+160

+180

+200

+220

+240

+260

+280

+2+300

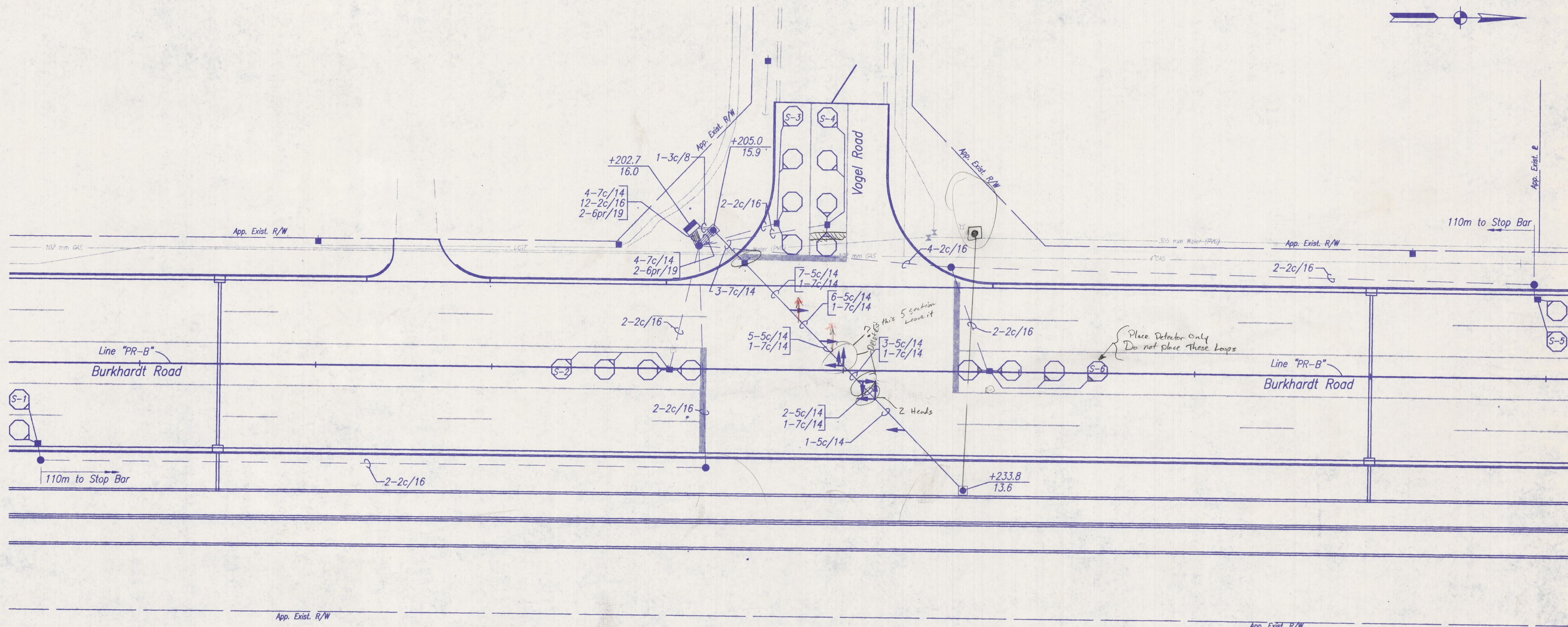

LEGEND

- 3 ea. 3-Section Traffic Signal (300mm Red, 300mm Amber, 300mm Green)
- 1 ea. 5-Section Traffic Signal (300mm Red, 300mm Amber, 300mm Green, 300mm Green Arrow, 300mm Amber Arrow)
- 50mm Galvanized Steel Conduit
- Handhole
- Detector Housing
- 9.1 Meter Steel Strain Pole
- Controller & Cabinet, Menu Driven, 8-Phase w/Evansville System Requirements & C.I.C.U., on Type P-1 Foundation
- Disconnect Hanger
- ⊗ Span & Catenary, 0.95mm ϕ 7x19 Aircraft Cable w/Tether
- 760mm Octagonal Loop, 4 Turns (In Series)
- ⊖ 760mm Octagonal Loop, 4 Turns (In Series) (To Be Wired As Local & Evansville System Detector)

Note: Signal Service to be Run From Power Pole in Southwest Quadrant

2-6pr/19 TCC for Interconnect to be Run From Virginia to Oak Grove Road On SIGECO Poles

Connect Evansville System Detectors S-1 Through S-6 to C.I.C.U. Inputs

PHASE DIAGRAM

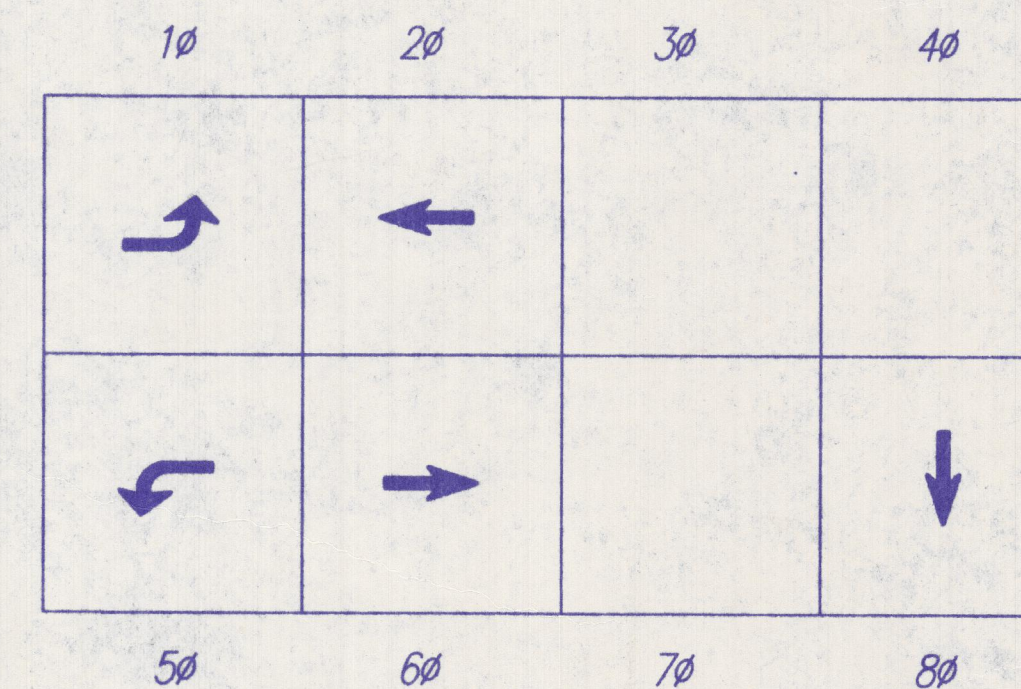

MALFUNCTION DEFAULTS
Oak Grove Road Flashes Red
Burkhardt Rd. Flashes Red

P:\paha\96403\Draws\SHEETS\CENTRAL\Sigings 8-20-97 7:18:57 am EST

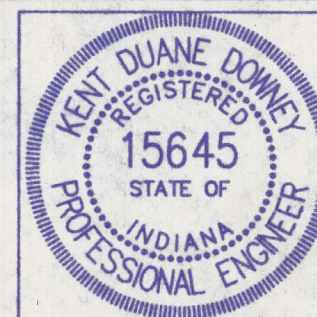

RECOMMENDED FOR APPROVAL: *Kent D. Downey* 9/19/97
DESIGN ENGINEER DATE

DESIGNED: DAV DRAWN: DAV, JRF
CHECKED: DAS CHECKED: DAS

INDIANA DEPARTMENT OF TRANSPORTATION

VOGEL RD. & BURKHARDT RD. SIGNAL DETAILS

HORIZONTAL SCALE 1:250	BRIDGE FILE
VERTICAL SCALE	DESIGNATION
SURVEY BOOK	SHEETS
CONTRACT	34 of 90
	PROJECT
	VC97-09-01